

SURVEY & REMONUMENTATION

JAN 22 1998

Re-Mon Liber 1 Page 143

1997 REMONUMENTATION

SECTION

LAND CORNER RECORDATION CERTIFICATE
Filing Requirement of Act 74, Mich. P.A. 1970

STATE OF MICHIGAN
HURON COUNTY
RECORDED

For corners in COLFAX TOWNSHIP

12 DEC 97 12:41 P.M.

FRANCES L. HOLDWICK
REGISTER OF DEEDS

HURON (County)	Located In:	Corner Code #
1. Public Land Survey	T <u>16</u> N R <u>12</u> E	<u>C-13</u>
	T ___ R ___	_____
	T ___ R ___	_____
	T ___ R ___	_____
2. Property Controlling in Section	S ___ T ___ R ___	_____
	S ___ T ___ R ___	_____
3. Miscellaneous Property in Sec.	S ___ T ___ R ___	_____
	S ___ T ___ R ___	_____

Register of Deeds Stamp & File Number

4. Lot No. _____, Recorded Plat _____
5. Private Claims _____

I, Russell L. Brown, in a field survey on Nov. 24, 19 97 do hereby state that under requirements of P.A. 74, Michigan P.A. of 1970, the corner points mentioned in lines 1 and 2 above were in conformance with regulations and rules therefore as required in the current manual of survey instructions of the United States Department of the Interior, Bureau of Land Management or by a decree of a Court of Law and /or that the corner points mentioned in lines 3, 4 and 5 above were in conformance with the rules of the Michigan Board of Land Surveyors or by a Decree of a Court of Law; established, re-established, monumented, recovered, found as expressed below:

NOTE: Not more than 2 corners, all in the same town and range, may be recorded on this certificate.

	A	B	C	D	E	F	G	H	I	J	K	L	M
1													
2		6		5		4		3		2		1	
3													
4		7		8		9		10		11		12	
5													
6		18		17		16		15		14		13	
7													
8		19		20		21		22		23		24	
9													
10		30		29		28		27		26		25	
11													
12		31		32		33		34		35		36	
13													

A. Description of original monument and accessories and/or subsequent restoration:

1834 G.L.O. H. Parke D.S., Set Post Corner Sections 31 and 32.
Hemlock 16 N56E 56, Hemlock 16 N19W 10
COUNTY SURVEYORS RECORDS: None
COUNTY ROAD COMMISSION RECORDS: None
ACT 74 FORM: None
RECORDED SURVEYS: Survey May 24, 1997 recorded in Liber 3 on Page 273 of Huron County Records, S.G. Case P.S. 15399, Corner 77.22' (G.L.O. Distance) East of Northwest Corner Section 5, T15N-R12E, Nothing in place. No Witnesses given.

B. Description of corner evidence found and/or method applied in restoring or reestablishing corner:

No evidence of original corner or accessories found.
Set 1/2" x 18" Steel Stake (117 links G.L.O. Distance) 77.22' East of 3/4" Re-Rod at apparent Northwest Corner Section 5 (C-1), T15N-R12E as per survey in Liber 3, Page 273 as best evidence of original Corner position.

C. Description of monument for corner and accessories established to perpetuate locating the position of the corner:

C-13 Corner Sections 31 and 32, T16N-R12E
Set 1/2" x 18" Steel Stake capped 24588
WITNESSES:
N25°W 35.98' to Spike in S.W. Side 28" Box Elder
N50°E 54.76' to Spike in S.E. Side 18" Maple
South 20.42' to 1/2" x 18" Steel Stake
S65°W 115.16' to P.K. Nail in N.W. Side Anchor Pole
S85°W 59.55' to 2" Pipe in Centerline Popple Road
East 2674.87' to South 1/4 Corner Section 32, T16N-R12E, D-13
West 2585.74' to South 1/4 Corner Section 31, T16N-R12E, B-13

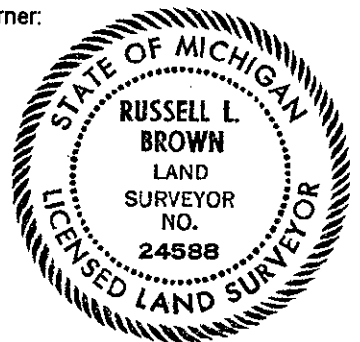

Signed by Russell L. Brown
Surveyor's Michigan License No. 24588

Date December 9, 1997

PEER GROUP APPROVED
AT MEETING HELD

DEC 11, 1997.

RLB