

\*Common to M13 - Colfax Twp. - T16N-R12E  
 \*Common to M01 - Sheridan Twp. - T15N-R12E  
 \*Common to A01 - Bingham Twp. - T15N-R13E

*Re-Mon. Liber 1, Page 86*

1997 REMONUMENTATION

LAND CORNER RECORDATION CERTIFICATE  
 Filing Requirement of Act 74, Mich. P.A. 1970

For corners in VERONA TOWNSHIP

HURON Located in: Corner Code #  
 (County)

1. Public Land Survey T 16N R 13E A-13 ✓  
 T 15N R 13E A-1  
 T 16N R 12E M-13  
 T 15N R 12E M-1

2. Property Controlling S \_\_\_ T \_\_\_ R \_\_\_  
 in Section S \_\_\_ T \_\_\_ R \_\_\_

3. Miscellaneous S \_\_\_ T \_\_\_ R \_\_\_  
 Property in Sec. S \_\_\_ T \_\_\_ R \_\_\_

SURVEY &  
 REMONUMENTATION

JAN 22 1998

STATE OF MICHIGAN  
 HURON COUNTY  
 RECORDED

1 DEC 97 1:47 P.M.

FRANCES L. HOLDWICK  
 REGISTER OF DEEDS

SECTION Register of Deeds Stamp & File Number

4. Lot No. \_\_\_\_\_, Recorded Plat \_\_\_\_\_  
 5. Private Claims \_\_\_\_\_

I, Russell L. Brown in a field survey on Oct. 15, 1997 do hereby state that under requirements of P.A. 74, Michigan P.A. of 1970, the corner points mentioned in lines 1 and 2 above were in conformance with regulations and rules therefore as required in the current manual of survey instructions of the United States Department of the Interior, Bureau of Land Management or by a decree of a Court of Law and/or that the corner points mentioned in lines 3, 4 and 5 above were in conformance with the rules of the Michigan Board of Land Surveyors or by a Decree of a Court of Law; established, re-established, monumented, recovered, found as expressed below:

NOTE: Not more than 2 corners, all in the same town and range, may be recorded on this certificate.

|    |    |   |    |   |    |   |    |   |    |   |    |   |   |
|----|----|---|----|---|----|---|----|---|----|---|----|---|---|
| 1  | A  | B | C  | D | E  | F | G  | H | I  | J | K  | L | M |
| 2  | 6  |   | 5  |   | 4  |   | 3  |   | 2  |   | 1  |   |   |
| 3  |    |   |    |   |    |   |    |   |    |   |    |   |   |
| 4  | 7  |   | 8  |   | 9  |   | 10 |   | 11 |   | 12 |   |   |
| 5  |    |   |    |   |    |   |    |   |    |   |    |   |   |
| 6  | 18 |   | 17 |   | 16 |   | 15 |   | 14 |   | 13 |   |   |
| 7  |    |   |    |   |    |   |    |   |    |   |    |   |   |
| 8  | 19 |   | 20 |   | 21 |   | 22 |   | 23 |   | 24 |   |   |
| 9  |    |   |    |   |    |   |    |   |    |   |    |   |   |
| 10 | 30 |   | 29 |   | 28 |   | 27 |   | 26 |   | 25 |   |   |
| 11 |    |   |    |   |    |   |    |   |    |   |    |   |   |
| 12 | 31 |   | 32 |   | 33 |   | 34 |   | 35 |   | 36 |   |   |
| 13 |    |   |    |   |    |   |    |   |    |   |    |   |   |

A. Description of original monument and accessories and/or subsequent restoration:  
 1834 G.L.O. H. Parke D.S. West on South side Section 31, T16N-R13E, 78.01 intersected Range Line 43 South of temporary Town Corner. Hemlock 12 N9 1/2W 8, B. Ash 16 S2W 33  
 1895 COUNTY SURVEYORS RECORDS: Duncan McFadden County Surveyor, Post from witnesses, no Witnesses given.  
 ACT 74 FORM: None  
 COUNTY ROAD COMMISSION RECORDS: Iron Pin, Spike Power Pole, S45°E 69.40'  
 RECORDED SURVEYS: (OVER)

B. Description of corner evidence found and/or method applied in restoring or reestablishing corner:  
 No evidence of original corner or accessories found.  
 Found 3/4" Re-rod in monument box  
 Accepted 3/4" Re-rod as the best evidence of original corner position.

C. Description of monument for corner and accessories established to perpetuate locating the position of the corner:  
 S.W. Corner Section 31, T16N-R13E, A-13  
 Found 3/4" Re-rod  
 WITNESSES:  
 S45°E 69.38' to Spike in East Side Power Pole  
 N45°E 53.12' to Right of Way Marker  
 S50°W 44.84' to Chiseled "+" on West End C.M.P.  
 N60°W 51.75' to 1/2" x 18" Steel Stake  
 East 2517.93' to South 1/4 Corner Section 31, T16N-R13E  
 This corner is common with M-13, T16N-R12E, M-1, T15N-R12E, and A-1, T15N-R13E

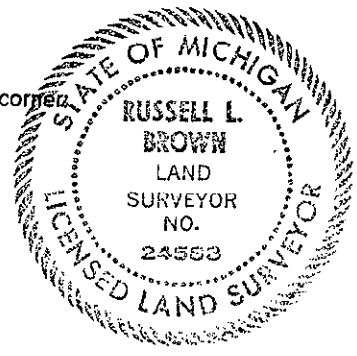

Signed by Russell L. Brown Date Nov. 3, 1997  
 Surveyor's Michigan License No. 24588

PEER GROUP APPROVED  
 AT MEETING HELD  
Nov 25, 1997. RLB

*Liber 1, Page 86A*

A. CONTINUED

Survey recorded in Liber 3 of Surveys on Page 96 of Huron County Records.  
Monument Box in place

WITNESSES:

Nail on West side of Power Pole, S40°E 69.15'  
Nail on North Side of Telephone Pole, S60°W 50.65'  
Nail on South Side of Telephone Pole, N40°W 49.30'

\$ 9.00 SURVEY  
\$ 2.00 MSSR