

SURVEY & REMONUMENTATION

JAN 22 1998

Re-Mon Liber 1, Page 82

1997 REMONUMENTATION

SECTION

LAND CORNER RECORDATION CERTIFICATE
Filing Requirement of Act 74, Mich. P.A. 1970

For corners in VERONA TOWNSHIP

HURON (County)	Located in:	Corner Code #
1. Public Land Survey	T <u>16</u> N R <u>13</u> E	<u>B-13</u>
	T <u> </u> R <u> </u>	<u> </u>
	T <u> </u> R <u> </u>	<u> </u>
	T <u> </u> R <u> </u>	<u> </u>
2. Property Controlling in Section	S <u> </u> T <u> </u> R <u> </u>	<u> </u>
	S <u> </u> T <u> </u> R <u> </u>	<u> </u>
3. Miscellaneous Property in Sec.	S <u> </u> T <u> </u> R <u> </u>	<u> </u>
	S <u> </u> T <u> </u> R <u> </u>	<u> </u>

STATE OF MICHIGAN
HURON COUNTY
RECORDED

1 DEC 97 1:38 P.M.

FRANCES L. HOLDWICK
REGISTER OF DEEDS

Register of Deeds Stamp & File Number

4. Lot No. _____, Recorded Plat _____
5. Private Claims _____

I, Russell L. Brown, in a field survey on Oct. 15, 19 97 do hereby state that under requirements of P.A. 74, Michigan P.A. of 1970, the corner points mentioned in lines 1 and 2 above were in conformance with regulations and rules therefore as required in the current manual of survey instructions of the United States Department of the Interior, Bureau of Land Management or by a decree of a Court of Law and/or that the corner points mentioned in lines 3, 4 and 5 above were in conformance with the rules of the Michigan Board of Land Surveyors or by a Decree of a Court of Law; established, re-established, monumented, recovered, found as expressed below:

NOTE: Not more than 2 corners, all in the same town and range, may be recorded on this certificate.

	A	B	C	D	E	F	G	H	I	J	K	L	M
1													
2	6		5		4		3		2		1		
3													
4	7		8		9		10		11		12		
5													
6	18		17		16		15		14		13		
7													
8	19		20		21		22		23		24		
9													
10	30		29		28		27		26		25		
11													
12	31		32		33		34		35		36		
13													

A. Description of original monument and accessories and/or subsequent restoration:
1834 G.L.O. H. Parke D.S. Set quarter Section Post Cedar 18 N21E 20, Birch 18 N11W 20
~~1895 COUNTY SURVEYOR RECORDS~~ Corner was not established. No accessories.
ACT 74 FORM: None
COUNTY ROAD COMMISSION RECORDS Iron Rod in Line with Fence South SURVEYS RECORDED: in Liber 3 of Page 96,
Set 1 1/4" Pipe in Center of 3 Stones surrounded with crockery.
North 40.0' to 1/2" Pin
S20°W 49.90' to Spike in East Side 8" Cedar Post
S10°E 47.0' to 1/2" Steel Pin.

B. Description of corner evidence found and/or method applied in restoring or reestablishing corner:
Found 1 1/4" Pipe in Center gravel Road (Popple Road) raised pipe to surface with 1/2" dia. Re-rod in center of pipe.

Accepted 1 1/4" Pipe as the best evidence of original Corner position.

C. Description of monument for corner and accessories established to perpetuate locating the position of the corner:
South 1/4 Corner Section 31, T16N-R13E, B-13
1/2" Dia. Re-rod capped 24588 over 1 1/4" Pipe
WITNESSES:
N45°E 27.88' to 1/2" x 18" Steel Stake
S45°E 28.84' to 1/2" x 18" Steel Stake
S20°W 50.26' to P.K. Nail in Corner Post
N50°W 29.23' to 1/2" Re-bar
West 13.08' to 3/4" Iron Bar apparent B-1, T15N-R13E
East 2648.89' to Southeast Corner Section 31, T16N-R13E
West 2517.93' to Southwest Corner Section 31, T16N-R13E

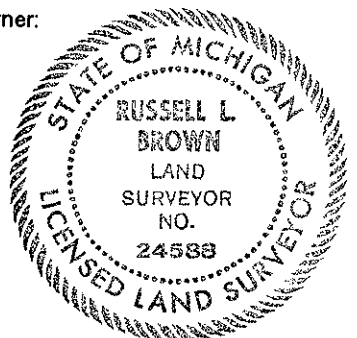

Signed by Russell L. Brown Date Nov. 3, 1997
Surveyor's Michigan License No. 24588

PEER GROUP APPROVED
AT MEETING HELD
Nov 25, 1997. RLB