

SURVEY & REMONUMENTATION

JAN 22 1998

Re-Mon. Liber 1, Page 88

SECTION

**1997 REMONUMENTATION
LAND CORNER RECORDATION CERTIFICATE
Filing Requirement of Act 74, Mich. P.A. 1970**

For corners in VERONA TOWNSHIP

<u>HURON</u> (County)	Located In:	Corner Code #
1. Public Land Survey	T <u>16</u> N R <u>13</u> E	<u>D-13</u>
	T ___ R ___	_____
	T ___ R ___	_____
	T ___ R ___	_____
2. Property Controlling in Section	S ___ T ___ R ___	_____
	S ___ T ___ R ___	_____
3. Miscellaneous Property in Sec.	S ___ T ___ R ___	_____
	S ___ T ___ R ___	_____

STATE OF MICHIGAN
HURON COUNTY
RECORDED

1 DEC 97 1:50 P.M.

FRANCES L. HOLDWICK
REGISTER OF DEEDS

Register of Deeds Stamp & File Number

4. Lot No. _____, Recorded Plat _____
5. Private Claims _____

I, Russell L. Brown, in a field survey on Oct. 15, 1997 do hereby state that under requirements of P.A. 74, Michigan P.A. of 1970, the corner points mentioned in lines 1 and 2 above were in conformance with regulations and rules therefore as required in the current manual of survey instructions of the United States Department of the Interior, Bureau of Land Management or by a decree of a Court of Law and/or that the corner points mentioned in lines 3, 4 and 5 above were in conformance with the rules of the Michigan Board of Land Surveyors or by a Decree of a Court of Law; established, re-established, monumented, recovered, found as expressed below:

NOTE: Not more than 2 corners, all in the same town and range, may be recorded on this certificate.

	A	B	C	D	E	F	G	H	I	J	K	L	M
1													
2		6		5		4		3		2		1	
3													
4		7		8		9		10		11		12	
5													
6		18		17		16		15		14		13	
7													
8		19		20		21		22		23		24	
9													
10		30		29		28		27		26		25	
11													
12		31		32		33		34		35		36	
13													

A. Description of original monument and accessories and/or subsequent restoration:

1834 G.L.O. H. Parke D.S. Set quarter Section Post
W Ash 7 N54E 31, B Ash 6 N40W 21 1/2
COUNTY SURVEYOR RECORDS: None
ACT 74 FORMS: None
COUNTY ROAD COMMISSION RECORDS: None
RECORDED SURVEYS: None

B. Description of corner evidence found and/or method applied in restoring or reestablishing corner:

No evidence of original corner or accessories found.

Re-established Corner position by proportionate measurement to G.L.O. Notes, between Corner F-13 (South 1/4 Corner Section 33) and Corner C-13 (Corner Section 31 and 32) as best evidence of original Corner position for Corner D-13.

C. Description of monument for corner and accessories established to perpetuate locating the position of the corner:

S. 1/4 Corner Section 32, T16N-R13E, D-13
Set 1/2" x 18" Steel Stake capped 24588
WITNESSES:
West 20.31' to 3/4" Steel Stake approximate North 1/4 Corner Section 5, T15N-R13E
N10°E 50.42' to Spike in East Side 12" Poplar tree
S25°W 36.31' to P.K. Nail in East Side Power Pole
S60°E 40.21' to 1/2" x 18" Steel Stake
N40°W 25.62' to Chisled "+" in North End 15" C.M.P.
East 2629.35' to Southeast Corner Section 32, T16N-R13E
West 2651.20' to Southwest Corner Section 32, T16N-R13E

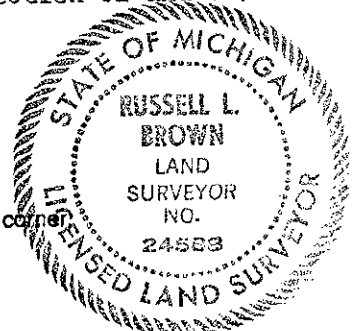

Signed by Russell L. Brown

Date Nov. 3, 1997

Surveyor's Michigan License No. 24588

PEER GROUP APPROVED
AT MEETING HELD

Nov. 25, 1997