

JAN 22 1998

SECTION

Re-Mon. Liber 1, Page 90

1997 REMONUMENTATION

LAND CORNER RECORDATION CERTIFICATE
Filing Requirement of Act 74, Mich. P.A. 1970

For corners in VERONA TOWNSHIP

Table with columns: HURON (County), Located in: (T/R), Corner Code # (F-13). Rows include Public Land Survey, Property Controlling in Section, and Miscellaneous Property in Sec.

STATE OF MICHIGAN
HURON COUNTY
RECORDED
1 DEC 97 1:51 P.M.
FRANCES L. HOLDWICK
REGISTER OF DEEDS
Register of Deeds Stamp & File Number

4. Lot No. , Recorded Plat
5. Private Claims

I, Russell L. Brown, in a field survey on Oct. 16, 19 97 do hereby state that under requirements of P.A. 74, Michigan P.A. of 1970, the corner points mentioned in lines 1 and 2 above were in conformance with regulations and rules therefore as required in the current manual of survey instructions of the United States Department of the Interior, Bureau of Land Management or by a decree of a Court of Law and /or that the corner points mentioned in lines 3, 4 and 5 above were in conformance with the rules of the Michigan Board of Land Surveyors or by a Decree of a Court of Law; established, re-established, monumented, recovered, found as expressed below:

NOTE: Not more than 2 corners, all in the same town and range, may be recorded on this certificate.

Grid table with columns A-M and rows 1-13. Contains numbers 1-36 in a grid pattern.

A. Description of original monument and accessories and/or subsequent restoration:
1834 G.L.O. H. Parke D.S. Set quarter Section Post
Hemlock 30 East 23, Beech 18 N38W 24 1/2
COUNTY SURVEYOR RECORDS: None
ACT 74 FORM: None
COUNTY ROAD COMMISSION RECORDS: None
RECORDED SURVEYS: None

B. Description of corner evidence found and/or method applied in restoring or reestablishing corner:
No evidence of original Corner or accessories found.
Found 3/4" Dia. Re-rod in centerline gravel road East and West (Popple Road) and in line with Fence North.

Accepted 3/4" Re-rod as the best evidence of original corner position.

C. Description of monument for corner and accessories established to perpetuate locating the position of the corner:
South 1/4 Corner Section 33, T16N-R13E, F-13
Found 3/4" Dia. Re-rod

WITNESSES:
North 34.36' to P.K. Nail in West Side Gate Post
N40°W 48.70' to P.K. Nail in Northeast Side Gate Post
N45°E 50.49' to P.K. Nail in Northwest Side Wood Post
S55°W 108.64' to Nail in North Side Power Pole
East 2639.54' to Southeast Corner Section 33, T16N-R13E
West 2639.54' to Southwest Corner Section 33, T16N-R13E

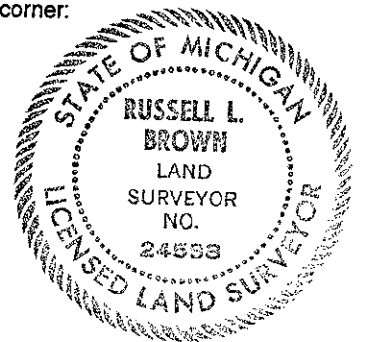

Signed by Russell L. Brown
Surveyor's Michigan License No. 24588

Date Nov. 3, 1997

PEER GROUP APPROVED
AT MEETING HELD

NOV 25, 1997. RLB