

SURVEY & REMONUMENTATION

JAN 22 1998

Re-Now Liber 1, Page 93

1997 REMONUMENTATION

SECTION

LAND CORNER RECORDATION CERTIFICATE
Filing Requirement of Act 74, Mich. P.A. 1970

For corners in VERONA TOWNSHIP

STATE OF MICHIGAN
HURON COUNTY
RECORDED

1 DEC 97 1:51 P.M.

FRANCES L. HOLDWICK
REGISTER OF DEEDS

Register of Deeds Stamp & File Number

<u>HURON</u> (County)	Located In:	Corner Code #
1. Public Land Survey	T <u>16NR 13E</u>	<u>I-13</u>
	T <u> R</u>	<u> </u>
	T <u> R</u>	<u> </u>
	T <u> R</u>	<u> </u>
2. Property Controlling in Section	S <u> </u> T <u> R</u>	<u> </u>
	S <u> </u> T <u> R</u>	<u> </u>
3. Miscellaneous Property in Sec.	S <u> </u> T <u> R</u>	<u> </u>
	S <u> </u> T <u> R</u>	<u> </u>

4. Lot No. _____, Recorded Plat _____
5. Private Claims _____

I, Russell L. Brown, in a field survey on Oct. 16, 1997 do hereby state that under requirements of P.A. 74, Michigan P.A. of 1970, the corner points mentioned in lines 1 and 2 above were in conformance with regulations and rules therefore as required in the current manual of survey instructions of the United States Department of the Interior, Bureau of Land Management or by a decree of a Court of Law and for that the corner points mentioned in lines 3, 4 and 5 above were in conformance with the rules of the Michigan Board of Land Surveyors or by a Decree of a Court of Law; established, re-established, monumented, recovered, found as expressed below:

NOTE: Not more than 2 corners, all in the same town and range, may be recorded on this certificate.

	A	B	C	D	E	F	G	H	I	J	K	L	M
1													
2	6		5		4		3		2		1		
3													
4	7		8		9		10		11		12		
5													
6	10		17		16		15		14		13		
7													
8	19		20		21		22		23		24		
9													
10	30		29		28		27		26		25		
11													
12	31		32		33		34		35		36		
13													

A. Description of original monument and accessories and/or subsequent restoration:

1834 G.L.O. H. Parke D.S. Set Post Corner Section 34 and 35
Sugar 12 N48W 22, Birch 7 N67 1/2E 43
COUNTY SURVEYOR RECORDS: None
ACT 74 FORM: None
COUNTY ROAD COMMISSION RECORDS: Pointed Stone in Centerline Road North, East and West, approximate 2 feet East of fence South. No Witnesses.

(OVER)

B. Description of corner evidence found and/or method applied in restoring or reestablishing corner:

No evidence of original Corner of accessories found.
Found 3/4" Re-rod centerline gravel roads East and West (Helena Road) and North Jurgess (Road).
Recovered 2 witnesses that indicate 3/4" Re-rod to be in same position as September 11, 1984 unrecorded survey.
Accepted 3/4" Re-rod as the best evidence of original position of Corner I-13.

C. Description of monument for corner and accessories established to perpetuate locating the position of the corner:

Corners Sections 34 and 35, T16N-R13E, I-13
Found 3/4" Re-rod
WITNESSES:
N50°W 48.78' to Spike in Power Pole
S60°W 73.52' to Spike in Power Pole
N50°E 35.48' to 1/2" x 18" Steel Stake
S55°E 35.46' to 1/2" x 18" Steel Stake
East 2634.40' to South 1/4 Corner, Section 35, T16N-R13E
West 2643.67' to South 1/4 Corner, Section 34, T16N-R13E

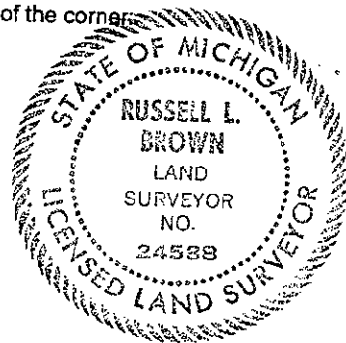

Signed by Russell L. Brown

Date Nov. 3, 1997

Surveyor's Michigan License No. 24588

PEER GROUP APPROVED
AT MEETING HELD

Nov 25, 1997 RLB

Liber 1, Page 93A

A. CONTINUED

October 4, 1987

Survey recorded in Liber 3, Page 606, Huron County Records

5/8" Steel Pin

WITNESSES:

Spike in Northwest Side of Power Pole, N50°E 47.0'

Spike in Northeast Side of Corner Fence Post, N40°W 44.70'

Spike in Southwest Side of Telephone Pole, S25°E 31.85'

September 11, 1984

unrecorded survey by Huron Surveying,

3/4" Steel Pin

WITNESSES:

N45°W 49.02' to Spike in Power Pole

S55°W 73.70' to Spike in Power Pole

South 35.53' to Center of Telephone Box

\$ 9.00 SURVEY
\$ 2.00 HSSR