

SURVEY & REMONUMENTATION

JAN 22 1998

SECTION

Re-Monumentation, Page 94

1997 REMONUMENTATION

LAND CORNER RECORDATION CERTIFICATE
Filing Requirement of Act 74, Mich. P.A. 1970

For corners in VERONA TOWNSHIP

<u>HURON</u> (County)	Located In:	Corner Code #
1. Public Land Survey	T <u>16</u> N R <u>13</u> E	<u>J-13</u>
	T <u> </u> R <u> </u>	<u> </u>
	T <u> </u> R <u> </u>	<u> </u>
	T <u> </u> R <u> </u>	<u> </u>
2. Property Controlling in Section	S <u> </u> T <u> </u> R <u> </u>	<u> </u>
	S <u> </u> T <u> </u> R <u> </u>	<u> </u>
3. Miscellaneous Property in Sec.	S <u> </u> T <u> </u> R <u> </u>	<u> </u>
	S <u> </u> T <u> </u> R <u> </u>	<u> </u>

STATE OF MICHIGAN
HURON COUNTY
RECORDED

1 DEC 97 1:51 P.M.

FRANCES L. HOLLOWICK
REGISTER OF DEEDS

Register of Deeds Stamp & File Number

4. Lot No. _____, Recorded Plat _____
5. Private Claims _____

I, Russell L. Brown, in a field survey on Oct 17, 19 97 do hereby state that under requirements of P.A. 74, Michigan P.A. of 1970, the corner points mentioned in lines 1 and 2 above were in conformance with regulations and rules therefore as required in the current manual of survey instructions of the United States Department of the Interior, Bureau of Land Management or by a decree of a Court of Law and/or that the corner points mentioned in lines 3, 4 and 5 above were in conformance with the rules of the Michigan Board of Land Surveyors or by a Decree of a Court of Law; established, re-established, monumented, recovered, found as expressed below:

NOTE: Not more than 2 corners, all in the same town and range, may be recorded on this certificate.

1	A	B	C	D	E	F	G	H	I	J	K	L	M
2		6		5		4		3		2		1	
3													
4		7		8		9		10		11		12	
5													
6		18		17		16		15		14		13	
7													
8		19		20		21		22		23		24	
9													
10		30		29		28		27		26		25	
11													
12		31		32		33		34		35		36	
13													

A. Description of original monument and accessories and/or subsequent restoration:

1834 G.L.O. H. Parke D.S. Set quarter Section Post Sugar 18 N42E 38, Beech 7 N59W 15
COUNTY SURVEYORS RECORDS: None
ACT 74 FORM: None
COUNTY ROAD COMMISSION RECORDS: Pin in Post outline-in line Fence South
RECORDED SURVEYS: None

B. Description of corner evidence found and/or method applied in restoring or reestablishing corner:

No evidence of original corner or accessories found
COUNTY ROAD COMMISSION RECORDS: Pin in post outline-in line with fence South was not excepted as original position of Corner J-13.
Established Corner position for Corner J-13, by single proportionate measurement between Corners I-13 and K-13 as best evidence of original corner position.

C. Description of monument for corner and accessories established to perpetuate locating the position of the corner:

S. 1/4 Corner Section 35, T16N-R13E, J-13
Set 1/2" Dia. Re-rod and capped 24588
WITNESSES:
West 43.56' to 3/4" Steel Stake apparent J-1, T15N-R13E
N45°E 80.58' to P.K. Nail in Northwest Side of Power Pole
S45°W 55.40' to Spike in Northwest Side 10" Locust Tree
S50°E 30.74' to 1/2" Steel Stake
East 2634.40' to Corner of Section 35 and 36, T16N-R13E
West 2634.40' to Corner of Section 34 and 35, T16N-R13E

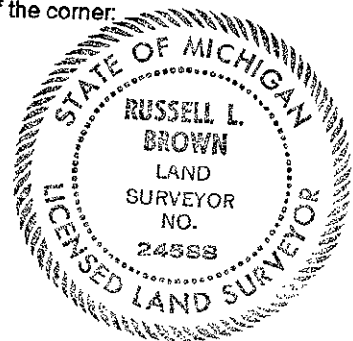

Signed by Russell L. Brown
Surveyor's Michigan License No. 24588

Date Nov. 3, 1997

PEER GROUP APPROVED
AT MEETING HELD

NOV 25, 1997. RLB