

**SURVEY & REMONUMENTATION**

JAN 22 1998

*Re-Mon. Liber 1, Page 95*  
1997 REMONUMENTATION

**SECTION**

**LAND CORNER RECORDATION CERTIFICATE**  
Filing Requirement of Act 74, Mich. P.A. 1970

For corners in VERONA TOWNSHIP

HURON (County)	Located In:	Corner Code #
1. Public Land Survey	T <u>16</u> N R <u>13</u> E	<u>K-13</u>
	T ___ R ___	___
	T ___ R ___	___
	T ___ R ___	___
2. Property Controlling in Section	S ___ T ___ R ___	___
	S ___ T ___ R ___	___
3. Miscellaneous Property in Sec.	S ___ T ___ R ___	___
	S ___ T ___ R ___	___

STATE OF MICHIGAN  
HURON COUNTY  
RECORDED  
1 DEC 97 1:52 P.M.  
FRANCES L. HOLDWICK  
REGISTER OF DEEDS  
Register of Deeds Stamp & File Number

4. Lot No. \_\_\_\_\_, Recorded Plat \_\_\_\_\_  
5. Private Claims \_\_\_\_\_

I, Russell L. Brown, in a field survey on Oct. 17, 1997 do hereby state that under requirements of P.A. 74, Michigan P.A. of 1970, the corner points mentioned in lines 1 and 2 above were in conformance with regulations and rules therefore as required in the current manual of survey instructions of the United States Department of the Interior, Bureau of Land Management or by a decree of a Court of Law and /or that the corner points mentioned in lines 3, 4 and 5 above were in conformance with the rules of the Michigan Board of Land Surveyors or by a Decree of a Court of Law; established, re-established, monumented, recovered, found as expressed below:

	A	B	C	D	E	F	G	H	I	J	K	L	M
1													
2		6		5		4		3		2		1	
3													
4		7		8		9		10		11		12	
5													
6		18		17		16		15		14		13	
7													
8		19		20		21		22		23		24	
9													
10		30		29		28		27		26		25	
11													
12		31		32		33		34		35		36	
13													

NOTE: Not more than 2 corners, all in the same town and range, may be recorded on this certificate.

A. Description of original monument and accessories and/or subsequent restoration:  
1834 G.L.O. H. Parke D.S. Set Post Corner Section 35 and 36  
Hemlock 12 N54 1/2W 18, Do 17 N59E 51 1/2  
COUNTY SURVEYOR RECORD: None  
ACT 74 FORM: None  
COUNTY ROAD COMMISSION RECORDS: Iron Pin Centerline Grade N-E-W  
Spike in Power Pole, N55°E 45.55', Spike in Corner Post N45°W 44.30'  
RECORDED SURVEYS: None

B. Description of corner evidence found and/or method applied in restoring or reestablishing corner:  
No evidence of original Corner of Accessories Found.  
Found 3/4" Re-rod Centerline Gravel Road North (McAllister Road) and Centerline Gravel Road East and West (Helena Road)  
Accepted 3/4" Re-rod as the best evidence of original Corner position.

C. Description of monument for corner and accessories established to perpetuate locating the position of the corner:  
Corners: Sections 35 and 36, T16N-R13E, K-13  
Found 3/4" Re-rod  
WITNESSES:  
N45°E 54.85' to P.K. Nail in Power Pole  
N45°W 35.06' to V Notch in West End C.M.P.  
S60°W 92.47' to P.K. Nail in Power Pole  
S60°E 32.56' to 1/2" x 18" Steel Stake  
West 2634.40' to South 1/4 Corner Section 35, T16N-R13E  
East 2645.65' to South 1/4 Corner Section 36, T16N-R13E

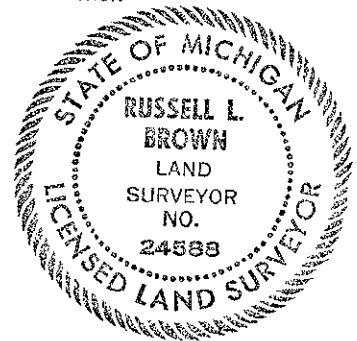

Surveyed by Russell L. Brown  
Surveyor's Michigan License No. 24588

Date Nov. 3, 1997

PEER GROUP APPROVED  
AT MEETING HELD  
NOV 25, 1997. RLB