

SURVEY & REMONUMENTATION

JAN 22 1998

Re-monumentation, Page 106

SECTION

1997 REMONUMENTATION LAND CORNER RECORDATION CERTIFICATE Filing Requirement of Act 74, Mich. P.A. 1970

For corners in SIGEL TOWNSHIP

HURON (County)	Located in:	Corner Code #
1. Public Land Survey	T <u>16N</u> R <u>14E</u>	<u>G-13</u>
	T <u> </u> R <u> </u>	<u> </u>
	T <u> </u> R <u> </u>	<u> </u>
	T <u> </u> R <u> </u>	<u> </u>
2. Property Controlling in Section	S <u> </u> T <u> </u> R <u> </u>	<u> </u>
	S <u> </u> T <u> </u> R <u> </u>	<u> </u>
3. Miscellaneous Property in Sec.	S <u> </u> T <u> </u> R <u> </u>	<u> </u>
	S <u> </u> T <u> </u> R <u> </u>	<u> </u>

STATE OF MICHIGAN
HURON COUNTY
RECORDED

1 DEC 97 1:59 P.M.

FRANCES L. HOLDWICK
REGISTER OF DEEDS

Register of Deeds Stamp & File Number

4. Lot No. _____, Recorded Plat _____
5. Private Claims _____

	A	B	C	D	E	F	G	H	I	J	K	L	M	
1														
2	6			5			4			3			2	1
3														
4	7			8			9			10			11	12
5														
6	18			17			16			15			14	13
7														
8	19			20			21			22			23	24
9														
10	30			29			28			27			26	25
11														
12	31			32			33			34			35	36
13														

I, Russell L. Brown, in a field survey on Oct. 21, 1997 do hereby state that under requirements of P.A. 74, Michigan P.A. of 1970, the corner points mentioned in lines 1 and 2 above were in conformance with regulations and rules therefore as required in the current manual of survey instructions of the United States Department of the Interior, Bureau of Land Management or by a decree of a Court of Law and/or that the corner points mentioned in lines 3, 4 and 5 above were in conformance with the rules of the Michigan Board of Land Surveyors or by a Decree of a Court of Law; established, re-established, monumented, recovered, found as expressed below:

NOTE: Not more than 2 corners, all in the same town and range, may be recorded on this certificate.

A. Description of original monument and accessories and/or subsequent restoration:

1834 G.L.O. H. Parke D.S. Set Post Corner Section 33 and 34
Pine 26 N83E 33, B. Ash 7 N79W 8 1/2
COUNTY SURVEYOR RECORDS: None
ACT 74 FORM: None
COUNTY ROAD COMMISSION RECORDS: None
RECORDED SURVEYS: (OVER)

B. Description of corner evidence found and/or method applied in restoring or reestablishing corner:

No evidence of original corner or accessories found.
Found 1/2" Dia. Steel Stake
Accepted 1/2", Dia. Steel Stake as the best evidence of original corner position.

C. Description of monument for corner and accessories established to perpetuate locating the position of the corner:

Corner Sections 33 and 34, T16N-R14E, G-13
Found 1/2" Dia. Steel Stake
WITNESSES:
N35°E 79.16' to Spike in Power Pole
S35°W 100.27' to Spike in Power Pole
N70°E 67.34' to Spike in Southeast Side Power Pole
N45°W 97.49' to Centerline of Flag Pole
West 25.69' to 1/2" Re-bar, apparent corner G-1, T15N-R14E
East 2627.65' to South 1/4 Corner Section 34, T16N-R14E
West 2627.04' to South 1/4 Corner Section 33, T16N-R14E

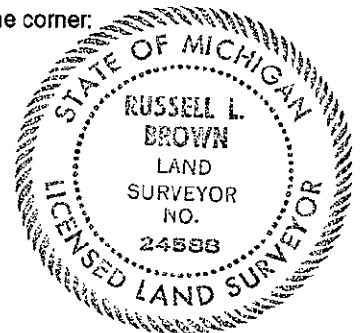

Signed by Russell L. Brown
Surveyor's Michigan License No. 24588

Date Nov. 3, 1997

PEER GROUP APPROVED
AT MEETING HELD
Nov 25, 1997. RLB

Liber 1, Page 106 A

A. CONTINUED

3-19-81, Survey recorded in Liber 4, of surveys on Page 586 of Huron County Records.
By: Huron Surveying, Inc., Brown L.S. 24588

Found 5/8" Steel Pin, raised to surface with 1/2" Re-rod

WITNESSES:

N35°E 79.21' to Spike in Power Pole

N35°W 57.04' to Spike in 24" Willow Tree

S35°W 100.27' to Spike in Power Pole

\$ 9.00 SURVEY

\$ 2.00 MSSR