

SURVEY & REMONUMENTATION

JAN 22 1998

Re Man Leber 1, Page 107

1997 REMONUMENTATION

LAND CORNER RECORDATION CERTIFICATE
Filing Requirement of Act 74, Mich. P.A. 1970

SECTION

For corners in SIGEL TOWNSHIP

<u>HURON</u> (County)	Located In:	Corner Code #
1. Public Land Survey	T <u>16NR</u> <u>14E</u>	<u>H-13</u>
	T ___ R ___	_____
	T ___ R ___	_____
	T ___ R ___	_____
2. Property Controlling in Section	S ___ T ___ R ___	_____
	S ___ T ___ R ___	_____
3. Miscellaneous Property in Sec.	S ___ T ___ R ___	_____
	S ___ T ___ R ___	_____

STATE OF MICHIGAN
HURON COUNTY
RECORDED

1 DEC 97 1:00 P.M.

FRANCES L. HOLDWICK
REGISTER OF DEEDS
Register of Deeds Stamp & File Number

4. Lot No. _____, Recorded Plat _____
5. Private Claims _____

1	A	B	C	D	E	F	G	H	I	J	K	L	M
2		6		5		4		3		2		1	
3													
4		7		8		9		10		11		12	
5													
6		18		17		16		15		14		13	
7													
8		19		20		21		22		23		24	
9													
10		30		29		28		27		26		25	
11													
12		31		32		33		34		35		36	
13													

I, Russell L. Brown, in a field survey on Oct. 20, 1997 do hereby state that under requirements of P.A. 74, Michigan P.A. of 1970, the corner points mentioned in lines 1 and 2 above were in conformance with regulations and rules therefore as required in the current manual of survey instructions of the United States Department of the Interior, Bureau of Land Management or by a decree of a Court of Law and /or that the corner points mentioned in lines 3, 4 and 5 above were in conformance with the rules of the Michigan Board of Land Surveyors or by a Decree of a Court of Law; established, re-established, monumented, recovered, found as expressed below:

NOTE: Not more than 2 corners, all in the same town and range, may be recorded on this certificate.

A. Description of original monument and accessories and/or subsequent restoration:

1834 G.L.O. H. Parke D.S. Set quarter Section Post
Cedar 14 N85W 35, Cedar 7 N65E 20 1/2
COUNTY SURVEYOR RECORDS: None
Act 74 FORM: None
COUNTY ROAD COMMISSION RECORDS: Iron Pin App. In line with Fence North and South
RECORDED SURVEYS: None

B. Description of corner evidence found and/or method applied in restoring or reestablishing corner:

No evidence of original corner or accessories found.
Set 1/2" x 18" Steel Stake, by single proportionate measure, on line between G-13 (S.W. Corner Section 34, T16N-R14E) and I-13 (S.E. Corner Section 34, T16N-R14E), as best evidence of original corner position for H-13.

C. Description of monument for corner and accessories established to perpetuate locating the position of the corner:

South 1/4 Corner Section 34, T16N-R14E, H-13
Set 1/2" x 18" Steel Stake Capped 24588
WITNESSES:
N45°E 35.13' to 1/2" x 18" Steel Stake
S70°E 38.74' to 1/2" x 18" Steel Stake
S70°W 36.73' to 1/2" x 18" Steel Stake
N70°W 62.56' to 1/2" x 18" Steel Stake

East 2627.65' to Southeast Corner Section 34, T16N-R14E
West 2627.65' to Southwest Corner Section 34, T16N-R14E

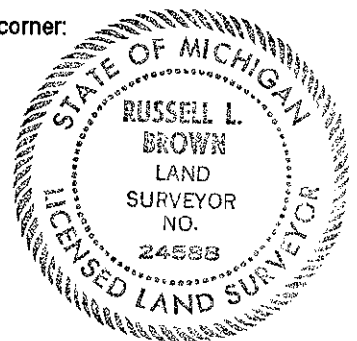

Signed by Russell L. Brown Date Nov. 3, 1997
Surveyor's Michigan License No. 24588

PEER GROUP APPROVED
AT MEETING HELD
NOV 25, 1997. RLB