

Re-Mon., Liber 1, Page 176

REMONUMENTATION

LAND CORNER RECORDATION CERTIFICATE
 Filing Requirement of Act 74, Mich. P.A. 1970

For corners in

<u>Huron</u> (County)	Located In:	Corner Code #
1. Public Land Survey	Sigel T16N R14E	M-1
	T R	
	T R	
	T R	
2. Property Controlling in Section	S T R	
	S T R	
3. Miscellaneous Property in Sec.	S T R	
	S T R	

STATE OF MICHIGAN
 HURON COUNTY
 RECORDED

25 NOV 98 10:08 A.M.

FRANCES L. HOLDWICK
 REGISTER OF DEEDS

Register of Deeds Stamp & File Number

4. Lot No. _____, Recorded Plat _____
 5. Private Claims _____

I, Charles S. Getz, in a field survey on Nov. 04, 1998 do hereby state that under requirements of P.A. 74, Michigan P.A. of 1970, the corner points mentioned in lines 1 and 2 above were in conformance with regulations and rules therefore as required in the current manual of survey instructions of the United States Department of the Interior, Bureau of Land Management or by a decree of a Court of Law and/or that the corner points mentioned in lines 3, 4 and 5 above were in conformance with the rules of the Michigan Board of Land Surveyors or by a Decree of a Court of Law; established, re-established, monumented, recovered, found as expressed below:

NOTE: Not more than 2 corners, all in the same town and range, may be recorded on this certificate.

	A	B	C	D	E	F	G	H	I	J	K	L	M
1													
2	6		5		4		3		2		1		
3													
4	7		8		9		10		11		12		
5													
6	16		17		16		15		14		13		
7													
8	19		20		21		22		23		24		
9													
10	30		29		28		27		26		25		
11													
12	31		32		33		34		35		36		
13													

A. Description of original monument and accessories and/or subsequent restoration:

M-1
 1834 G.L.O., H. Parke D.S.
 Post
 Maple 11", S12°E, 11 Links
 Hemlock 9", N28°W, 16½ Links

County Surveyor Records - NONE
 County Road Commission Records - Iron Pin in Cedar Post
 Recorded Surveys - Survey Liber 3, Page 597, 3/4" steel pin in mon. box in place.

Unrecorded Surveys - NONE

L.C.R.C. - NONE

B. Description of corner evidence found and/or method applied in restoring or reestablishing corner:

M-1
 NE Cor, Section 1, T16N-R14E
 Found 3/4" Iron Bar in Monument Box
 Accepted as the best available evidence
 of original corner position
 (Intersection of Rapson & Finkel Roads)

SURVEY &
 REMONUMENTATION

JAN 28 1999

SECTION

C. Description of monument for corner and accessories established to perpetuate locating the position of the corner:

M-1
 NE Cor, Section 1, T16N-R14E
 Found 3/4" Iron Bar in Monument Box
 N50°W 69.0' to Nail in Power Pole
 N45°E 58.70' to Buried Cable Sign
 S45°E 51.55' to Road Sign
 S60°W 43.40' to Stop Sign
 West 2630.00' to S 1/4 Cor, Sec 36, T17N-R14E
 East 2631.89' to S 1/4 Cor, Sec 31, T17N-R15E

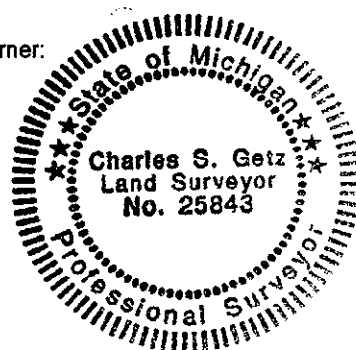

Signed by Charles S. Getz
 Surveyor's Michigan License No. 25843

Date November 8, 1998

PEER GROUP APPROVED AT
 MEETING 11-24-98 RRB