

Re-Mon Leber 1, Page 220

1998 REMONUMENTATION
LAND CORNER RECORDATION CERTIFICATE
Filing Requirement of Act 74, Mich. P.A. 1970

For Corners in MEADE Township

Huron
(County)

Located in:

Corner Code #

SURVEY &
REMONUMENTATION

STATE OF MICHIGAN
HURON COUNTY
RECORDED

15 DEC 98 3:32 P.M.

FRANCES L. HOLDWICK
REGISTER OF DEEDS

Register of Deeds Stamp & File Number

1. Public Land Survey T 17N R 12E B-13
 T ----- R -----
 T ----- R -----
 T ----- R -----
2. Property Controlling S ----- T ----- R -----
 in Section S ----- T ----- R -----
3. Miscellaneous S ----- T ----- R -----
 Property in Sec. S ----- T ----- R -----

JAN 28 1999

SECTION

4. Lot No. _____, Recorded Plat _____
 5. Private Claims _____

A	B	C	D	E	F	G	H	I	J	K	L	M
2	6	5	4	3	2	1						
3												
4	7	8	9	10	11	12						
5												
6	18	17	16	15	14	13						
7												
8	19	20	21	22	23	24						
9												
10	30	29	28	27	26	25						
11												
12	31	32	33	34	35	36						
13												

I, Russell L. Brown, in a field survey on July 24, 1998 do hereby state that under requirements of P.A. 74, Michigan P.A. of 1970, the corner points mentioned in lines 1 and 2 above were in conformance with regulations and rules therefore as required in the current manual of survey instructions of the United States Department of the Interior, Bureau of Land Management or by a decree of a Court of Law and/or that the corner points mentioned in lines 3, 4, and 5 above were in conformance with the rules of the Michigan Board of Land Surveyors or by a Decree of a Court of Law; established, re-established, monumented, recovered, found as expressed below:

NOTE: Not more than 2 corners, all in the same town and range, may be recorded on this certificate.

A. Description of original monument and accessories and/or subsequent restoration:

1834 G.L.O. H. Parke D.S. Set quarter Section Post; B. Ash 12 N60E 25; Hemlock 10 N30W 14 1/2
 County Surveyors Records: NONE
 County Road Commission Records: Iron Pin in centerline grade and in line fence North
 Recorded Surveys: NONE
 Unrecorded Surveys: NONE

B. Description of corner evidence found and/or method applied in restoring or reestablishing corner:
 No evidence of original corner or accessories found.

Set 1/2" x 18" Re-Rod capped 24588 by single proportionate measurement between corners A-13 and C-13.

Accepted single proportionate measurement as best evidence of original corner position.

C. Description of monument for corner and accessories established to perpetuate locating the position of the corner:

B-13, South 1/4 Corner Section 31, T17N-R12E
 Set 1/2" x 18" Re-Rod capped 24588

WITNESSES:

S45°E 23.78' Set 1/2" x 18" Steel Stake
 N55°E 26.06' Set 1/2" x 18" Steel Stake
 N45°W 23.10' Set 1/2" x 18" Steel Stake
 S25°W 28.05' Set P.K. Nail in West Side Corner Post

East 2617.59' to C-13, Corner Sections 31 and 32, T17N-R12E
 West 2620.20' to A-13, Township Corner, T17N-R12E, T17N-R11E, T16N-R11E, and T16N-R12E

Signed by Russell L. Brown
 Surveyor's Michigan License No. 24588

Date DEC 7, 1998

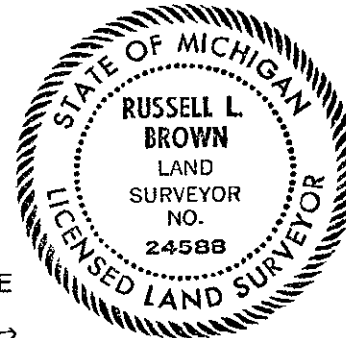

Peer group approved at meeting held December 8, 1998, R.L.B.