

Re-Monumentation 1, Page 217

1998 REMONUMENTATION  
LAND CORNER RECORDATION CERTIFICATE  
Filing Requirement of Act 74, Mich. P.A. 1970

STATE OF MICHIGAN  
HURON COUNTY  
RECORDED

For Corners in LINCOLN Township

Huron  
(County)

Located in: Corner Code #

- 1. Public Land Survey T 17N R 13E H-13
- T \_\_\_\_\_ R \_\_\_\_\_
- T \_\_\_\_\_ R \_\_\_\_\_
- T \_\_\_\_\_ R \_\_\_\_\_
- 2. Property Controlling S \_\_\_\_\_ T \_\_\_\_\_ R \_\_\_\_\_
- in Section S \_\_\_\_\_ T \_\_\_\_\_ R \_\_\_\_\_
- 3. Miscellaneous S \_\_\_\_\_ T \_\_\_\_\_ R \_\_\_\_\_
- Property in Sec. S \_\_\_\_\_ T \_\_\_\_\_ R \_\_\_\_\_

SURVEY &  
REMONUMENTATION

JAN 28 1999

SECTION

15 DEC 98 3:32 P.M.

FRANCES L. HOLWICK  
REGISTER OF DEEDS

Register of Deeds Stamp & File Number

- 4. Lot No. \_\_\_\_\_, Recorded Plat \_\_\_\_\_
- 5. Private Claims \_\_\_\_\_

A	B	C	D	E	F	G	H	I	J	K	L	M
2	6	5	4	3	2	1						
3												
4	7	6	9	10	11	12						
5												
6	18	17	16	15	14	13						
7												
8	19	20	21	22	23	24						
9												
10	30	29	28	27	26	25						
11												
12	31	32	33	34	35	36						
13												

I, Russell L. Brown, in a field survey on July 17, 1998 do hereby state that under requirements of P.A. 74, Michigan P.A. of 1970, the corner points mentioned in lines 1 and 2 above were in conformance with regulations and rules therefore as required in the current manual of survey instructions of the United States Department of the Interior, Bureau of Land Management or by a decree of a Court of Law and/or that the corner points mentioned in lines 3, 4, and 5 above were in conformance with the rules of the Michigan Board of Land Surveyors or by a Decree of a Court of Law; established, re-established, monumented, recovered, found as expressed below:

NOTE: Not more than 2 corners, all in the same town and range, may be recorded on this certificate.

A. Description of original monument and accessories and/or subsequent restoration:

G.L.O. H. Parke D.S. Set quarter Section post; Cedar 8 N45E 15; Pine 16 N87 1/2W 18 1/2;  
County Surveyors Records: NONE  
County Road Commission Records: Iron Rod in centerline grade and in line fence North.  
Recorded Surveys: NONE  
Unrecorded Surveys: November 7, 1983, by Stewart G. Case P.S. 15399; 1/2" Dia. Steel Rod; N50°W 65.0' to East end 12" C.M.P.; North 39.90' to 1/2" Steel Rod; South 38.80' to 1/2" Steel Rod

B. Description of corner evidence found and/or method applied in restoring or reestablishing corner:

No evidence or original corner or accessories found.

Found 1/2" Dia. Re-Rod

Accepted found 1/2" Dia. Re-Rod as best evidence of original corner position.

C. Description of monument for corner and accessories established to perpetuate locating the position of the corner:

H-13, South 1/4 Corner Section 34, T17N-R13E  
Found 1/2" Dia. Re-Rod  
WITNESSES:  
S50°W 65.10' found "V" Notch in East End 12" C.M.P.  
North 39.77' found 1/2" Carriage Bolt  
S65°W 139.15' Set P.K. Nail in Southeast Side Power Pole  
S20°W 100.34' Set Spike in West Face 8" Cottonwood Tree

East 2637.98' to I-13, Southeast Corner of Section 34, T17N-R13E  
West 2642.32' to G-13, Southwest Corner of Section 34, T17N-R13E

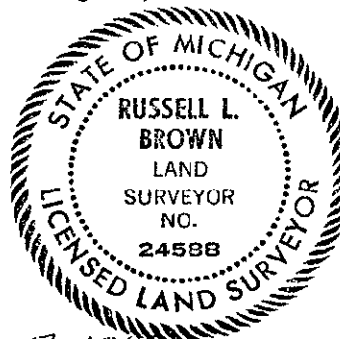

Signed by Russell L. Brown  
Surveyor's Michigan License No. 24588

Date DEC. 7 1998

Peer group approved at meeting held December 8, 1998. RRB