

REMONUMENTATION

Re - Mon Liber 1, Page 14

LAND CORNER RECORDATION CERTIFICATE
Filing Requirement of Act 74, Mich. P.A. 1970

For corners in

Huron (County)	Located in:	Corner Code #
1. Public Land Survey	Lincoln	T17N R13E J-13
		T R
		T R
		T R
2. Property Controlling in Section	S	T R
	S	T R
3. Miscellaneous Property in Sec.	S	T R
	S	T R

STATE OF MICHIGAN
HURON COUNTY
RECORDED

25 NOV 98 10:01 A.M.

FRANCES L. HOLDWICK
REGISTER OF DEEDS

Register of Deeds Stamp & File Number

4. Lot No. _____, Recorded Plat _____
5. Private Claims _____

I, Charles S. Getz, in a field survey on Oct. 30, 1998 do hereby state that under requirements of P.A. 74, Michigan P.A. of 1970, the corner points mentioned in lines 1 and 2 above were in conformance with regulations and rules therefore as required in the current manual of survey instructions of the United States Department of the Interior, Bureau of Land Management or by a decree of a Court of Law and /or that the corner points mentioned in lines 3, 4 and 5 above were in conformance with the rules of the Michigan Board of Land Surveyors or by a Decree of a Court of Law; established, re-established, monumented, recovered, found as expressed below:

NOTE: Not more than 2 corners, all in the same town and range, may be recorded on this certificate.

	A	B	C	D	E	F	G	H	I	J	K	L	M
1													
2	6	5	4	3	2	1							
3													
4	7	8	9	10	11	12							
5													
6	16	17	16	15	14	13							
7													
8	19	20	21	22	23	24							
9													
10	30	29	28	27	26	25							
11													
12	31	32	33	34	35	36							
13													

A. Description of original monument and accessories and/or subsequent restoration:

J-13	County Surveyor Records - NONE
1834 G.L.O., H. Parke D.S.	County Road Commission Records - 3/4" Iron Pin in large Wooden Post
Set quarter section post	
Hemlock 9", N84°E, 12 Links	Recorded Surveys - Survey Liber 3, Page 515, Certificate shows Corner
Sugar 9", N56°W, 20 Links	Unrecorded Surveys - Case Surveying - 3/4" steel pin
L.C.R.C. - NONE	

B. Description of corner evidence found and/or method applied in restoring or reestablishing corner:

J-13
S 1/4 Cor, Section 35, T17N-R13E
Found 3/4" Iron Bar
Accepted as the best available evidence of original corner position
(On Rapson Road)

SURVEY & REMONUMENTATION

JAN 28 1999

SECTION

C. Description of monument for corner and accessories established to perpetuate locating the position of the corner:

J-13
S 1/4 Cor, Section 35, T17N-R13E
Found 3/4" Iron Bar
N30°W 38.40' to Nail in Fence Post
S05°E 27.60' to Nail in 3" Maple Tree
West 31.0' to 5/8" Iron Bar
East 2644.60' to SE Cor, Sec 35, T17N-R13E

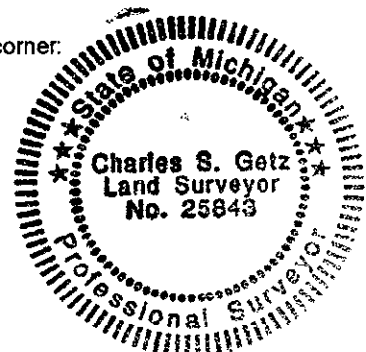

Signed by Charles S. Getz
Surveyor's Michigan License No. 25843

Date October 31, 1998

PEER GROUP APPROVED AT MEETING 11-24-98
RLB