

REMONUMENTATION

LAND CORNER RECORDATION CERTIFICATE
Filing Requirement of Act 74, Mich. P.A. 1970

Be - Mon. Liber 1, Page 150

For corners in

Huron (County)	Located In:	Corner Code #
1. Public Land Survey	Bloomfield	T17N R14E B-13
2. Property Controlling in Section	S	T R
3. Miscellaneous Property in Sec.	S	T R

STATE OF MICHIGAN
HURON COUNTY
RECORDED

25 NOV 98 10:03 A.M.

FRANCES L. HOLDWICK
REGISTER OF DEEDS

Register of Deeds Stamp & File Number

4. Lot No. _____, Recorded Plat _____
5. Private Claims _____

I, Charles S. Getz, in a field survey on Oct. 30, 1998 do hereby state that under requirements of P.A. 74, Michigan P.A. of 1970, the corner points mentioned in lines 1 and 2 above were in conformance with regulations and rules therefore as required in the current manual of survey instructions of the United States Department of the Interior, Bureau of Land Management or by a decree of a Court of Law and /or that the corner points mentioned in lines 3, 4 and 5 above were in conformance with the rules of the Michigan Board of Land Surveyors or by a Decree of a Court of Law; established, re-established, monumented, recovered, found as expressed below.

NOTE: Not more than 2 corners, all in the same town and range, may be recorded on this certificate.

	A	B	C	D	E	F	G	H	I	J	K	L	M
1													
2		6		5		4		3		2		1	
3													
4		7		8		9		10		11		12	
5													
6		18		17		16		15		14		13	
7													
8		19		20		21		22		23		24	
9													
10		30		29		28		27		26		25	
11													
12		31		32		33		34		35		36	
13													

A. Description of original monument and accessories and/or subsequent restoration:

B-13
1834 G.L.O., H. Parke D.S.
Set quarter section post
Sugar 10", N58 1/2°W, 24 1/2 Links
Hemlock 9", N36°E, 14 Links

County Surveyor Records - NONE
County Road Commission Records - NONE
Recorded Surveys - NONE
Unrecorded Surveys - Huron Surveying, 6-29-93, Found 3/4" Pipe
Case Surveying, 4-2-97, Certificate shows
Corner and Witnesses

L.C.R.C. - NONE

B. Description of corner evidence found and/or method applied in restoring or reestablishing corner:

B-13
S 1/4 Cor, Section 31, T17N-R14E
Found 1" Iron Pipe
Accepted as the best available evidence
of original corner position
(On Rapson Road)

SURVEY &
REMONUMENTATION

JAN 28 1999

SECTION

C. Description of monument for corner and accessories established to perpetuate locating the position of the corner:

B-13
S 1/4 Cor, Section 31, T17N-R14E
Found 1" Iron Pipe
East 76.80' to 1" Iron Pipe
N05°W 33.55' to Nail in Power Pole
S70°E 82.15' to Concrete Fence Post
North 33.00' to 1/2" Iron Bar
West 2713.68' to SW Cor, Sec 31, T17N-R14E
East 2643.42' to SE Cor, Sec 31, T17N-R14E

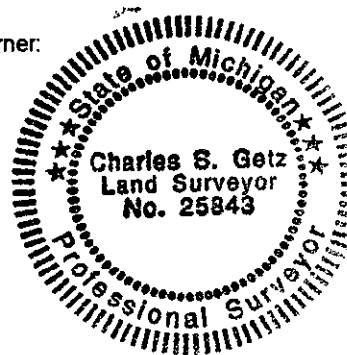

Signed by Charles S. Getz
Surveyor's Michigan License No. 25843

Date October 31, 1998

PEER GROUP APPROVED AT
MEETING 11-24-98 RLB