

**LAND CORNER RECORDATION CERTIFICATE**  
 Filing Requirement of Act 74, Mich. P.A. 1970

For corners in

<u>Huron</u> (County)	Located In:	Corner Code #
1. Public Land Survey	Bloomfield	T <u>17</u> N <u>14</u> E <u>H-13</u>
		T    R                    _____
		T    R                    _____
		T    R                    _____
2. Property Controlling in Section	S    _____	T    R                    _____
	S    _____	T    R                    _____
3. Miscellaneous Property in Sec.	S    _____	T    R                    _____
	S    _____	T    R                    _____

STATE OF MICHIGAN  
 HURON COUNTY  
 RECORDED

25 NOV 98 10:04 A.M.

FRANCES L. HOLDWICK  
 REGISTER OF DEEDS

Register of Deeds Stamp & File Number

4. Lot No. \_\_\_\_\_, Recorded Plat \_\_\_\_\_  
 5. Private Claims \_\_\_\_\_

I, Charles S. Getz, in a field survey on Nov. 04, 1998 do hereby state that under requirements of P.A. 74, Michigan P.A. of 1970, the corner points mentioned in lines 1 and 2 above were in conformance with regulations and rules therefore as required in the current manual of survey instructions of the United States Department of the Interior, Bureau of Land Management or by a decree of a Court of Law and /or that the corner points mentioned in lines 3, 4 and 5 above were in conformance with the rules of the Michigan Board of Land Surveyors or by a Decree of a Court of Law; established, re-established, monumented, recovered, found as expressed below:

NOTE: Not more than 2 corners, all in the same town and range, may be recorded on this certificate.

	A	B	C	D	E	F	G	H	I	J	K	L	M
1													
2		6		5		4		3		2		1	
3													
4		7		8		9		10		11		12	
5													
6		18		17		16		15		14		13	
7													
8		19		20		21		22		23		24	
9													
10		30		29		28		27		26		25	
11													
12		31		32		33		34		35		36	
13													

A. Description of original monument and accessories and/or subsequent restoration:

H-13	County Surveyor Records - NONE
1834 G.L.O., H. Parke D.S.	County Road Commission Records - NONE
Set quarter section post	Recorded Surveys - NONE
Cedar 7", East, 1 1/2 Links	Unrecorded Surveys - NONE
Do. 5", N46°W, 6 Links	

L.C.R.C. - NONE

B. Description of corner evidence found and/or method applied in restoring or reestablishing corner:

H-13  
 S 1/4 Cor, Section 34, T17N-R14E  
 Found 3/4" Iron Bar  
 Accepted as the best available evidence  
 of original corner position  
 (On Rapson Road)

SURVEY &  
 REMONUMENTATION

JAN 28 1999

SECTION

C. Description of monument for corner and accessories established to perpetuate locating the position of the corner:

H-13  
 S 1/4 Cor, Section 34, T17N-R14E  
 Found 3/4" Iron Bar  
 North 27.10' to East End of C.M.P.  
 N40°W 34.60' to West End of C.M.P.  
 S50°W 67.70' to Nail in Fence Post  
 N45°E 52.50' to Telephone Box  
 West 2639.06' to SW Cor, Sec 34, T17N-R14E  
 East 2628.86' to SE Cor, Sec 34, T17N-R14E

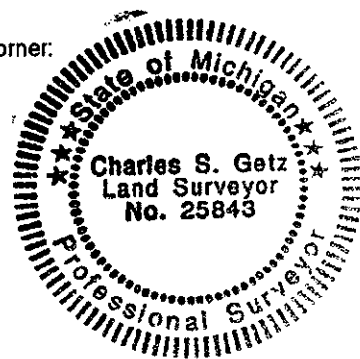

Signed by Charles S. Getz

Date November 8, 1998

Surveyor's Michigan License No. 25843

PEER GROUP APPROVED AT  
 MEETING 11-24-98 R&B