

LAND CORNER RECORDATION CERTIFICATE
Filing Requirement of Act 74, Mich. P.A. 1970

For corners in

<u>Huron</u> <small>(County)</small>	Located In:	Corner Code #	
1. Public Land Survey	Bloomfield	T17N R14E	K-13
		T R	
		T R	
		T R	
2. Property Controlling in Section	S	T R	
	S	T R	
3. Miscellaneous Property in Sec.	S	T R	
	S	T R	

STATE OF MICHIGAN
HURON COUNTY
RECORDED

25 NOV 98 10:05 A.M.

FRANCES L. HOLDWICK
REGISTER OF DEEDS

Register of Deeds Stamp & File Number

4. Lot No. _____, Recorded Plat _____
5. Private Claims _____

I, Charles S. Getz, in a field survey on Nov. 21, 1998 do hereby state that under requirements of P.A. 74, Michigan P.A. of 1970, the corner points mentioned in lines 1 and 2 above were in conformance with regulations and rules therefore as required in the current manual of survey instructions of the United States Department of the Interior, Bureau of Land Management or by a decree of a Court of Law and /or that the corner points mentioned in lines 3, 4 and 5 above were in conformance with the rules of the Michigan Board of Land Surveyors or by a Decree of a Court of Law, established, re-established, monumented, recovered, found as expressed below:

NOTE: Not more than 2 corners, all in the same town and range, may be recorded on this certificate.

1	A	B	C	D	E	F	G	H	I	J	K	L	M
2	6		5		4		3		2		1		
3													
4	7		8		9		10		11		12		
5													
6	18		17		16		15		14		13		
7													
8	19		20		21		22		23		24		
9													
10	30		29		28		27		26		25		
11													
12	31		32		33		34		35		36		
13													

A. Description of original monument and accessories and/or subsequent restoration:

K-13
1834 G.L.O., H. Parke D.S.
Set post
B. Ash 6", West, 4 1/2 Links
Hemlock 5", N53°E, 6 Links

County Surveyor Records - NONE
County Road Commission Records - Found Iron rod
Recorded Surveys - Survey Liber 2, Page 562, Fd. 3/4" Bar
Survey Liber 3, Page 601, Found 1" Pipe
Survey Liber 4, Page 704, Fd. 1 1/4" pipe in place
Unrecorded Surveys - Case Surveying, 11-7-83, Found 1 1/4" pipe over 3/4" re-rod
Huron Surveying, 6-12-97, Found 3/4" Re-Rod in Wood Post raised with 1/2" Re-Rod.

B. Description of corner evidence found and/or method applied in restoring or reestablishing corner:

K-13
SW Cor, Section 36, T17N-R14E
Found 1" Iron Pipe
Accepted as the best available evidence of original corner position
(Intersection of Rapson & Minden Roads)

**SURVEY &
REMONUMENTATION**

JAN 28 1999

SECTION

C. Description of monument for corner and accessories established to perpetuate locating the position of the corner:

K-13
SW Cor, Section 36, T17N-R14E
Found 1" Iron Pipe
S45°W 57.75' to Nail in SE Side of Power Pole
S45°E 36.30' to Notch in E. End of 36" C.M.P.
S30°E 26.85' to Stop Sign
N15°W 40.30' to Stop Sign
N45°W 48.10' to Telephone Box
N45°E 49.30' to Telephone Box
West 2630.04' to S 1/4 Cor, Sec 35, T17N-R14E
East 2626.64' to S 1/4 Cor, Sec 36, T17N-R14E

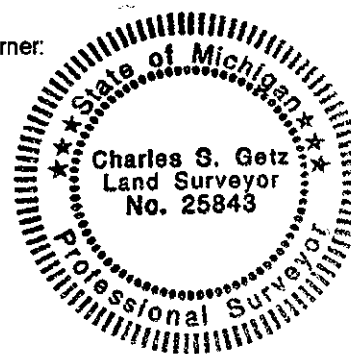

Signed by Charles S. Getz
Surveyor's Michigan License No. 25843

Date November 22, 1998

PEER GROUP APPROVED AT
MEETING 11-24-98 RLB