

Re-Mon., Liber 1, Page 164

REMONUMENTATION

LAND CORNER RECORDATION CERTIFICATE  
Filing Requirement of Act 74, Mich. P.A. 1970

For corners in

<u>Huron</u> (County)	Located In:	Corner Code #
1. Public Land Survey	Rubicon T17N R15E	C-13
	T___ R___	_____
	T___ R___	_____
	T___ R___	_____
2. Property Controlling in Section	S___ T___ R___	_____
	S___ T___ R___	_____
3. Miscellaneous Property in Sec.	S___ T___ R___	_____
	S___ T___ R___	_____

STATE OF MICHIGAN  
HURON COUNTY  
RECORDED

25 NOV 98 10:06 A.M.

FRANCES L. HOLDWICK  
REGISTER OF DEEDS

Register of Deeds Stamp & File Number

4. Lot No. \_\_\_\_\_, Recorded Plat \_\_\_\_\_  
5. Private Claims \_\_\_\_\_

I, Charles S. Getz, in a field survey on Nov. 04, 1998 do hereby state that under requirements of P.A. 74, Michigan P.A. of 1970, the corner points mentioned in lines 1 and 2 above were in conformance with regulations and rules therefore as required in the current manual of survey instructions of the United States Department of the Interior, Bureau of Land Management or by a decree of a Court of Law and /or that the corner points mentioned in lines 3, 4 and 5 above were in conformance with the rules of the Michigan Board of Land Surveyors or by a Decree of a Court of Law; established, re-established, monumented, recovered, found as expressed below.

NOTE: Not more than 2 corners, all in the same town and range, may be recorded on this certificate.

	A	B	C	D	E	F	G	H	I	J	K	L	M
1													
2		6		5		4		3		2		1	
3													
4		7		8		9		10		11		12	
5													
6		18		17		16		15		14		13	
7													
8		19		20		21		22		23		24	
9													
10		30		29		28		27		26		25	
11													
12		31		32		33		34		35		36	
13													

A. Description of original monument and accessories and/or subsequent restoration:

C-13  
1834 G.L.O., H. Parke D.S.  
Set post  
Cedar 8", N48°W, 7 Links  
Do. 11", N28½°E, 17 Links

County Surveyor Records - NONE  
County Road Commission Records - Monument Iron rod replacing old post.  
Recorded Surveys - Survey Liber 3, Page 597, Mon. box in place  
Unrecorded Surveys - Case Surveying, 10-26-95, Mon. box in place

L.C.R.C. - NONE

B. Description of corner evidence found and/or method applied in restoring or reestablishing corner:

C-13  
SW Cor, Section 32, T17N-R15E  
Found 2" Iron Bar in Monument Box  
Accepted as the best available evidence of original corner position  
(Intersection of Rapson & Ruth Rods)

SURVEY &  
REMONUMENTATION

JAN 28 1999

SECTION

C. Description of monument for corner and accessories established to perpetuate locating the position of the corner:

C-13  
SW Cor, Section 32, T17N-R15E  
Found 2" Iron Bar in Monument Box  
N40°E 52.55' to Nail in Telephone Pole  
N45°E 72.30' to Nail in Power Pole  
S45°E 51.50' to Nail in Telephone Pole  
South 21.0' to West Leg of Road Sign  
West 2631.89' to S 1/4 Cor, Sec 31, T17N-R15E  
East 2633.64' to S 1/4 Cor, Sec 32, T17N-R15E

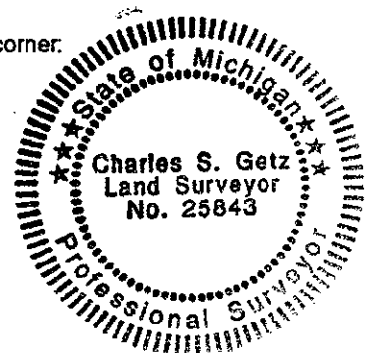

Signed by Charles S. Getz  
Surveyor's Michigan License No. 25843

Date November 8, 1998

PEER GROUP APPROVED AT  
MEETING 11-24-98 RLB