

**LAND CORNER RECORDATION CERTIFICATE**  
 Filing Requirement of Act 74, Mich. P.A. 1970

For corners in

<u>Huron</u> <small>(County)</small>	Located In:	Corner Code #
1. Public Land Survey	Rubicon	T17N R15E H-13
		T___ R___
		T___ R___
		T___ R___
2. Property Controlling in Section	S___	T___ R___
	S___	T___ R___
3. Miscellaneous Property in Sec.	S___	T___ R___
	S___	T___ R___

STATE OF MICHIGAN  
 HURON COUNTY  
 RECORDED

25 NOV 98 10:07 A.M.

FRANCES L. HOLDWICK  
 REGISTER OF DEEDS

Register of Deeds Stamp & File Number

4. Lot No. \_\_\_\_\_, Recorded Plat \_\_\_\_\_  
 5. Private Claims \_\_\_\_\_

I, Charles S. Getz, in a field survey on Nov. 12, 1998 do hereby state that under requirements of P.A. 74, Michigan P.A. of 1970, the corner points mentioned in lines 1 and 2 above were in conformance with regulations and rules therefore as required in the current manual of survey instructions of the United States Department of the Interior, Bureau of Land Management or by a decree of a Court of Law and /or that the corner points mentioned in lines 3, 4 and 5 above were in conformance with the rules of the Michigan Board of Land Surveyors or by a Decree of a Court of Law; established, re-established, monumented, recovered, found as expressed below:

NOTE: Not more than 2 corners, all in the same town and range, may be recorded on this certificate.

	A	B	C	D	E	F	G	H	I	J	K	L	M
1													
2	6		5		4		3		2		1		
3													
4	7		8		9		10		11		12		
5													
6	18		17		16		15		14		13		
7													
8	19		20		21		22		23		24		
9													
10	30		29		28		27		26		25		
11													
12	31		32		33		34		35		36		
13													

A. Description of original monument and accessories and/or subsequent restoration:

H-13  
 1834 G.L.O., H. Parke D.S.  
 Set quarter section post  
 Maple 8", N68°W, 27 Links  
 Hemlock 12", N39½°E, 35 Links

County Surveyor Records - NONE  
 County Road Commission Records - NONE  
 Recorded Surveys - NONE  
 Unrecorded Surveys - NONE

L.C.R.C. - NONE

B. Description of corner evidence found and/or method applied in restoring or reestablishing corner:

H-13  
 S 1/4 Cor, Section 34, T17N-R15E  
 Found no evidence of original corner position.  
 Re-established corner position by proportionate measure  
 from G.L.O. Notes, between I-13 and G-13 as best  
 evidence of original corner position for H-13.  
 (On Rapson Road)

**SURVEY &  
 REMONUMENTATION**

JAN 28 1999

SECTION

C. Description of monument for corner and accessories established to perpetuate locating the position of the corner:

H-13  
 S 1/4 Cor, Section 34, T17N-R15E  
 Set 1/2" Re-Rod (Capped)  
 N20°E 27.50' to East End of C.M.P.  
 N20°W 28.00' to West End of C.M.P.  
 S70°W 98.70' to Nail in Power Pole  
 West 2630.60' to SW Cor, Sec 34, T17N-R15E  
 East 2630.60' to SE Cor, Sec 34, T17N-R15E

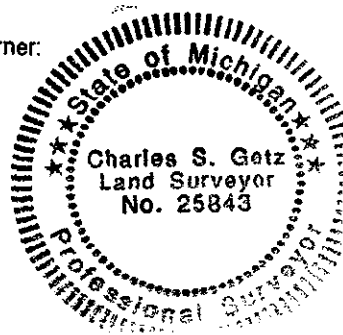

Signed by Charles S. Getz  
 Surveyor's Michigan License No. 25843

Date November 15, 1998

PEER GROUP APPROVED AT  
 MEETING 11-24-98 RRB