

Re Mon Liber 1, Page 241

1999 REMONUMENTATION

LAND CORNER RECORDATION CERTIFICATE  
Filing Requirement of Act 74, Mich. P.A. 1970

STATE OF MICHIGAN  
HURON COUNTY  
RECORDED

For corners in

Huron

(County)

Located In:

Corner Code #

- 1. Public Land Survey Dwight T18N R13E H-13  
T R  
T R  
T R
- 2. Property Controlling in Section S T R  
S T R
- 3. Miscellaneous Property in Sec. S T R  
S T R

28 OCT 99 9:12 A.M.

FRANCES L. HODNICK  
REGISTER OF DEEDS

Register of Deeds Stamp & File Number

- 4. Lot No. \_\_\_\_\_, Recorded Plat \_\_\_\_\_
- 5. Private Claims \_\_\_\_\_

I, Charles S. Getz, in a field survey on April 12, 1999 do hereby state that under requirements of P.A. 74, Michigan P.A. of 1970, the corner points mentioned in lines 1 and 2 above were in conformance with regulations and rules therefore as required in the current manual of survey instructions of the United States Department of the Interior, Bureau of Land Management or by a decree of a Court of Law and/or that the corner points mentioned in lines 3, 4 and 5 above were in conformance with the rules of the Michigan Board of Land Surveyors or by a Decree of a Court of Law; established, re-established, monumented, recovered, found as expressed below:

NOTE: Not more than 2 corners, all in the same town and range, may be recorded on this certificate.

	A	B	C	D	E	F	G	H	I	J	K	L	M
1													
2		6		5		4		3		2		1	
3													
4		7		8		9		10		11		12	
5													
6		18		17		16		15		14		13	
7													
8		19		20		21		22		23		24	
9													
10		30		29		28		27		26		25	
11													
12		31		32		33		34		35		36	
13													

A. Description of original monument and accessories and/or subsequent restoration:

H-13 1834 G.L.O., H. Parke D.S. County Road Commission Records - Cedar Post  
 Set quarter section post Recorded Surveys -  
 Cedar 9", N76°E, 11 Links Case, 7-9-81, Liber 4, Page 541, 3/4" Pin, raised with pipe  
 Pine 26", N42°W, 10 Links Unrecorded Surveys -  
 Case, 12-6-88, 3/4" st. pipe in Mon. Box.

L.C.R.C. - NONE

County Surveyor Records -  
NONE

B. Description of corner evidence found and/or method applied in restoring or reestablishing corner:

H-13  
 S 1/4 Cor, Section 34, T18N-R13E  
 Found 1" Pipe in Monument Box  
 Accepted as the best available evidence  
 of original corner position  
 (On Kinde Road)

RECORDED

FEB 03 2000

SECTION

C. Description of monument for corner and accessories established to perpetuate locating the position of the corner:

H-13  
 S 1/4 Cor, Section 34, T18N-R13E  
 Found 1" Pipe in Monument Box  
 S75°W 92.30' to East End of Culvert  
 North 44.60' to Metal Fence Post  
 N45°W 30.00' to Iron Bar  
 N45°E 30.00' to Iron Bar  
 West 2629.80' to SW Cor, Sec 34, T18N-R13E  
 East 2636.68' to SE Cor, Sec 34, T18N-R13E

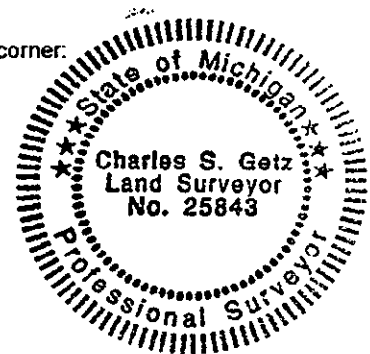

Signed by Charles S. Getz  
 Surveyor's Michigan License No. 25843

Date August 14, 1999

PEER GROUP APPROVED AT MEETING  
 HELD October 26, 1999 RAFB