

Re Mon River, Page 255

1999 REMONUMENTATION

LAND CORNER RECORDATION CERTIFICATE
Filing Requirement of Act 74, Mich. P.A. 1970

For corners in

Huron
(County)

Located in:

Corner Code #

1. Public Land Survey	Huron	T18N R14E	I-13
		T R	
		T R	
		T R	
2. Property Controlling in Section	S	T R	
	S	T R	
3. Miscellaneous Property in Sec.	S	T R	
	S	T R	

STATE OF MICHIGAN
HURON COUNTY
RECORDED
28 OCT 99 9:14 A.M.
FRANCES L. HOLWICK
REGISTER OF DEEDS
Register of Deeds Stamp & File Number

4. Lot No. _____, Recorded Plat _____
5. Private Claims _____

I, Charles S. Getz, in a field survey on April 14, 1999 do hereby state that under requirements of P.A. 74, Michigan P.A. of 1970, the corner points mentioned in lines 1 and 2 above were in conformance with regulations and rules therefore as required in the current manual of survey instructions of the United States Department of the Interior, Bureau of Land Management or by a decree of a Court of Law and for that the corner points mentioned in lines 3, 4 and 5 above were in conformance with the rules of the Michigan Board of Land Surveyors or by a Decree of a Court of Law; established, re-established, monumented, recovered, found as expressed below:

NOTE: Not more than 2 corners, all in the same town and range, may be recorded on this certificate.

	A	B	C	D	E	F	G	H	I	J	K	L	M
1													
2	6		5		4		3		2		1		
3													
4	7		8		9		10		11		12		
5													
6	18		17		16		15		14		13		
7													
8	19		20		21		22		23		24		
9													
10	30		29		28		27		26		25		
11													
12	31		32		33		34		35		36		
13													

A. Description of original monument and accessories and/or subsequent restoration:
I-13 1834 G.L.O., H. Parke D.S. County Road Commission Records - Iron Rod over Pointed Stone
Set Post Recorded Surveys - NONE
Beech 14", N62°E, 22 Links Unrecorded Surveys - NONE
Hemlock 30", N19½°W, 34 Links
L.C.R.C. - NONE
County Surveyor Records -
March 21-1895, March 18-1895
Surveys show Corner

B. Description of corner evidence found and/or method applied in restoring or reestablishing corner:
I-13
SW Cor, Section 35, T18N-R14E
Found no evidence of original corner position
Re-established corner position by using G.L.O.
offset from NW Cor, Sec 2, T17N-R14E, as best
evidence of original corner position for I-13
(Intersection of Kinde & Parisville Roads)

C. Description of monument for corner and accessories established to perpetuate locating the position of the corner:
I-13
SW Cor, Section 35, T18N-R14E
Set 1/2" Iron Bar in Monument Box (Capped)
East 31.02' to Monument Box
N25°W 62.60' to Nail in Power Pole
N35°E 38.15' to West Leg of Road Sign
South 21.00' to East Leg of Road Sign
N20°E 50.30' to Nail in Telephone Pole
West 2653.32' to S 1/4 Cor, Sec 34, T18N-R14E
East 2645.21' to S 1/4 Cor, Sec 35, T18N-R14E

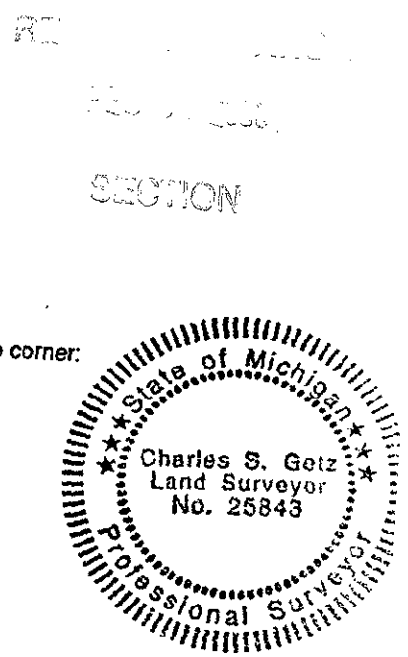

Signed by Charles S. Getz
Surveyor's Michigan License No. 25843

Date August 16, 1999

PEER GROUP APPROVED AT MEETING
HELD October 26, 1999 R.P.B.