

**LAND CORNER RECORDATION CERTIFICATE**  
Filing Requirement of Act 74, Mich. P.A. 1970

STATE OF MICHIGAN  
HURON COUNTY  
RECORDED

28 OCT 99 9:15 A.M.

FRANCES L. HOLIDWICK  
REGISTER OF DEEDS

For corners in

<u>Huron</u>	Located In:	Corner Code #	
(County)			
1. Public Land Survey	Huron	T <u>18</u> N R <u>14</u> E	<u>L-13</u>
		T___ R___	_____
		T___ R___	_____
		T___ R___	_____
2. Property Controlling in Section	S___	T___ R___	_____
	S___	T___ R___	_____
3. Miscellaneous Property in Sec.	S___	T___ R___	_____
	S___	T___ R___	_____

Register of Deeds Stamp & File Number

4. Lot No. \_\_\_\_\_, Recorded Plat \_\_\_\_\_  
5. Private Claims \_\_\_\_\_

I, Charles S. Getz, in a field survey on April 14, 1999 do hereby state that under requirements of P.A. 74, Michigan P.A. of 1970, the corner points mentioned in lines 1 and 2 above were in conformance with regulations and rules therefore as required in the current manual of survey instructions of the United States Department of the Interior, Bureau of Land Management or by a decree of a Court of Law and /or that the corner points mentioned in lines 3, 4 and 5 above were in conformance with the rules of the Michigan Board of Land Surveyors or by a Decree of a Court of Law; established, re-established, monumented, recovered, found as expressed below:

NOTE: Not more than 2 corners, all in the same town and range, may be recorded on this certificate.

	A	B	C	D	E	F	G	H	I	J	K	L	M
1													
2	6			5			4		3			2	1
3													
4	7			8			9		10			11	12
5													
6	10			17			16		15			14	13
7													
8	19			20			21		22			23	24
9													
10	30			29			28		27			26	25
11													
12	31			32			33		34			35	36
13													●

A. Description of original monument and accessories and/or subsequent restoration:

L-13 1834 G.L.O., H. Parke D.S. County Road Commission Records - Appears to refer to Bloomfield Cor  
Set quarter section post  
Sugar, N14½°E, 28½ Links Recorded Surveys - NONE  
Beech 12", N87°W, 21½ Links Unrecorded Surveys - NONE  
L.C.R.C. - NONE

County Surveyor Records -  
April 18th, 1884 - Survey shows Corner

B. Description of corner evidence found and/or method applied in restoring or reestablishing corner:

L-13  
S 1/4 Cor, Section 36, T18N-R14E  
Found no evidence of original corner position  
Re-established corner position by porportionate measure from G.L.O. Notes, between M-13 and K-13 as best evidence of original corner position for L-13  
(On Kinde Road)

C. Description of monument for corner and accessories established to perpetuate locating the position of the corner:

L-13  
S 1/4 Cor, Section 36, T18N-R14E  
Set 1/2" Iron Bar in Monument Box (Capped)  
East 17.70' to Monument Box  
S05°E 56.00' to Nail in North Sign Post  
South 34.70' to Culvert  
S60°E 118.70' to Nail in Power Pole  
West 2641.27' to SW Cor, Sec 36, T18N-R14E  
East 2641.27' to SE Cor, Sec 36, T18N-R14E

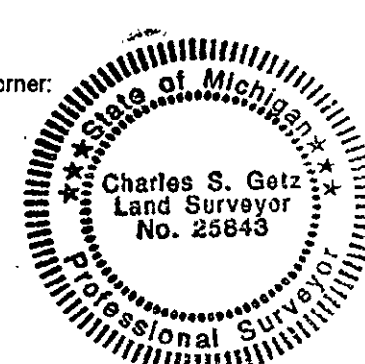

Signed by Charles S. Getz

Date August 21, 1999

Surveyor's Michigan License No. 25843

PEER GROUP APPROVED AT 1999 REMONUMENTATION

MEETING HELD October 26, 1999 *R.L.B.*