

Re Mon. Liber 2, Page 43

1999 REMONUMENTATION
LAND CORNER RECORDATION CERTIFICATE
Filing Requirement of Act 74, Mich. P.A. 1970

For Corners in PORT AUSTIN Township

<u>Huron</u> (County)	Located in:	Corner Code #
1. Public Land Survey	T 19N R 12E	L-13
	T-----R-----	
	T-----R-----	
	T-----R-----	
2. Property Controlling S in Section S	T-----R-----	
	T-----R-----	
3. Miscellaneous S Property in Sec. S	T-----R-----	
	T-----R-----	

STATE OF MICHIGAN
HURON COUNTY
RECORDED
30 DEC 99 2:17 P.M.
FRANCES L. HOLDWICK
REGISTER OF DEEDS

Register of Deeds Stamp & File Number

SECTION

4. Lot No. _____, Recorded Plat _____
5. Private Claims _____

1	A	B	C	D	E	F	G	H	I	J	K	L	M
2	6		5		4		3		2		1		
3													
4	7		6		9		10		11		12		
5													
6	18		17		16		15		14		13		
7													
8	19		20		21		22		23		24		
9													
10	30		29		28		27		26		25		
11													
12	31		32		33		34		35		36		
13													

I, Russell L. Brown, in a field survey on Dec. 14, 1999 do hereby state that under requirements of P.A. 74, Michigan P.A. of 1970, the corner points mentioned in lines 1 and 2 above were in conformance with regulations and rules therefore as required in the current manual of survey instructions of the United States Department of the Interior, Bureau of Land Management or by a decree of a Court of Law and/or that the corner points mentioned in lines 3, 4, and 5 above were in conformance with the rules of the Michigan Board of Land Surveyors or by a Decree of a Court of Law; established, re-established, monumented, recovered, found as expressed below:

NOTE: Not more than 2 corners, all in the same town and range, may be recorded on this certificate.

A. Description of original monument and accessories and/or subsequent restoration:
 1834 G.L.O. H. Parke D.S. Set quarter Section Post, Birch 10 N80W 18, Aspen 14 N78 1/2E 55
 County Surveyors Records - None
 County Road Commission Records 4" Cedar post 11.8' East of North 1/4 Corner Section 1, Hume Township
 L.C.R.C. - None
 Recorded Surveys Sept. 29, 1972 Stewart G. Case P.S. 15399, Found Cedar Post in place, placed 1/2" Steel Pin in Cedar Post; WITNESSES: Spike in East Side of Corner Post S23°W 36.0'; Spike in Southeast Side of Fence Post N50°E 49.40'; Spike in Southwest Side of Fence Post N50°W 66.0'
 Unrecorded Surveys - None

B. Description of corner evidence found and/or method applied in restoring or reestablishing corner:
 No evidence of original corner or accessories found.

Found 1/2" Steel Stake and pieces of Wood Post.

Accepted found 1/2" Steel Stake as best evidence of original corner position.

Capped found 1/2" Steel Stake P.S. 24588

C. Description of monument for corner and accessories established to perpetuate locating the position of the corner:

L-13, South 1/4 Corner Section 36, T19N-R12E
 Found 1/2" Steel stake, capped P.S. 24588
 WITNESSES:
 North 18.40' to 1/2" Steel stake
 S05°W 33.90' to Spike in East Side of Anchor post
 S70°E 132.57' to P.K. Nail in Southwest Side of Power Pole
 S70°W 116.68' to P.K. Nail in North Side of Power Pole
 East 2635.83' to M-13, Southeast Corner Section 36, T19N-R12E
 West 2624.985' to K-13; Southwest Corner Section 36, T19N-R12E

Signed by Russell L. Brown
 Surveyor's Michigan License No. 24588

Date DEC. 27, 1999

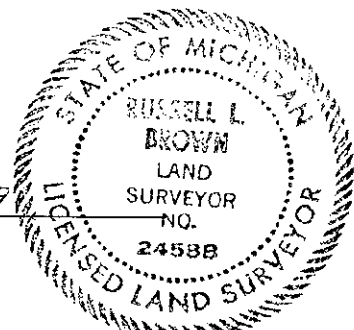

Peer group approved at meeting held 12-27-99, RLB