

Re - Mon. Lidew 2, Page 38

1999 REMONUMENTATION
LAND CORNER RECORDATION CERTIFICATE
Filing Requirement of Act 74, Mich. P.A. 1970

For Corners in PORT AUSTIN Township

Huron (County)	Located in:	Corner Code #
1. Public Land Survey	T 19N R 13E	C - 13
	T ----- R -----	
	T ----- R -----	
	T ----- R -----	
2. Property Controlling S in Section S	T ----- R -----	
	T ----- R -----	
3. Miscellaneous S Property in Sec. S	T ----- R -----	
	T ----- R -----	

STATE OF MICHIGAN
HURON COUNTY
RECORDED

30 DEC 99 2:16 P.M.

FRANCES L. HOLDWICK
REGISTER OF DEEDS

Register of Deeds Stamp & File Number

- 4. Lot No. _____, Recorded Plat _____
- 5. Private Claims _____

SECTION

I, Russell L. Brown, in a field survey on Dec. 10, 1999 do hereby state that under requirements of P.A. 74, Michigan P.A. of 1970, the corner points mentioned in lines 1 and 2 above were in conformance with regulations and rules therefore as required in the current manual of survey instructions of the United States Department of the Interior, Bureau of Land Management or by a decree of a Court of Law and/or that the corner points mentioned in lines 3, 4, and 5 above were in conformance with the rules of the Michigan Board of Land Surveyors or by a Decree of a Court of Law; established, re-established, monumented, recovered, found as expressed below:

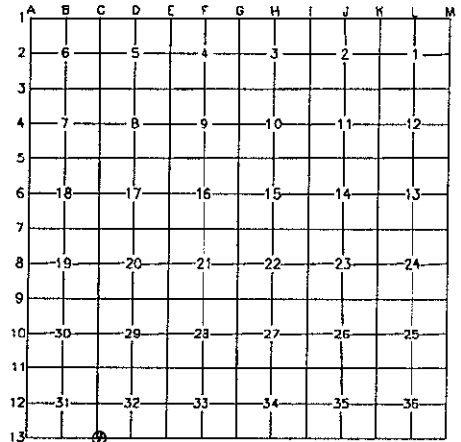

NOTE: Not more than 2 corners, all in the same town and range, may be recorded on this certificate.

A. Description of original monument and accessories and/or subsequent restoration:
 1834 G.L.O. H. Parke D.S. Set Post Corner Section 31 and 32, Hemlock 28 N87E 33, Do. 22 N82 1/2W 16
 County Surveyors Records - None
 County Road Commissions Records Iron Rod, Apperant center of grades to North, East and West.
 L.C.R.C. - None
 Recorded Surveys - None
 Unrecorded Surveys - August 30, 1993 Huron Surveying, Inc. Russell L. Brown P.S. 24588 Found P.K. Nail
 WITNESSES: N20°E 56.88' to Spike in Northwest Side of Power Pole
 S05°E 43.27' to Spike in East Side of Wood Post, West 33.0' to Steel Stake, Northeast Corner Section 6, T18N-R13E

B. Description of corner evidence found and/or method applied in restoring or reestablishing corner:
 No evidence of original Corner or accessories found.
 No Evidence of Iron Rod cited in County Road Commission records

Found P.K. Nail

Accepted found P.K. Nail as best evidence of original corner position.

Removed P.K. Nail and Set 1/2" x 18" Steel Stake capped P.S. 24588 in Monument Box.

C. Description of monument for corner and accessories established to perpetuate locating the position of the corner:
 C-13, South Corner Sections 31 and 32, T19N-R13E,
 Set 1/2" x 18" Steel Stake capped P.S. 24588 in monument box
 WITNESSES:
 N15°E 56.90' to Spike in Northwest face of Power Pole
 South 43.18' to Spike in East Face Ped. Support post
 S45°W 78.80' to Notch in West end 12" C.M.P.
 N50°W 51.97' to Spike in West face Fence Post
 East 2608.99' to D-13, South 1/4 Corner of Section 32, T19N-R13E
 West 2636.99' to B-13, South 1/4 Corner of Section 31, T19N-R13E

Signed by Russell L. Brown
Surveyor's Michigan License No. 24588

Date DEC. 27, 1999

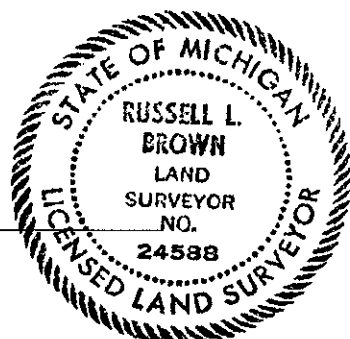

Peer group approved at meeting held 12-27-99, RLB