

Re-Mon. Libwa, Page 37

1999 REMONUMENTATION
LAND CORNER RECORDATION CERTIFICATE
Filing Requirement of Act 74, Mich. P.A. 1970

For Corners in PORT AUSTIN Township

<u>Huron</u> (County)	Located in:	Corner Code #
1. Public Land Survey	T 19N R 13E	D - 13
	T ----- R -----	
	T ----- R -----	
	T ----- R -----	
2. Property Controlling S in Section S	T ----- R -----	
	T ----- R -----	
3. Miscellaneous S Property in Sec. S	T ----- R -----	
	T ----- R -----	

STATE OF MICHIGAN
HURON COUNTY
RECORDED

30 DEC 99 2:15 P.M.

FRANCES L. HOLDWICK
REGISTER OF DEEDS

Register of Deeds Stamp & File Number

4. Lot No. _____, Recorded Plat _____
5. Private Claims _____

SECTION

I, Russell L. Brown, in a field survey on Dec. 9, 1999 do hereby state that under requirements of P.A. 74, Michigan P.A. of 1970, the corner points mentioned in lines 1 and 2 above were in conformance with regulations and rules therefore as required in the current manual of survey instructions of the United States Department of the Interior, Bureau of Land Management or by a decree of a Court of Law and/or that the corner points mentioned in lines 3, 4, and 5 above were in conformance with the rules of the Michigan Board of Land Surveyors or by a Decree of a Court of Law; established, re-established, monumented, recovered, found as expressed below:

1	A	B	C	D	E	F	G	H	I	J	K	L	M
2		6		5		4		3		2		1	
3													
4		7		8		9		10		11		12	
5													
6		18		17		16		15		14		13	
7													
8		19		20		21		22		23		24	
9													
10		30		29		28		27		26		25	
11													
12		31		32		33		34		35		36	
13													

NOTE: Not more than 2 corners, all in the same town and range, may be recorded on this certificate.

A. Description of original monument and accessories and/or subsequent restoration:
1834 G.L.O. H. Parke D.S. Set quarter Section Post, B. Ash 11 N56W 5 1/2, Do. 8 N26E 17
County Surveyors Records - None
County Road Commission Records - None
L.C.R.C. - None
Recorded Surveys - None
Unrecorded Surveys - None

B. Description of corner evidence found and/or method applied in restoring or reestablishing corner:
No evidence of original corner or accessories found.

Set 1/2" x 18" Steel Stake capped P.S. 24588. calculated G.L.O. offset (23.10') East of 3/4" Re-Rod, apparent North 1/4 Corner of Section 5, T18N-R13E, as best evidence of original corner position.

C. Description of monument for corner and accessories established to perpetuate locating the position of the corner:

D- 13, South 1/4 Corner Section 32, T19N-R13E
Set 1/2" x 18" Steel Stake capped P.S. 24588
WITNESSES:
N05°W 50.03' to P.K. Nail in West Side of power pole
S15°W 18.18' to 1/2" Steel Stake
S50°W 30.13' to 1/2" Steel Stake
N60°W 33.52' to 1/2" Steel Stake
East 2646.55' to E-13, Southeast Corner Section 32, T19N-R13E
West 2608.99' to C-13, Southwest Corner Section 32, T19N-R13E

Signed by Russell L. Brown
Surveyor's Michigan License No. 24588

Date Dec. 27, 1999

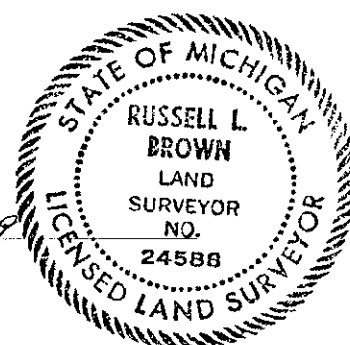

Peer group approved at meeting held 12-27-99, RLB