

Re-Mon. Liber 2, Page 28

1999 REMONUMENTATION  
LAND CORNER RECORDATION CERTIFICATE  
Filing Requirement of Act 74, Mich. P.A. 1970

For Corners in PORT AUSTIN Township

<u>Huron</u> (County)	Located in:	Corner Code #
1. Public Land Survey	T 19N R 13E	L - 13
	T ----- R -----	
	T ----- R -----	
	T ----- R -----	
2. Property Controlling S in Section S	T ----- R -----	
	T ----- R -----	
3. Miscellaneous S Property in Sec. S	T ----- R -----	
	T ----- R -----	

STATE OF MICHIGAN  
HURON COUNTY  
RECORDED

30 DEC 99 2:14 P.M.

FRANCES L. HOLDWICK  
REGISTER OF DEEDS

Register of Deeds Stamp & File Number

4. Lot No. \_\_\_\_\_, Recorded Plat \_\_\_\_\_  
5. Private Claims \_\_\_\_\_

SECTION

I, Russell L. Brown, in a field survey on Dec. 7, 1999 do hereby state that under requirements of P.A. 74, Michigan P.A. of 1970, the corner points mentioned in lines 1 and 2 above were in conformance with regulations and rules therefore as required in the current manual of survey instructions of the United States Department of the Interior, Bureau of Land Management or by a decree of a Court of Law and/or that the corner points mentioned in lines 3, 4, and 5 above were in conformance with the rules of the Michigan Board of Land Surveyors or by a Decree of a Court of Law; established, re-established, monumented, recovered, found as expressed below:

1	A	B	C	D	E	F	G	H	I	J	K	L	M
2		6		5		4		3		2		1	
3													
4		7		6		0		10		11		12	
5													
6		18		17		16		15		14		13	
7													
8		19		20		21		22		23		24	
9													
10		30		29		28		27		26		25	
11													
12		31		32		33		34		35		36	
13													

NOTE: Not more than 2 corners, all in the same town and range, may be recorded on this certificate.

A. Description of original monument and accessories and/or subsequent restoration:  
1834 G.L.O. - H. Parke D.S. Set quarter Section Post, Cedar 14 N58W 23 1/2, Do. 7 N65 1/2E 18  
County Surveyors Records - None  
County Road Commissions Records - None  
L.C.R.C. - None  
Recorded Surveys - None  
Unrecorded Surveys - None

B. Description of corner evidence found and/or method applied in restoring or reestablishing corner:  
No evidence of original corner or accessories found.

Set 1/2" x 18" Steel Stake capped P.S. 24588 by single proportional measure between corners K-13 and M-13 as best evidence of original corner position.

C. Description of monument for corner and accessories established to perpetuate locating the position of the corner:

L-13, South 1/4 Corner Section 36, T19N-R13E  
Set 1/2" x 18" Steel Stake capped P.S. 24588  
WITNESSES  
N15°W 34.00' to Spike in West Side of Anchor Post  
N60°E 147.90' to P.K. Nail in Northwest Side of Power Pole  
S60°W 77.19' to P.K. Nail in Southeast Side of Power Pole  
S50°E 22.83' to 1/2" Steel Stake  
East 2634.55' to M-13, Southeast Corner Section 36, T19N-R13E  
West 2634.55' to K-13, Southwest Corner Section 36, T19N-R13E

Signed by Russell L. Brown  
Surveyor's Michigan License No. 24588

Date Dec 27, 1999

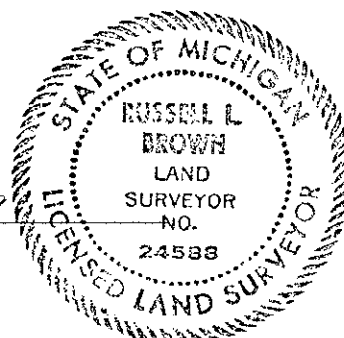

Peer group approved at meeting held 12-27-99, RLB