

V-42

V-41

V-70

Witnesses to E. 1/4 Cor.  
 Sec. 35, (1/2" pipe)  
 S 25° E - 3" Apple - 53.75'  
 S 86° E - Cor. Fern Post - 29.35'

Witnesses to N.E. Sec. Cor.  
 Sec. 35, (1/2" pipe)  
 N 04° W - Tel. pole - 44.36'  
 S 58° E - Post Pole - 84.01'  
 S 43° W - Cor. Fern Post - 60.71'  
 1.20' Lt. of 1089 + 92.90

Witnesses to E. 1/4 Cor.  
 Sec. 26, (1" pipe)  
 N 46° W - 9" Oak - 100.45'  
 N 70° E - 16" Apple - 78.81'  
 S 52° E - 60" Elm - 20.65'

T 19 N, R 13 E

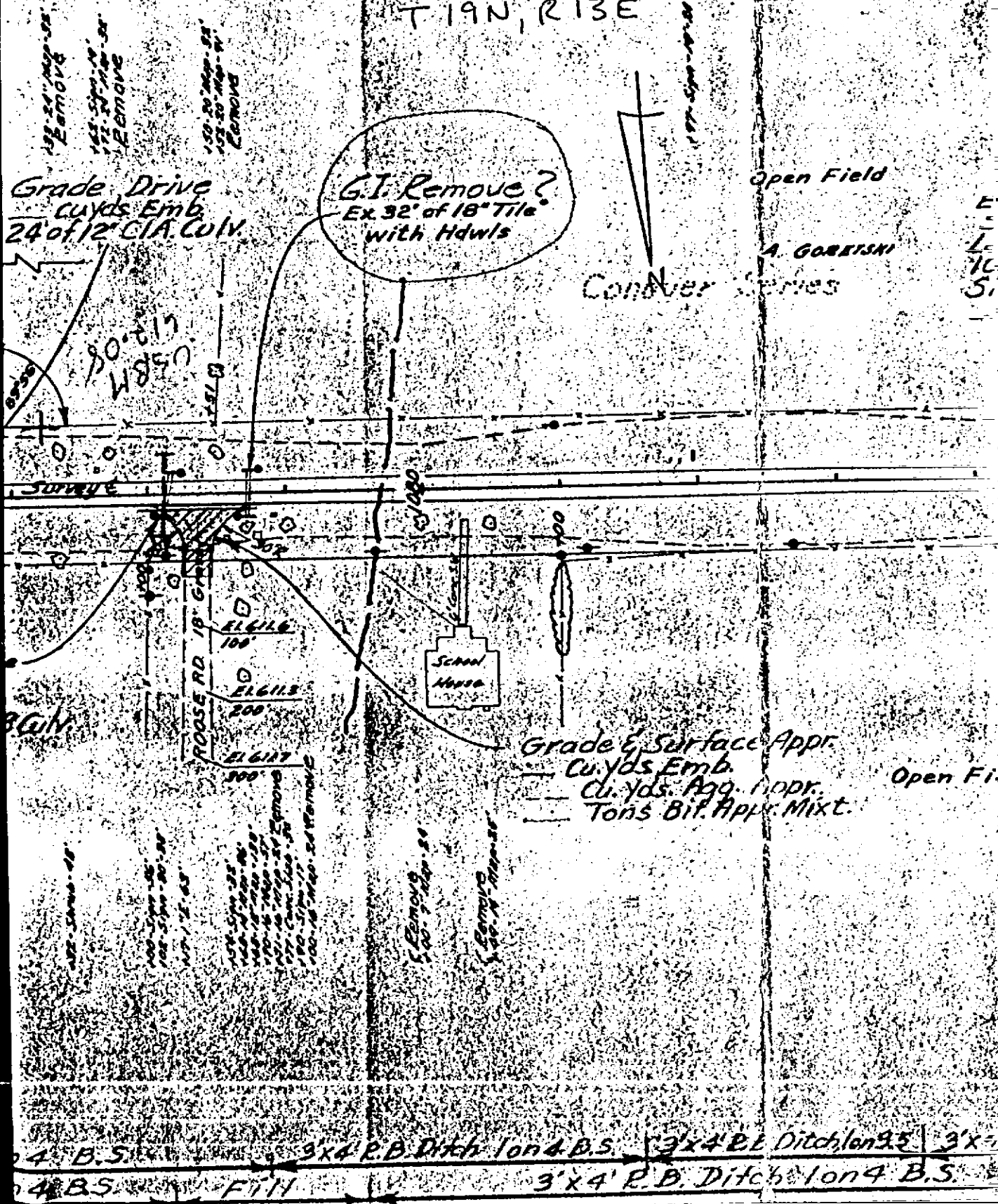

E  
L  
70  
5

Open Fi

4 B.S. 3'x4' R.B. Ditch 1 on 4 B.S. 3'x4' R.B. Ditch 1 on 4 B.S. 3'x4'  
 4 B.S. FIN 3'x4' R.B. Ditch 1 on 4 B.S.