

643.32
 1/4 in
 Max Elder
 1008+49

Witnesses to S. 1/4 Cor.
 Sec. 31, 3/4" pipe
 S53°E - 24" Balm of Gilead - 48.04'
 S 06°W - Cor. Fen. Post - 34.56'

Curve Data
 $\Delta = 47^{\circ}27'00''$ Lt.
 $D = 2^{\circ}00'$
 $R = 2864.93'$
 $T = 1259.05'$
 $L = 2372.50'$
 $E = 264.46'$
 $PC = 998+89.62$
 $PI = 1011+48.67$
 $PT = 1022+62.12$
 Superel. .05'/ft.

Witnesses to P.I. 1011
 S64°30'W - Tel. Pole -
 S77°30'E - 25" Elm -
 S46°30'E - 9" B.E. -
 Boatspike

SEC 31, T19N, R14E

Sec
 T19.

WITNESSES TO N 1/4 COR
 SEC 31, 3/4" PIPE
 N 62°W - TEL. POLE - 81.02'
 S 73°E - 12" ASH - 64.52'
 S 42°W - TEL. POLE - 61.05'

Prop. R.O.W.

Prop. 120' R.O.W.

J. REIMANN

G. ROTHE

Grade Drive
 Cu. Yds. Emb.

Kaukaulin Series

B13'A

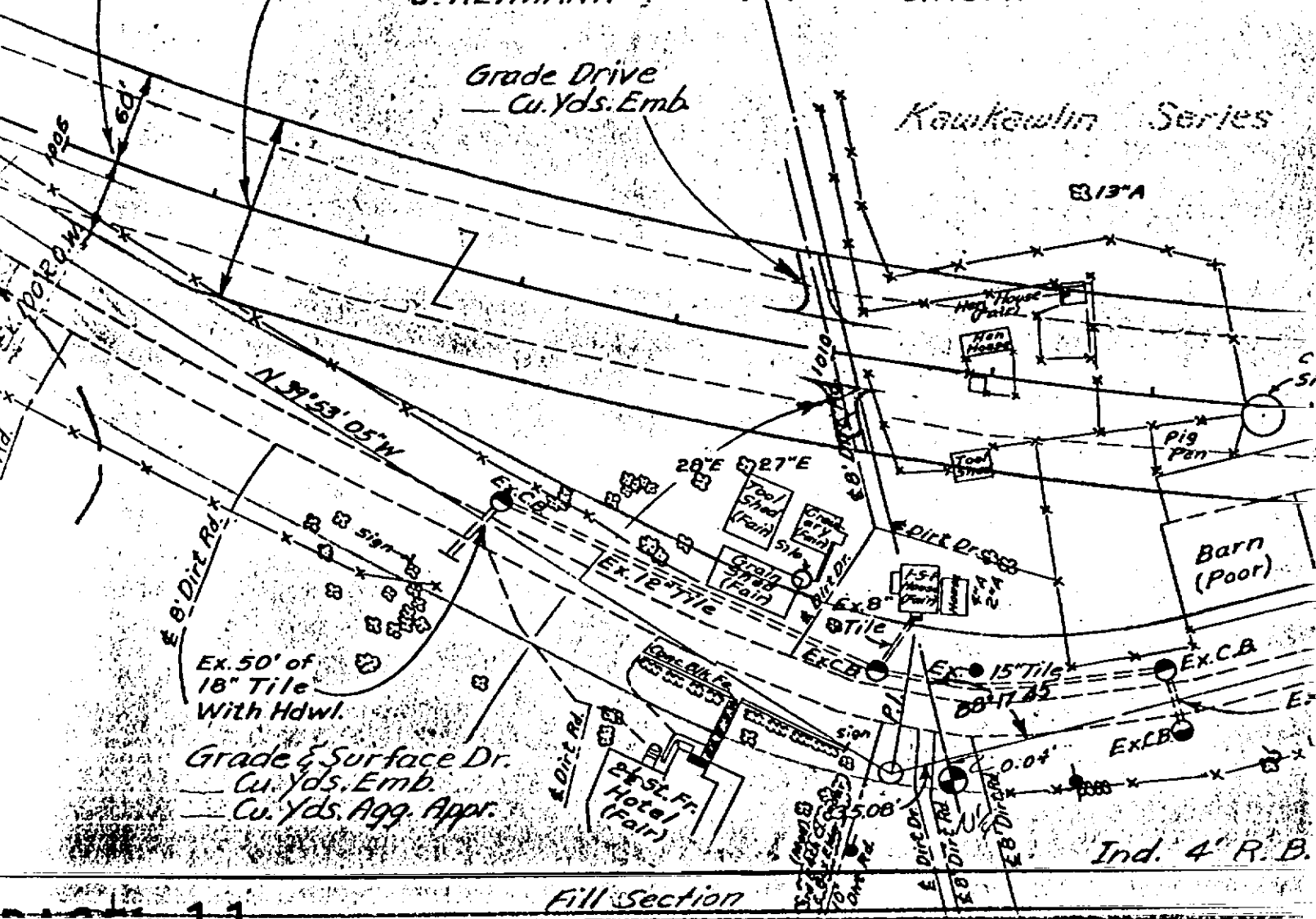

Ex. 50' of
 18" Tile
 With Hdwl.

Grade & Surface Dr.
 Cu. Yds. Emb.
 Cu. Yds. Agg. Appr.

Fill Section

Ind. 4' R.B.