

Re-Mon. Libw 2, Page 47

1999 REMONUMENTATION
LAND CORNER RECORDATION CERTIFICATE
Filing Requirement of Act 74, Mich. P.A. 1970

For Corners in PORT AUSTIN Township

Huron (County)	Located in:	Corner Code #
1. Public Land Survey	T 19N R 14E	B - 13
	T ----- R -----	
	T ----- R -----	
	T ----- R -----	
2. Property Controlling S in Section S	T ----- R -----	
	T ----- R -----	
3. Miscellaneous S Property in Sec. S	T ----- R -----	
	T ----- R -----	

STATE OF MICHIGAN
HURON COUNTY
RECORDED

30 DEC 99 2:17 P.M.

FRANCES L. HOLDWICK
REGISTER OF DEEDS

Register of Deeds Stamp & File Number

4. Lot No. _____, Recorded Plat _____

5. Private Claims _____

SECTION

1	A	B	C	D	E	F	G	H	I	J	K	L	M
2		6		5		4		3		2		1	
3													
4		7		8		9		10		11		12	
5													
6		18		17		16		15		14		13	
7													
8		19		20		21		22		23		24	
9													
10		30		29		28		27		26		25	
11													
12		31		32		33		34		35		36	
13													

I, Russell L. Brown, in a field survey on Nov. 1, 1999 do hereby state that under requirements of P.A. 74, Michigan P.A. of 1970, the corner points mentioned in lines 1 and 2 above were in conformance with regulations and rules therefore as required in the current manual of survey instructions of the United States Department of the Interior, Bureau of Land Management or by a decree of a Court of Law and/or that the corner points mentioned in lines 3, 4, and 5 above were in conformance with the rules of the Michigan Board of Land Surveyors or by a Decree of a Court of Law; established, re-established, monumented, recovered, found as expressed below:

NOTE: Not more than 2 corners, all in the same town and range, may be recorded on this certificate.

A. Description of original monument and accessories and/or subsequent restoration:
 1834 G.L.O. H. Parke D.S. Set quarter Section Post; Hemlock 20 N38 1/2W 38, Do. 15 N18E 13
 County Surveyors Records - None
 County Road Commission Records - None
 L.C.R.C. - None
 Recorded Surveys: - None
 Unrecorded Surveys - None

B. Description of corner evidence found and/or method applied in restoring or reestablishing corner:
 No evidence of original corner of accessories found.

Set 1/2" x 18" Iron capped P.S. 24588 by Single proportionate measurement between A-13 and C-13, as best evidence of original corner position.

C. Description of monument for corner and accessories established to perpetuate locating the position of the corner:
 B-13 South 1/4 Corner Section 31, T19N-T14E
 Set 1/2" x 18" Capped Iron, P.S. 24588
 WITNESSES:
 North 29.81' to 1/2" x 18" Steel Stake in Gravel Field Drive
 S45°E 21.76' to 1/2" x 18" Steel Stake in Gravel Field Drive
 S60°W 64.20' to Spike in South Side Power Pole
 West 58.21' to 5/8" Re-Rod; Apparent North 1/4 Corner Section 6, T18N-R14E
 East 2645.23' to C-13, Corner Sections 31 and 32
 West 2645.23' to A-13, Southwest Corner Section 31

Signed by Russell L. Brown
Surveyor's Michigan License No. 24588

Date Dec 27, 1999

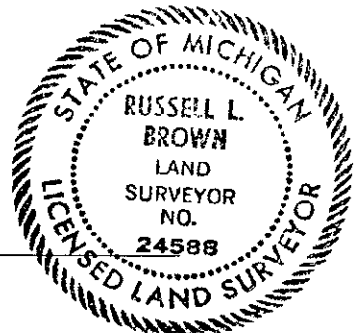

Peer group approved at meeting held 12-27-99, RUB