

Re. Mon. Liber 2, Page 50

1999 REMONUMENTATION  
LAND CORNER RECORDATION CERTIFICATE  
Filing Requirement of Act 74, Mich. P.A. 1970

For Corners in PORT AUSTIN Township

<u>Huron</u> (County)	Located in:	Corner Code #
1. Public Land Survey	T 19N R 14E	E - 13
	T-----R-----	
	T-----R-----	
	T-----R-----	
2. Property Controlling S in Section S	T-----R-----	
	T-----R-----	
3. Miscellaneous S Property in Sec. S	T-----R-----	
	T-----R-----	

STATE OF MICHIGAN  
HURON COUNTY  
RECORDED

30 DEC 99 2:18 P.M.

FRANCES L. HODLWICK  
REGISTER OF DEEDS

Register of Deeds Stamp & File Number

4. Lot No. \_\_\_\_\_, Recorded Plat \_\_\_\_\_

5. Private Claims \_\_\_\_\_

SECTION

A	B	C	D	E	F	G	H	I	J	K	L	M
2	6	5	4	3	2	1						
3												
4	7	8	9	10	11	12						
5												
6	18	17	16	15	14	13						
7												
8	19	20	21	22	23	24						
9												
10	30	29	28	27	26	25						
11												
12	31	32	33	34	35	36						
13												

I, Russell L. Brown, in a field survey on Nov. 6, 1999 do hereby state that under requirements of P.A. 74, Michigan P.A. of 1970, the corner points mentioned in lines 1 and 2 above were in conformance with regulations and rules therefore as required in the current manual of survey instructions of the United States Department of the Interior, Bureau of Land Management or by a decree of a Court of Law and/or that the corner points mentioned in lines 3, 4, and 5 above were in conformance with the rules of the Michigan Board of Land Surveyors or by a Decree of a Court of Law; established, re-established, monumented, recovered, found as expressed below:

NOTE: Not more than 2 corners, all in the same town and range, may be recorded on this certificate.

A. Description of original monument and accessories and/or subsequent restoration:  
 1834 G.L.O. H. Parke D.S., Set Post Corner Sections 32 and 33 Elm 18 N73W 6, Lynn 10 N81E 4 1/2  
 County Surveyors Records - None  
 County Road Commission Records - None  
 L.C.R.C. - None  
 Recorded Surveys or Plats - 1927 Tip-O-Thumb Haven, Liber 3, Page 1, Huron County Records No object stated or accessories given. 10-20-80, Liber 4, Page 403 Huron Surveying, Inc. Russell L. Brown P.S. 24588 Found Concrete Monument, WITNESSES North 38.84' to Spike in Power Pole, West 49.0' to Spike in 6" Ash, S80°E 22.47' to Spike in 6" Ash  
 continued on page 2

B. Description of corner evidence found and/or method applied in restoring or reestablishing corner:  
No evidence of original Corner or accessories Found.

Found Concrete Monument in poor condition.

Replaced Monument with 1/2" x 18" Iron Capped P.S. 24588

Accepted as best evidence of original Corner Position

C. Description of monument for corner and accessories established to perpetuate locating the position of the corner:

E-13 S. Corner Section 32 and 33, T19N-R14E  
 Set 1/2" Dia. x 18" Re-Rod and capped P.S. 24588  
 WITNESSES  
 North 36.84' to Spike in West Side Power Pole  
 South 29.00' to Spike in West Side Utility Pole  
 West 49.60' to Spike in West Side of 14" Ash Tree  
 East 44.09' to 1/2" x 18" Steel Stake  
 East 2640.00' to F - 13, S. 1/4 Corner Section 33, T19N-R14E  
 West 2641.55' to D - 13, S. 1/4 Corner Section 32, T19N-R14E

Signed by Russell L. Brown  
 Surveyor's Michigan License No. 24588

Date Dec. 27, 1999

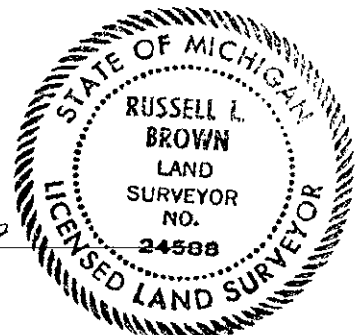

Peer group approved at meeting held 12-27-99, RLB

Re-Mon. Liber 2, Page 51

1999 REMONUMENTATION  
LAND CORNER RECORDATION CERTIFICATE  
Filing Requirement of Act 74, Mich. P.A. 1970

For Corners in PORT AUSTIN Township

<u>Huron</u> (County)	Located in:	Corner Code #
1. Public Land Survey	T 19N R 14E	E - 13
	T ----- R -----	
	T ----- R -----	
	T ----- R -----	
2. Property Controlling S in Section S	T ----- R -----	
	T ----- R -----	
3. Miscellaneous S Property in Sec. S	T ----- R -----	
	T ----- R -----	

STATE OF MICHIGAN  
HURON COUNTY  
RECORDED

30 DEC 99 2:18 P.M.

FRANCES L. HOLDWICK  
REGISTER OF DEEDS

Register of Deeds Stamp & File Number

4. Lot No. \_\_\_\_\_, Recorded Plat \_\_\_\_\_  
5. Private Claims \_\_\_\_\_

SECTION

1	A	B	C	D	E	F	G	H	I	J	K	L	M
2	6		5		4		3		2		1		
3													
4	7		8		9		10		11		12		
5													
6	18		17		16		15		14		13		
7													
8	19		20		21		22		23		24		
9													
10	30		29		28		27		26		25		
11													
12	31		32		33		34		35		36		
13													

I, Russell L. Brown, in a field survey on Nov. 1, 1999 do hereby state that under requirements of P.A. 74, Michigan P.A. of 1970, the corner points mentioned in lines 1 and 2 above were in conformance with regulations and rules therefore as required in the current manual of survey instructions of the United States Department of the Interior, Bureau of Land Management or by a decree of a Court of Law and/or that the corner points mentioned in lines 3, 4, and 5 above were in conformance with the rules of the Michigan Board of Land Surveyors or by a Decree of a Court of Law; established, re-established, monumented, recovered, found as expressed below:

NOTE: Not more than 2 corners, all in the same town and range, may be recorded on this certificate.

A. Description of original monument and accessories and/or subsequent restoration:  
 Unrecorded Surveys Dec. 1984 Huron Surveying, Inc. Russell L. Brown P.S. 24588  
 Found Concrete Monument.  
 March 20, 1991, Huron Surveying, Inc. Russell L. Brown P.S. 24588  
 No object state or accessories given  
 Dec. 5, 1995, and October 11, 1996, by Huron Surveying, Inc. Russell L. Brown P.S. 24588  
 No object stated, same accessories as survey recorded in liber 4 of surveys, Page 402, Huron County Records.

B. Description of corner evidence found and/or method applied in restoring or reestablishing corner:

See Sheet One

C. Description of monument for corner and accessories established to perpetuate locating the position of the corner:

See Sheet One

Signed by Russell L. Brown  
Surveyor's Michigan License No. 24588

Date Dec. 27, 1999

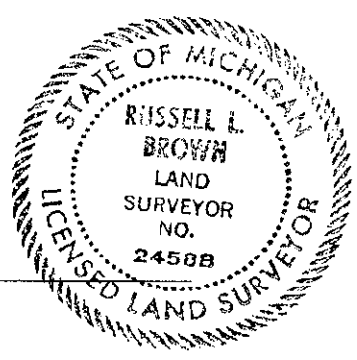

Peer group approved at meeting held 12-27-99. RLB