

Re-Mon. Liber 2, Page 53

1999 REMONUMENTATION
LAND CORNER RECORDATION CERTIFICATE
Filing Requirement of Act 74, Mich. P.A. 1970

For Corners in PORT AUSTIN Township

<u>Huron</u> (County)	Located in:	Corner Code #
1. Public Land Survey	T 19N R 14E	G - 13
	T-----R-----	
	T-----R-----	
	T-----R-----	
2. Property Controlling S in Section S	T-----R-----	
	T-----R-----	
3. Miscellaneous S Property in Sec. S	T-----R-----	
	T-----R-----	

STATE OF MICHIGAN
HURON COUNTY
RECORDED

30 DEC 99 2:19 P.M.

FRANCES L. HOLDWICK
REGISTER OF DEEDS

Register of Deeds Stamp & File Number

4. Lot No. _____, Recorded Plat _____
5. Private Claims _____

SECTION

1	A	B	C	D	E	F	G	H	I	J	K	L	M
2	6	5	4	3	2	1							
3													
4	7	8	9	10	11	12							
5													
6	18	17	16	15	14	13							
7													
8	19	20	21	22	23	24							
9													
10	30	29	28	27	26	25							
11													
12	31	32	33	34	35	36							
13													

I, Russell L. Brown, in a field survey on Dec. 6, 1999 do hereby state that under requirements of P.A. 74, Michigan P.A. of 1970, the corner points mentioned in lines 1 and 2 above were in conformance with regulations and rules therefore as required in the current manual of survey instructions of the United States Department of the Interior, Bureau of Land Management or by a decree of a Court of Law and/or that the corner points mentioned in lines 3, 4, and 5 above were in conformance with the rules of the Michigan Board of Land Surveyors or by a Decree of a Court of Law; established, re-established, monumented, recovered, found as expressed below:

NOTE: Not more than 2 corners, all in the same town and range, may be recorded on this certificate.

A. Description of original monument and accessories and/or subsequent restoration:
 1834 GLO H. Parke D.S. Set Post Corner Sections 33 and 34, Hemlock 8 N88 1/2E 14, Do. 8 N60W 14
 County Surveyors Records - None
 County Road Commission Records - None
 L.C.R.C. - None
 Recorded Surveys - None
 Unrecorded Surveys - None

B. Description of corner evidence found and/or method applied in restoring or reestablishing corner:
 No evidence of original corner or accessories Found.
 Set 1/2" x 18" Steel Stake capped P.S. 24588 G.L.O. measurement for corner F-13 as best evidence of original corner position.

C. Description of monument for corner and accessories established to perpetuate locating the position of the corner:
 G- 13, South Corner Sections 33 and 34, T19N-R14E,
 Set 1/2" x 18" Steel Stake capped P.S. 24588
 WITNESSES:
 N10°E 38.34' to Spike in West Side of 24" Maple
 S65°E 21.64' to Spike in North Side of 7" Maple
 S15°W 25.04' to Spike in West Side of 14" Maple
 N80°W 19.55' to Spike in South Side of 10" Maple
 East 2640.00 to H-13, South 1/4 Corner Section 34, T19N-R14E
 West 2640.00 to F- 13, South 1/4 Corner Section 33, T19N-R14E

Signed by Russell L. Brown
 Surveyor's Michigan License No. 24588

Date Dec 27, 1999

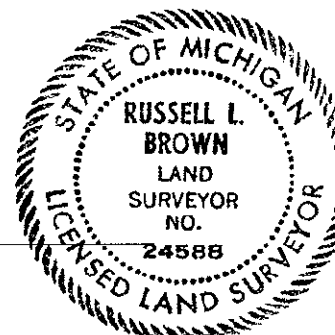

Peer group approved at meeting held 12-27-99, RLB.