

**LAND CORNER RECORDATION CERTIFICATE**  
**Filing Requirement of Act 74, Mich. P.A. 1970**

For corners in  
Hillsdale  
 (County)

Located In: Corner Code //

- |                                       |   |           |    |
|---------------------------------------|---|-----------|----|
| 1. Public Land Survey                 |   | T 5S R 1W | J7 |
|                                       |   | T 5S R 1W | K7 |
|                                       |   | T 5S R 1W | K8 |
|                                       |   | T         | R  |
| 2. Property Controlling in Section    | S | T         | R  |
|                                       | S | T         | R  |
| 3. Miscellaneous Property in Sec.     | S | T         | R  |
|                                       | S | T         | R  |
| 4. Lot No. _____, Recorded Plat _____ |   |           |    |
| 5. Private Claims _____               |   |           |    |

**Register of Deeds Stamp & File Number**

	A	B	C	D	E	F	G	H	I	J	K	L	M
2	6		5		4		3		2		1		
3													
4	7		8		9		10		11		12		
5													
6	18		17		16		15		14		13		
7													
8	19		20		21		22		23		24		
9													
10	30		29		28		27		26		25		
11													
12	31		32		33		34		35		36		
13													

I, Gary C. Bilow, in a field survey on October 04, 1991, 19\_\_\_\_, do hereby certify that under requirements of P.A. 74, Michigan P.A. of 1970, the corner points mentioned in lines 1 and 2 above were in conformance with regulations and rules therefore as required in the current manual of survey instructions of the United States Department of the Interior, Bureau of Land Management or by a decree of a Court of Law and/or that the corner points mentioned in lines 3, 4 and 5 above were in conformance with the rules of the Michigan Board of Land Surveyors or by a Decree of a Court of Law, established, re-established, monumented, re-monumented, recovered, found as expressed below:

**NOTE: Not more than 4 corners, all in the same town and range, may be recorded on this certificate.**

**A. Description of original monument and accessories and/or subsequent restoration:**

- J7: Post established by U.S. Deputy Surveyor R. Clark in 1824 - accessories: W. Oak 10", S69-1/2E 31 links and Water Beech 6". N83W 17 links. Corner recorded under Act 74, PA 1970 by K. Suydam, LLS #17636, in Liber 1, Page 527.  
 K7: Post established by U.S. Deputy Surveyor R. Clark in 1824 - accessories: W. Oak 16", N10W 10 links and B. Oak 18", S26-1/2W 47 links. Corner recorded under Act 74, PA 1970 by K. Suydam, LLS #17636, in Liber 1, Page 527.  
 K8: Corner established by U.S. Deputy Surveyor R. Clark in 1824 - accessories: W. Oak 16", N65E 21 links and B. Oak 18", S23W 35 links. Corner recorded under Act 74, PA 1970 BY A. Hatt, LLS #9208, in Liber 1, Page 291.

**B. Description of corner evidence found and/or method applied in restoring or reestablishing corner:**

- J7: Found 1/2" rebar and recovered one (1) of Suydam's accessories. Accepted rebar as the best evidence of the original GLO corner.  
 K7: Found 5/8" rebar and recovered no accessories. Accepted rebar as the best evidence of the original GLO corner.  
 K8: Found 1/2" rebar and recovered two (2) of Hatt's accessories. Accepted rebar as the best evidence of the original GLO corner.

**C. Description of monument for corner and accessories established to perpetuate locating the position of the corner:**

- |  |  |   |
|--|--|---|
| J7: Found 1/2" rebar 0.3' deep and 7' West of centerline of Brooks Road<br>S43W 25.22', nail & cap in 40" Maple<br>N86W 22.38', nail & cap in fence post<br>S51E 44.58', nail & tag in 12" Maple<br>N56E 41.10', nail & tag in 13" Hickory | K7: Found 5/8" rebar 2' East of centerline of Gordon Road<br>S24W 69.45', nail & tag in 16" Walnut<br>N81W 32.51', nail & tag in 32" Maple<br>N25W 66.75', nail & tag in 24" Maple<br>North 73', Centerline of driveway west | K8: Found 1/2" rebar 0.2' deep and 2' East of centerline of Gordon Road<br>N12E 96.81', nail & tag in 30" Walnut<br>S40W 21.51', nail & tag in twin 13" Walnut<br>S57E 37.08', nail & tag in 13" Walnut<br>N52E 46.48', nail & tag in 20" Hickory |
|--|--|---|

Signed by Gary C. Bilow  
 Surveyor's Michigan License No. 26453

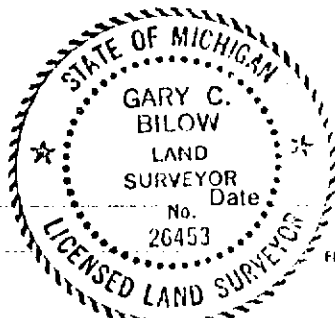

3/31/92