

ACCEPTED BY THE HILLSDALE COUNTY SURVEY PEER GROUP AS THE OFFICIAL CORNER UNDER MICHIGAN PUBLIC ACT 345 OF 1980 AT A MEETING HELD ON _____ AL RINGENBERG, CO. REC.

118407

LIBER 3 PAGE 137
 HILLSDALE COUNTY REMONUMENTATION
 LAND CORNER RECORDATION CERTIFICATE
 Filing Requirement of Act 74, Mich. P.A. 1970

RECORDED
 HILLSDALE CO. MICH.
 '96 DEC 20 AM 9 09

Judy VanZandt
 REG. OF DEEDS

For corners in

Hillsdale (County) Scipio Twp.	Located In:	Corner Code #
Public Land Survey	T <u>5S</u> R <u>3W</u>	<u>M-8</u>
	T _____ R _____	_____
	T _____ R _____	_____
	T _____ R _____	_____
Property Controlling in Section	S _____ T _____ R _____	_____
	S _____ T _____ R _____	_____
Miscellaneous Property in Sec.	S _____ T _____ R _____	_____

Lot No. _____, Recorded Plat _____
 Private Claims _____

Register of Deeds Stamp & File Number

	A	B	C	D	E	F	G	H	I	J	K	L	M
2	6		5		4		3		2		1		
3													
4	7		8		9		10		11		12		
5													
6	18		17		16		15		14		13		
7													
8	19		20		21		22		23		24		
9													
10	30		29		28		27		26		25		
11													
12	31		32		33		34		35		36		
13													

Frederick J. Cutcher, in a field survey on December 16, 1996, hereby certify that under requirements of P.A. 74, Michigan P.A. of 1970, the corner points mentioned in lines 1 and 2 above were in conformance with regulations and rules therefore as required in the current manual of survey instructions of the United States Department of the Interior, Bureau of Land Management or by a decree of a Court of Law and/or that the corner points mentioned in lines 3, 4 and 5 above were in conformance with the rules of the Michigan Board of Land Surveyors or by a Decree of a Court of Law; established, re-established, monumented, re-monumented, recovered, found as expressed below:

NOTE: Not more than 4 corners, all in the same town and range, may be recorded on this certificate.

A. Description of original monument and accessories and/or subsequent restoration:
 Original Government Survey by Clark, 1823: 12" W. Oak N. 73 1/2° W. 248 lks.; 6" W. Oak S. 4° W. 45 lks.

GLO proration places this corner 128 lks. (84.48') South of W. 1/4 post Sec. 19, Town 5 South, Range 2 West.

Survey #700 5-5-1875 by George Mark: Stone & brick; Sugar 5" N. 29 1/2° W. 70 lks.

B. Description of corner evidence found and/or method applied in restoring or reestablishing corner:

Any fence rows for Scipio or Moscow Twp. are now nonexistent. Traversed between M-7 & M-9 and set M-8 on line and half way between. (See sketch)

No witnesses remain.

SURVEY &
 REMONUMENTATION
 MAY 16 1997
 COMMISSION



C. Description of monument for corner and accessories established to perpetuate locating the position of the corner:

Set Hillsdale County remonumentation bar with cap in monument box and is accepted as the best available evidence of the position of the original corner.

3.4' West of centerline of Milnes Rd.
 In line with N. edge of field drive to West.
 N. & S. N.E. side 24" Twin Oak N. 63° W. 26.64'.
 N. & S. S.W. side 24" Oak S. 25° E. 69.88'.
 N. & S. S.E. side 42" Maple N. 25° E. 80.23'.
 Corner M-7 North 2652.18' & Cor. M-9 South 2652.18'.

Signed by Frederick J. Cutcher Date December 19, 1996
 Surveyor's Michigan License No. 24592

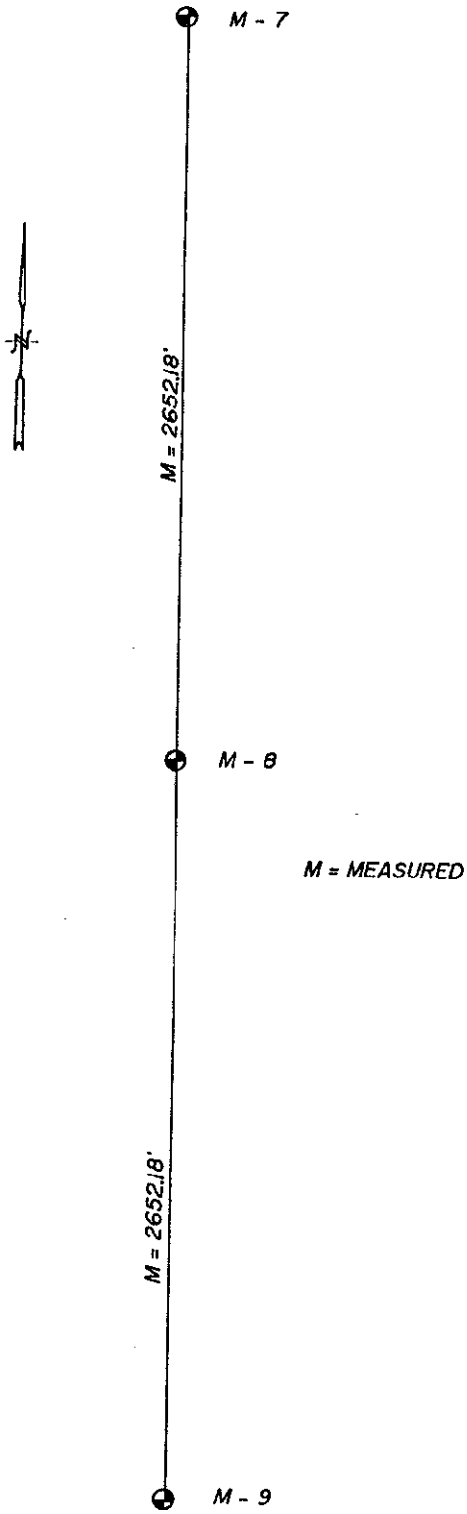

SURVEY &
REMONUMENTATION

MAY 1 6 1997

COMMISSION