

RECORDED  
HILLSDALE CO. MICH.

'94 NOV 28 AM 11 09

*Judy VanZandt*  
REG. OF DEEDS

ACCEPTED BY THE HILLSDALE COUNTY SURVEY PEER GROUP AS THE OFFICIAL CORNER UNDER MICHIGAN PUBLIC ACT 345 OF 1990 AT MEETING HELD ON 11-10-94  
AL RINGENBERG, CO. REP.

REMONUMENTATION

LAND CORNER RECORDATION CERTIFICATE

Filing Requirement of Act 74, Mich. P.A. 1970

For corners in

Hillsdale  
(County)

Located In:

Corner Code #

5S. 4W.

K-7

1. Public Land Survey

T \_\_\_ R \_\_\_

T \_\_\_ R \_\_\_

T \_\_\_ R \_\_\_

T \_\_\_ R \_\_\_

2. Property Controlling in Section

S \_\_\_ T \_\_\_ R \_\_\_

S \_\_\_ T \_\_\_ R \_\_\_

3. Miscellaneous Property in Sec.

S \_\_\_ T \_\_\_ R \_\_\_

S \_\_\_ T \_\_\_ R \_\_\_

SURVEY &  
REMONUMENTATION

APR 27 1995

Register of Deeds Stamp & File Number

COMMISSION

4. Lot No. \_\_\_\_\_, Recorded Plat \_\_\_\_\_

5. Private Claims \_\_\_\_\_

	A	B	C	D	E	F	G	H	I	J	K	L	M
2	6		5		4		3		2		1		
3													
4	7		8		9		10		11		12		
5													
6	18		17		16		15		14		13		
7													
8	19		20		21		22		23		24		
9													
10	30		29		28		27		26		25		
11													
12	31		32		33		34		35		36		
13													

I, Frederick J. Cutcher, in a field survey on October 26, 19 94

do hereby certify that under requirements of P.A. 74, Michigan P.A. of 1970, the corner points mentioned in lines 1 and 2 above were in conformance with regulations and rules therefore as required in the current manual of survey instructions of the United States Department of the Interior, Bureau of Land Management or by a decree of a Court of Law and/or that the corner points mentioned in lines 3, 4 and 5 above were in conformance with the rules of the Michigan Board of Land Surveyors or by a Decree of a Court of Law; established, re-established, monumented, re-monumented, recovered, found as expressed below:

NOTE: Not more than 4 corners, all in the same town and range, may be recorded on this certificate.

A. Description of original monument and accessories and/or subsequent restoration:

Survey #389, Jan. 29, 1858, R. Bullard, Co. Surveyor: Found stone, glass & brick; W. Oak 18" N. 45° 30' E., 70 links.

A.E. Ringenberg, June 7, 1974: Found 3/4" iron bar from M.S.H.D. witnesses.

B. Description of corner evidence found and/or method applied in restoring or reestablishing corner:

Found Harrison marker. 3/4" iron bar referred to was found in early 1980's by Bruce Leone and replaced by a Harrison marker. Found stone in hollow 8" diameter clay tile 24" below road surface. Harrison marker was directly over stone. Left stone & tile in place & angled 3/4"x36" County remonumentation bar over stone in monument box and is accepted as a careful and faithful perpetuation of the position of the original corner.

C. Description of monument for corner and accessories established to perpetuate locating the position of the corner:

3/4"x36" County remonumentation bar in monument box

In centerline intersection of roads

Road sign N. 41° W., 67.4'

Center Crimson Maple sapling (in yard) S. 30° E., 91.45'

Center 3" Blue Spruce (in yard) S. 60° E., 60.65'

N.E. corner sign post (M.W. Burns) S. 40° W., 84.72'

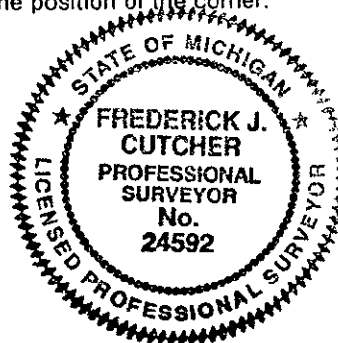

Signed by *Frederick J. Cutcher*

Date November 15, 1994

Surveyor's Michigan License No. 24592