

'98 DEC 4 AM 11 47

LIBER 3 PAGE 291

REMONUMENTATION
LAND CORNER RECORDATION CERTIFICATE
Filing Requirement of Act 74, Mich. P.A. 1970

ACCEPTED BY THE HILLSDALE COUNTY SURVEY PEER GROUP AS THE OFFICIAL CORNER UNDER MICHIGAN PUBLIC ACT 345 OF 1990, AT A MEETING HELD ON 10/19/98 AT AL. RINGENBERG, CO. REP.

Jeffrey VanZandt
REC. OF DEEDS
SURVEY &
REMONUMENTATION

FEB 23 1999

SECTION

Register of Deeds Stamp & File Number

For corners in

HILLSDALE
(County)

Located in:

Corner Code #

1. Public Land Survey

T 7S R 1W A-7
T R _____
T R _____
T R _____

2. Property Controlling in Section

S T R _____
S T R _____

3. Miscellaneous Property in Sec.

S T R _____
S T R _____

4. Lot No. _____, Recorded Plat _____

5. Private Claims _____

I, Jeffrey A. Bieszka, in a field survey on 25 Nov, 1998 do hereby state that under requirements of P.A. 74, Michigan P.A. of 1970, the corner points mentioned in lines 1 and 2 above were in conformance with regulations and rules therefore as required in the current manual of survey instructions of the United States Department of the Interior, Bureau of Land Management or by a decree of a Court of Law and/or that the corner points mentioned in lines 3, 4 and 5 above were in conformance with the rules of the Michigan Board of Land Surveyors or by a Decree of a Court of Law; established, re-established, monumented, recovered, found as expressed below:

NOTE: Not more than 2 corners, all in the same town and range, may be recorded on this certificate.

| | | | | | | | | | | | | | |
|----|---|----|---|----|---|----|---|----|---|----|---|----|---|
| 1 | A | B | C | D | E | F | G | H | I | J | K | L | M |
| 2 | | 6 | | 5 | | 4 | | 3 | | 2 | | 1 | |
| 3 | | | | | | | | | | | | | |
| 4 | | 7 | | 8 | | 9 | | 10 | | 11 | | 12 | |
| 5 | | | | | | | | | | | | | |
| 6 | | 18 | | 17 | | 16 | | 15 | | 14 | | 13 | |
| 7 | | | | | | | | | | | | | |
| 8 | | 19 | | 20 | | 21 | | 22 | | 23 | | 24 | |
| 9 | | | | | | | | | | | | | |
| 10 | | 30 | | 29 | | 28 | | 27 | | 26 | | 25 | |
| 11 | | | | | | | | | | | | | |
| 12 | | 31 | | 32 | | 33 | | 34 | | 35 | | 36 | |
| 13 | | | | | | | | | | | | | |

A. Description of original monument and accessories and/or subsequent restoration:

GLO Robert Clark

Post

9" Sugar S 86 E 75 lks

20" B. Oak N 77 W 8 lks

County Surveyor (Geo. A. Marks 1893)

Stake & Tile

16" Basswood N 31 E 10.5 lks

LCRC (John Hatt L 1, P 417)

Iron Pipe

B. Description of corner evidence found and/or method applied in restoring or reestablishing corner:

Found John Maxson capped iron in center of two fences going East-West, found some tile pieces around iron and in line with old fence to South. Accepted as the best available evidence to the position of the original corner.

C. Description of monument for corner and accessories established to perpetuate locating the position of the corner:

Set 5/8" x 36" iron

Nail & Tag 6" Elm N 05 W 7.27 ft.

Nail & Tag 24" Elm S 50 E 23.60 ft.

Nail & Tag 16" Elm South 20.78 ft.

Nail & Tag 14" Elm S 30 W 11.26 ft.

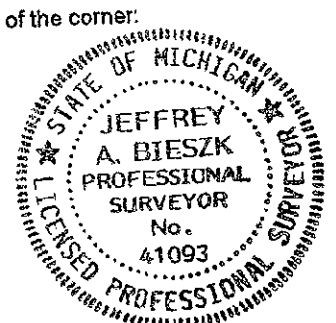

Signed by _____

Surveyor's Michigan License No. 41093

Date 4 December 1998