



REMONUMENTATION

LIBER 3 PAGE 334

LAND CORNER RECORDATION CERTIFICATE  
Filing Requirement of Act 74, Mich. P.A. 1970

025216

RECORDED  
HILLSDALE CO. MICH.

99 NOV 29 AM 9:16

*Jeffrey A. Bieszk*  
REG. OF DEEDS

Register of Deeds Stamp & File Number

For corners in

HILLSDALE

(County)

Located In:

Corner Code #

1. Public Land Survey

T	8S	R	2W	A-9
T		R		
T		R		
T		R		
S		T	R	
S		T	R	
S		T	R	
S		T	R	

2. Property Controlling in Section

3. Miscellaneous Property in Sec.

4. Lot No. \_\_\_\_\_, Recorded Plat \_\_\_\_\_

5. Private Claims \_\_\_\_\_

Jeffrey A. Bieszk in a field survey on 25 Oct., 1999 do hereby state that under requirements of P.A. 74, Michigan P.A. of 1970, the corner points mentioned in lines 1 and 2 above were in conformance with regulations and rules therefore as required in the current manual of survey instructions of the United States Department of the Interior, Bureau of Land Management or by a decree of a Court of Law and /or that the corner points mentioned in lines 3, 4 and 5 above were in conformance with the rules of the Michigan Board of Land Surveyors or by a Decree of a Court of Law; established, re-established, monumented, recovered, found as expressed below:

	A	B	C	D	E	F	G	H	I	J	K	L	M
1													
2	6		5		4		3		2		1		
3													
4	7		8		9		10		11		12		
5													
6	18		17		16		15		14		13		
7													
8	19		20		21		22		23		24		
9													
10	30		29		28		27		26		25		
11													
12	31		32		33		34		35		36		
13													

NOTE: Not more than 2 corners, all in the same town and range, may be recorded on this certificate.

A. Description of original monument and accessories and/or subsequent restoration:

GLO set by Wm. Brookfield. (1825)  
12" B. Ash S64E 19 lks.  
14" R. Oak N37E 68 lks.

Survey Donald Olmstead L1-P720  
Set iron

B. Description of corner evidence found and/or method applied in restoring or reestablishing corner:

Found R.R. Spike North side of pavement, from measurements match that of Olmstead's survey. Olmstead set corner from survey done by R.J. Caryell 1889 survey # 1082. Dug and found no other evidence, accepted as the best available evidence of the position of the original corner.

C. Description of monument for corner and accessories established to perpetuate locating the position of the corner:

Set 5/8" x 36" iron w/cap in Monument Box			
Stop Sign	N 10 W		50.29 ft.
Stop Sign	S 10 E		67.72 ft.
Nail w/tag Power Pole	N 75 E		82.56 ft.
Nail w/tag Power Pole	S 55 W		78.58 ft.

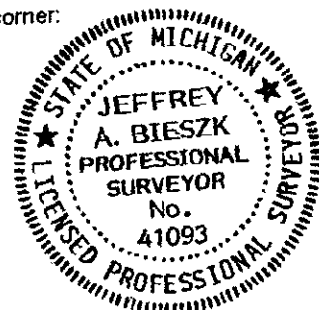

Signed by

*Jeffrey A. Bieszk*

Surveyor's Michigan License No.

41093

Date

24 November 1999