

'98 NOV 25 AM 9 59

LIBER 3 PAGE 273



HILLSDALE COUNTY REMONUMENTATION CORNER
LAND CORNER RECORDATION CERTIFICATE
Filing Requirement of Act 74, Mich. P.A. 1970

Jerry VanZandt
REC'D REEDS

For corners in

HILLSDALE COUNTY Located in: Corner Code #
WOODBIDGE TWP (County)

1. Public Land Survey T 8 S R 3 W I-6
T R
T R
T R

2. Property Controlling S T R
in Section S T R

3. Miscellaneous S T R
Property in Sec. S T R

SURVEY &
REMONUMENTATION

FEB 23 1999

SECTION

Register of Deeds Stamp & File Number

4. Lot No. _____, Recorded Plat _____

5. Private Claims _____

I, EDWARD W. REED, in a field survey on OCTOBER 24, 1998
do hereby state that under requirements of P.A. 74, Michigan P.A. of 1970, the corner points mentioned in lines 1 and 2 above were in conformance with regulations and rules therefore as required in the current manual of survey instructions of the United States Department of the Interior, Bureau of Land Management or by a decree of a Court of Law and /or that the corner points mentioned in lines 3, 4 and 5 above were in conformance with the rules of the Michigan Board of Land Surveyors or by a Decree of a Court of Law; established, re-established, monumented, recovered, found as expressed below:

NOTE: Not more than 2 corners, all in the same town and range, may be recorded on this certificate.

	A	B	C	D	E	F	G	H	I	J	K	L	M
1													
2	6		5		4		3		2		1		
3													
4	7		8		9		10		11		12		
5													
6	18		17		16		15		14		13		
7													
8	19		20		21		22		23		24		
9													
10	30		29		28		27		26		25		
11													
12	31		32		33		34		35		36		
13													

QUARTER CORNER COMMON TO SECTIONS 14 & 15

A. Description of original monument and accessories and/or subsequent restoration:

1825: GOVERNMENT SURVEY - CORNER SET
1873: R. BULLARD, CO SURVEYOR - STONE

B. Description of corner evidence found and/or method applied in restoring or reestablishing corner:

UNABLE TO LOCATE ANY EVIDENCE OF CORNER, MEASURED MIDWAY AND ON LINE BETWEEN SECTION CORNERS NORTH & SOUTH, POINT FELL EXACTLY ON LINE BETWEEN CORNER POST AND OLD FENCE LINES RUNNING EAST AND WEST

C. Description of monument for corner and accessories established to perpetuate locating the position of the corner:

SET 3/4" X 18" REBAR IRON WITH REMON CAP IN CI-MONUMENT BOX FLUSH WITH PAVED ROAD SURFACE

CENTER OF 3' FOUND CONC. CORNER POST	WEST	33.85'
IN LINE WITH FENCE LINE RUNNING WEST		
BASE OF OLD WOOD POST	EAST	26.64'
IN LINE WITH FENCE LINE RUNNING EAST		
WITNESS TAG IN NE SIDE 48" OAK	N 80 W	36.16'
WITNESS TAG IN W SIDE 8" MAPLE	S 76 E	28.76'
WITNESS TAG IN W SIDE 20" ASH	N 20 E	81.15'

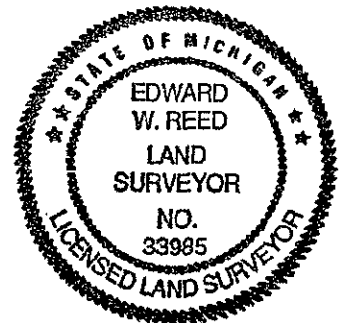

AND IS ACCEPTED AS THE BEST AVAILABLE EVIDENCE OF THE POSITION OF THE ORIGINAL CORNER.

Signed by *Edward W. Reed*
Surveyor's Michigan License No. 33985 EDWARD R. REED

Date NOVEMBER 9, 1998