

12017
 RECORDED
 HILLSDALE CO. MICH.
 '98 NOV 25 AM 9 59

ACCEPTED BY THE HILLSDALE COUNTY SURVEY PEER GROUP AS THE OFFICIAL CORNER UNDER MICHIGAN PUBLIC ACT 345 OF 1998. MEETING HELD ON 11-19-98 AT AL RINGENBERG, CO. REC.

LIBER 3 PAGE 276.

HILLSDALE COUNTY REMONUMENTATION CORNER
 LAND CORNER RECORDATION CERTIFICATE
 Filing Requirement of Act 74, Mich. P.A. 1970

Judy VanZandt
 REG. OF DEEDS

For corners in

HILLSDALE COUNTY
WOODBIDGE TWP (County)

Located In: Corner Code #

- 1. Public Land Survey T 8 S R 3 W K-7
- T R
- T R
- T R
- 2. Property Controlling in Section S T R
- S T R
- 3. Miscellaneous Property in Sec. S T R
- S T R

SURVEY &
 REMONUMENTATION

FEB 23 1999

SECTION

Register of Deeds Stamp & File Number

- 4. Lot No. _____, Recorded Plat _____
- 5. Private Claims _____

I, EDWARD W. REED, in a field survey on OCTOBER 24, 1998 do hereby state that under requirements of P.A. 74, Michigan P.A. of 1970, the corner points mentioned in lines 1 and 2 above were in conformance with regulations and rules therefore as required in the current manual of survey instructions of the United States Department of the Interior, Bureau of Land Management or by a decree of a Court of Law and /or that the corner points mentioned in lines 3, 4 and 5 above were in conformance with the rules of the Michigan Board of Land Surveyors or by a Decree of a Court of Law; established, re-established, monumented, recovered, found as expressed below:

	A	B	C	D	E	F	G	H	I	J	K	L	M
1													
2	6		5		4		3		2		1		
3													
4	7		8		9		10		11		12		
5													
6	18		17		16		15		14		13		
7													
8	19		20		21		22		23		24		
9													
10	30		29		28		27		26		25		
11													
12	31		32		33		34		35		36		
13													

NOTE: Not more than 2 corners, all in the same town and range, may be recorded on this certificate.

CORNER COMMON TO SECTIONS 13-14-23-24

A. Description of original monument and accessories and/or subsequent restoration:

- 1825: GOVERNMENT SURVEY - CORNER SET
- 1873: R. BULLARD - STONE
- 11-09-74: OLMSTEAD, SURVEYOR - COULD NOT FIND STONE, SET IRON PIPE USING FENCE LINES, C/L OF ROAD AND PRO RATED DISTANCE BETWEEN NE CORNER SECTION 14 & SE CORNER SECTION 23, RECORDED IN LCRC 5178
- 12-08-74: OLMSTEAD, SURVEYOR, RECORDED CORNER IN LCRC 5384

B. Description of corner evidence found and/or method applied in restoring or reestablishing corner:

FOUND 1/2" X 18" BOLT WITH SQUARE HEADED NUT ON TOP WITH FLAGGING
 NO OTHER EVIDENCE FOUND IN AREA

C. Description of monument for corner and accessories established to perpetuate locating the position of the corner:

SET 3/4" X 30" REBAR IRON ROD WITH REMON CAP IN CI-MONUMENT BOX 4" BELOW GRAVEL ROAD SURFACE

- TAG IN N SIDE POWER POLE S 60 E 186.45'
- 8" HICKORY S 72 E 87.00'
- TOP CENTER TEL PED S 55 W 38.3'
- TOP CENTER TEL PED N 34 E 57.2'
- FITS OLMSTEAD WITNESS OF 36" MAPLE (NOW STUMP) SW 40.13'

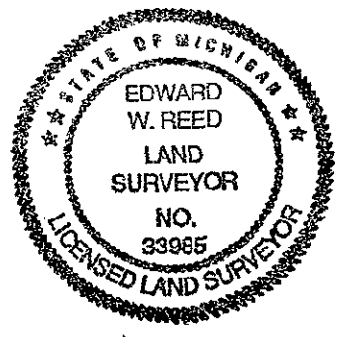

AND IS ACCEPTED AS THE BEST AVAILABLE EVIDENCE OF THE POSITION OF THE ORIGINAL CORNER.

Signed by *Edward W. Reed*
 Surveyor's Michigan License No. 33985 EDWARD R. REED

Date NOVEMBER 9, 1998