

SURVEY & REMONUMENTATION

LIBER 8 PAGE 315

FILED

Nov 22 11 48 AM '94

For corners in
INGHAM
(County)

APR 10 1995
COMMISSION
LAND CORNER RECORDATION CERTIFICATE
Filing Requirement of Act 74, Mich. P.A. 1970
BUNKER HILL

REGISTER OF DEEDS
Russell D. Johnson
INGHAM COUNTY, MICH.

1. Public Land Survey T IN R IE E-7
T R
T R
T R
2. Property Controlling S T R
In Section S T R
3. Miscellaneous S T R
Property In Sec. S T R
4. Lot No. _____, Recorded Plat _____
5. Private Claims _____

Register of Deeds Stamp & File Number

| | A | B | C | D | E | F | G | H | I | J | K | L | M |
|----|----|----|----|----|----|----|---|---|---|---|---|---|---|
| 2 | 6 | 5 | | | | | | | | | | | |
| 3 | | | | | | | | | | | | | |
| 4 | 7 | 8 | 9 | 10 | 11 | 12 | | | | | | | |
| 5 | | | | | | | | | | | | | |
| 6 | 18 | 17 | 16 | 15 | 14 | 13 | | | | | | | |
| 7 | | | | | | | | | | | | | |
| 8 | 19 | 20 | 21 | 22 | 23 | 24 | | | | | | | |
| 9 | | | | | | | | | | | | | |
| 10 | 30 | 29 | 28 | 27 | 26 | 25 | | | | | | | |
| 11 | | | | | | | | | | | | | |
| 12 | 31 | 32 | 33 | 34 | 35 | 36 | | | | | | | |
| 13 | | | | | | | | | | | | | |

I, **Maurice H. Mahieu**, in a field survey on **June 17,** 19**94**, do hereby certify that under requirements of P.A. 74, Michigan P.A. of 1970, the corner points mentioned in lines 1 and 2 above were in conformance with regulations and rules therefore as required in the current manual of survey instructions of the United States Department of the Interior, Bureau of Land Management or by a decree of a Court of Law and/or that the corner points mentioned in lines 3, 4 and 5 above were in conformance with the rules of the Michigan Board of Land Surveyors or by a Decree of a Court of Law; established, re-established, monumented, re-monumented, recovered, found as expressed below:

NOTE: Not more than 4 corners, all in the same town and range, may be recorded on this certificate.

- A. Description of original monument and accessories and/or subsequent restoration:
- Original GLO survey done by Joseph Wampler between January 30 and February 8, 1826. Set a post at the corner a distance of 80.00 chains, witnessed by:
W.O. 16" S 11° W 71
Elm 30" S 36° E 44
 - Referred to in survey by A. Jackson, County Surveyor, L-2, P-202 dated 5/15/1854. witnessed by: 16" W.O. S 11° W 68 1/2 L
30" Elm S 36° E 44 L

(Over)

- B. Description of corner evidence found and/or method applied in restoring or reestablishing corner:
- Found 1" Iron Pipe, 2 feet west of North-South fence line and 6.5 feet South of East-West drain. Found 4 of Ron Lester's witnesses (A-5). Accepted the position of 1" iron pipe as the perpetuation of corner and replaced 1" pipe with 3/4" x 24" iron rod with cap P.A. 345, P.S. #28414.

- C. Description of monument for corner and accessories established to perpetuate locating the position of the corner:

3/4" x 24" Iron Rod witnessed by:
Nail and Tag #28414 North Side 10" Pignut, N 87° W 10.13'
Nail and Tag #28414 East side 18" Oak, N 06° W 17.15'
Nail and Tag #28414 West side 18" Oak, S 02° W 25.87'
Nail and Tag #28414 North Side 8" Oak, S 50° E 12.10'

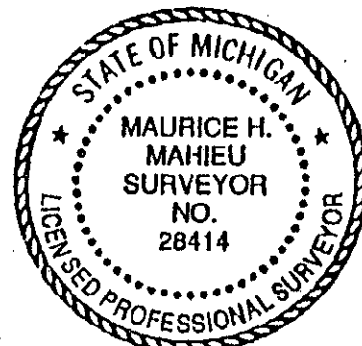

Signed by *Maurice H. Mahieu*
#28414
Surveyor's Michigan License No. _____

Date 11-14-94

FORM APPROVED BY MICHIGAN STATE BOARD OF LAND SURVEYORS, JAN. 28, 19
REVISED MAY 14, 19
REVISED JAN., 19

P.A. 345 INGHAM COUNTY
PEER APPROVED 11/9/94

A. (Continued)

3. Drain Survey notes from Ingham County Drain Commission for Dubois Drain and Mitchal Branch states: "Commencing 16.20 chains East of the Northwest Corner of Section 21 running thence on section line.... to the West lines of said lands to the section corner of Section 16, 17, 20 and 21. Thence on section line between the Southeast 1/4 of Section 17....."

No other reference given to section corner.

4. Marv Fouty R.S. #18999 in an Act 132 survey recorded in Liber 4, Page 613 called for a 1" pipe in B/slope of drain witnessed by a Nail and Tag East side 8" Oak, N 4° W 17.35 feet and a Nail and Tag North side 6" Poplar, N 86° W 6.65 feet. Survey was dated June 24, 1982.
5. Corner recorded and remonumented by Ronnie M. Lester, Land Surveyor #18998, in July 13, 1990 Act 74 corner Remonumentation (L-7, P-187). Found 1" pipe 6' South of centerline of drain as called for in survey by M. Fouty as recorded in Liber 4, Page 613. Corner falls 2' West of North-South fence line. Measured East 2645.4', South 2622.7', and Fouty indicates West 2636.2'. Witnessed by:
Nail and Tag North side of 12" Cottonwood, 290° Az, 6.0'
Nail and Tag South side of 12" Oak, 356° Az, 17.2'
Nail and Tag East side of 10" Oak, 358° Az, 25.6'
Nail and Tag North side of 8' Pignut, 273° Az, 10.2'
6. Corner referred to in July, 1990 Act 132 survey (L-6, P-311) by Ronnie Lester P.S. #18998 with same monumentation and witnesses as A-5.