

HEMONUM...

DEC 1 2 1997

COMMISSION

LAND CORNER RECORDATION CERTIFICATE  
Filing Requirement of Act 74, Mich. P.A. 1970

Liber 9 Page 300

For corners in

<u>INGHAM COUNTY</u> Leslie Township	Located In:	Corner Code #
1. Public Land Survey	T <u>1N</u> R <u>1W</u>	<u>K-2</u>
	T _____ R _____	_____
	T _____ R _____	_____
	T _____ R _____	_____
2. Property Controlling in Section	S _____ T _____ R _____	_____
	S _____ T _____ R _____	_____
3. Miscellaneous	S _____ T _____ R _____	_____
Property in Sec.	S _____ T _____ R _____	_____

**FILED**  
970047870  
12/03/1997 08:19:01  
REGISTER OF DEEDS  
Paula Johnson  
INGHAM COUNTY, MI

Register of Deeds Stamp & File Number

4. Lot No. \_\_\_\_\_, Recorded Plat \_\_\_\_\_  
5. Private Claims \_\_\_\_\_

I, Larry A. Bryan, in a field survey on October 7, 19 97 do hereby state that under requirements of P.A. 74, Michigan P.A. of 1970, the corner points mentioned in lines 1 and 2 above were in conformance with regulations and rules therefore as required in the current manual of survey instructions of the United States Department of the Interior, Bureau of Land Management or by a decree of a Court of Law and /or that the corner points mentioned in lines 3, 4 and 5 above were in conformance with the rules of the Michigan Board of Land Surveyors or by a Decree of a Court of Law; established, re-established; monumented, recovered, found as expressed below:

NOTE: Not more than 2 corners, all in the same town and range, may be recorded on this certificate.

A. Description of original monument and accessories and/or subsequent restoration:

1). 02-17-1826: U. S. Public Land Survey Field Notes, Deputy Surveyor Hervey Parke states "40.00 ch., Set 1/4 Sec. Post from which: W. Oak 22" S82W 76 lks. and W. Oak 16 East 14 lks."

2). 05-06-1896: Record of Surveys, Vol. 4, Page 4, County Surveyor W. A. Rowe states that he found "old post" and set "brick and gas pipe from which B. Cherry 16" South 49-1/2 lks. and W. Oak 14" N59-3/4W 68 lks."

3). 10-10-1972: Land Corner Recordation Certificate (Rec. 7-28-78, L4-P263), R. W. Steadman, P.S. 11370 notes "Dug hole in Vaughn Road opposite fenceline and found an old shovel with pieces of brick scattered through the surrounding soil; raised location of shovel to surface with 1/2" iron pipe; 14" Wild Cherry N.N.W. 25.23', 40" Catalpa N.E. 40.76', Wood Anchor Post South 36.89'."

(Continued on back)

B. Description of corner evidence found and/or method applied in restoring or reestablishing corner:

3" below the surface and 1' North of the centerline of Vaughn Road, and opposite fence and tree lines North and South, found concrete monument in concrete collar.

C. Description of monument for corner and accessories established to perpetuate locating the position of the corner:

Installed cap stamped "P.A. 345 PS 25832" on concrete monument, placed iron rings with cover on collar, and took the following witnesses (bearings are magnetic):

- Found nail and tag 25832 in East side Fence Post S03°W 25.32'
- Found nail and tag 25832 in West side 18" Elm N04°E 29.20'
- Found nail and tag 25832 in Southwest side 16" Elm N52°W 41.52'
- Found nail and tag 28409 (R. L. Enger, P.S.) in Southeast side 60" Catalpa N52°E 40.82'

	A	B	C	D	E	F	G	H	I	J	K	L	M
1													
2	6		5		4		3		2		1		
3													
4	7		8		9		10		11		12		
5													
6	18		17		16		15		14		13		
7													
8	19		20		21		22		23		24		
9													
10	30		29		28		27		26		25		
11													
12	31		32		33		34		35		36		
13													

Signed by Larry A. Bryan

Date October 24, 1997

Surveyor's Michigan License No. 25832

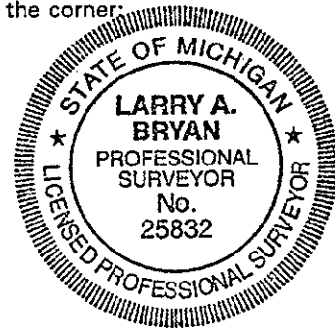

P.A. 345 INGHAM COUNTY  
PEER APPROVED: 10/30/97 *me*

## Part A - Continued

- 4). 08-18-1978: Land Corner Recordation Certificate (Rec. 9-13-78, L4-P347), R. M. Lester, P.S. 18998 notes "Excavated hole 5.7' X 4.5' to an average depth of 3' on centerline of Vaughn Road and on extended fence/tree line to the south. Found 1/2" X 18" iron pipe with cap #11370, 6" below road surface. Found old square shovel blade with broken brick at blade base, adjacent to 1/2" iron pipe and located on the centerline of Vaughn Road and on extended fence/tree line to the South. Accepted shovel blade as corner described by W. A. Rowe in survey noted above and as monumentation recorded by Richard W. Steadman, R.L.S. 11370, in Corner Recordation Certificate, L.4, P. 263, July 19, 1978. Excavation conducted by Ingham County Survey and Remonumentation Project crew. Set 4" X 36" concrete monument with 1/2" X 38" rerod, cap #18998 with concrete collar and cover in location of shovel blade described above; nail and tag #18998 west side 6" Twin Elm North 29.44', nail and tag #18898 south side 6" Elm NW 41.38', nail and tag #18998 southeast side 40" Catalpa NE 40.81', found nail and tag #11370 east side 6" Anchor Post South 25.23'."
- 5). 06-06-1986: Certified Survey Map (Rec. 06-23-86, L4-P1253), G. M. Young, P.S. 17640 notes the monument and witnesses given in Item 4 above. The drawing shows a distance of 2669.78 feet to J-2.
- 6). 05-11-1990: Certified Survey Map (Rec. 11-20-90, L6-P548), Ron Helsel, P.S. 18994 notes "Found 1/2" pipe" and lists the witnesses given in Item 3 above. The drawing shows a distance of 2647.91 feet to K-1.
- 7). 03-20-1991: Certified Survey Map (Rec. 12-09-91, L6-P895), Ron Helsel, notes " Found 4" X 36" conc. mon.; N & T #18998 W side 6" Twin Elm North 29.44'; N & T #18998 South side 6" Elm NW 41.38', N & T #18998 SE side 40" Catalpa NE 40.81', N & T #11370 East side 6" Anchor Post South 25.23'; Recorded L-4, PG-347." The drawing shows a distance of 2669.98 feet to J-2.
- 8). 08-04-1994: Private Records, Survey No. 94-B-45979, L. A. Bryan, notes "Found 1/2" bar in C/L of Vaughn Rd. on fence North & South; found nail & tag East side Fence Post South 25.23', Set nail and tag West side 18" Elm North 29.44', set nail & tag Southwest side 16" Elm N55°W 41.38', set nail & tag Southwest side 12" Catalpa S50°E 31.96'." The drawing shows distances of 2669.81 feet to J-2 and 2662.26 feet to K-3.
- 9). 09-19-1996: Certified Survey Map (Rec. 11-22-96, L7-P940), M. H. Mahieu, P.S. 28414 calls for the E. 1/4 Corner of Section 2, T1N, R1W, but gives no monument description nor witnesses. The drawing shows a distance of 2670.00 feet to J-2.