

SURVEY & REMONUMENTATION

APR 10 1995

LAND CORNER RECORDATION CERTIFICATE
Filing Requirement of Act 74, Mich. P.A. 1970

DEC 1 10 05 AM '94

For corners in

INGHAM

(County)

ONONDAGA TOWNSHIP

Located In:

Corner Code #

- 1. Public Land Survey T 1N R 2W K-11
- T _____ R _____
- T _____ R _____
- T _____ R _____
- 2. Property Controlling S _____ T _____ R _____
- in Section S _____ T _____ R _____
- 3. Miscellaneous S _____ T _____ R _____
- Property in Sec. S _____ T _____ R _____

REGISTER OF DEEDS
Ronald D. Enger
INGHAM COUNTY, MICH.

Register of Deeds Stamp & File Number

- 4. Lot No. _____, Recorded Plat _____
- 5. Private Claims _____

	A	B	C	D	E	F	G	H	I	J	K	L	M
2	6		5		4		3		2		1		
3													
4	7		8		9		10		11		12		
5													
6	16		17		18		19		20		21		22
7													
8	19		20		21		22		23		24		
9													
10	30		29		28		27		26		25		
11													
12	31		32		33		34		35		36		
13													

I, RONALD L. ENGER, in a field survey on AUGUST 23, 19 94

do hereby certify that under requirements of P.A. 74, Michigan P.A. of 1970, the corner points mentioned in lines 1 and 2 above were in conformance with regulations and rules therefore as required in the current manual of survey instructions of the United States Department of the Interior, Bureau of Land Management or by a decree of a Court of Law and/or that the corner points mentioned in lines 3, 4 and 5 above were in conformance with the rules of the Michigan Board of Land Surveyors or by a Decree of a Court of Law; established, re-established, monumented, re-monumented, recovered, found as expressed below:

NOTE: Not more than 4 corners, all in the same town and range, may be recorded on this certificate.

A. Description of original monument and accessories and/or subsequent restoration:

- 1. ORIGINAL POST SET BY HERVEY PARKE, DEPUTY SURVEYOR, ON DEC. 26, 1825.
ELM 16 N1W 12 (7.9')
DO. 9 S12W 26 (17.2')

- 2. A. JACKSON, CO. SURVEYOR, USED CORNER IN OCT., 1839 (VOL 1, PAGE 18) WITH SAME MON. AND WITNESSES AS ITEM 1.

CONTINUED ON BACK

B. Description of corner evidence found and/or method applied in restoring or reestablishing corner:

SEARCHED AT APPARENT LOCATION OF CORNER AND FOUND 1/2" BAR IN MONUMENT BOX ON CENTERLINE OLDS ROAD AND FENCE LINE TO SOUTH. PROVED BAR TO BE IN THE POSITION RECORDED BY L. BRYAN IN MAR. 1988 AND USED BY B. ANTCLIFF IN NOV. 1988 BY THE EXISTENCE OF ALL OF THEIR WITNESSES. PULLED BAR AND EXCAVATED THROUGH BOTTOM OF BOX AND FOUND NOTHING MORE. TIED OCCUPATION AT 1/16 CORNER IMMEDIATELY ADJACENT TO NORTH AND COMPARED IT TO LOCATION OF 1/4 CORNER TO NORTH AND FOUND THAT OCCUPATION IS AT EXACT SPLIT OF DISTANCE. ACCEPTED BAR AS PERPETUATION OF CORNER BECAUSE OF AGREEMENT WITH EXISTING OCCUPATION AND REPLACED BAR WITH STANDARD BAR AND PA 345 CAP. MEASURED NORTH 2628.06 TO K-10. MEASURED WEST 2640.56 TO J-11. MEASUREMENTS ARE FROM TRAVERSE DURING SUPER COLLIDER PROJECT OF 1988.

C. Description of monument for corner and accessories established to perpetuate localing the position of the corner:

K-11 T1N R2W
3/4" X 24" SMOOTH STEEL BAR WITH PA 345 CAP PS 28409 IN MON BOX ON CENTERLINE OLDS ROAD ON FENCE LINE TO SOUTH
NAIL & TAG 18998 (R. LESTER) IN NORTH SIDE TRIPLE 10" OAK NAZ 116° 74.09'
BOTTOM STEEL ANCHOR POST NAZ 183° 28.55'
NAIL & TAG 25832 IN SOUTH SIDE 24" MAPLE NAZ 294° 77.89'
NAIL & TAG 28414 IN SW SIDE 28" MAPLE NAZ 322° 34.45'

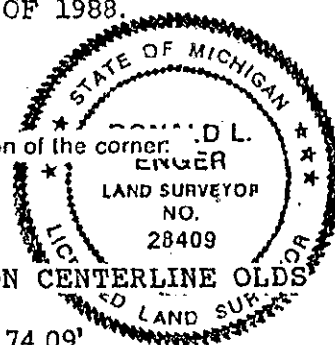

Signed by Ronald L. Enger

Date OCTOBER 31, 1994

Surveyor's Michigan License No. 28409

2762

P.A. 345 INGHAM COUNTY
PEER APPROVED 11/09/94 M

3. A. JACKSON USED CORNER IN NOV., 1852 (VOL. 2, PAGE 124) WITH SAME MONUMENT AND WITNESSES AS IN ITEMS 1 & 2.
4. FRED WHITE, LS 12034, RECORDED CORNER IN NOVEMBER 1972 (LIBER 2 OF CORNERS, PAGE 205)
"FD. $\frac{1}{4}$ " IRON ROD (VERIFIED BY ADJOINING CORNERS AND PROPERTY LINES"
6" TRIPLE ASH SOUTH 33.92'
ANC. POST NORTH 28.59'
24" MAPLE N55°30'W 34.85'
5. A. WILLIAMS, LS 21265, USED CORNER IN MARCH 1979, (LIBER 3 OF SURVEYS, PAGE 961) WITH SAME MONUMENT AND WITNESSES AS ITEM 4.
6. LARRY BRYAN, LS 25832, RECORDED CORNER IN MARCH 1988 (LIBER 6 OF CORNERS, PAGE 363) AS " FOUND 60"D" NAIL IN PICK HOLE IN CENTERLINE OLDS RD. ON FENCE LINE SOUTH FROM LONE REMAINING WITNESS FROM LIBER 2, PAGE 205. RESET $\frac{1}{2}$ " BAR AND CAP AT LOCATION OF NAIL".
 $\frac{1}{2}$ " BAR AND CAP
FD. NAIL IN SW SIDE 24" MAPLE N45°W 34.85'
SET NAIL AND TAG IN S. SIDE 20" MAPLE N70°W 77.84'
NW CORNER ANGLE IRON ANC. POST SOUTH 28.70'
7. BRUCE ANTCLIFF, LS 25826, USED CORNER IN NOVEMBER 1988 (LIBER 5 OF SURVEYS, PAGES 968-975).
 $\frac{1}{2}$ " IRON BAR
N40W NAIL IN 30" MAPLE 34.90'
N68W NAIL IN 24" MAPLE 77.80'
S02W ANGLE IRON POST 28.80'
S56E NAIL IN 24" OAK 74.00'