

SURVEY & REMONUMENTATION

DEC 17 1998

Liber 9 Page 372

LAND CORNER RECORDATION CERTIFICATE
Filing Requirement of Act 74, Mich. P.A. 1970

FILED

980053104
10/19/1998 13:55:02
REGISTER OF DEEDS
Paula Johnson
INGHAM COUNTY, MI

For corners in **SECTION**

INGHAM

Located In:

Corner Code #

INGHAM (Twp)

1. Public Land Survey

T 2N R 1E K-10
T _____ R _____
T _____ R _____
T _____ R _____

2. Property Controlling in Section

S _____ T _____ R _____
S _____ T _____ R _____

3. Miscellaneous Property in Sec.

S _____ T _____ R _____
S _____ T _____ R _____

Register of Deeds Stamp & File Number

4. Lot No. _____, Recorded Plat _____
5. Private Claims _____

I, DAVID R. LOHR, in a field survey on 9/21, 19 98 do hereby state that under requirements of P.A. 74, Michigan P.A. of 1970, the corner points mentioned in lines 1 and 2 above were in conformance with regulations and rules therefore as required in the current manual of survey instructions of the United States Department of the Interior, Bureau of Land Management or by a decree of a Court of Law and /or that the corner points mentioned in lines 3, 4 and 5 above were in conformance with the rules of the Michigan Board of Land Surveyors or by a Decree of a Court of Law; established, re-established, monumented, recovered, found as expressed below:

NOTE: Not more than 2 corners, all in the same town and range, may be recorded on this certificate.

| | A | B | C | D | E | F | G | H | I | J | K | L | M |
|----|---|----|---|----|---|----|---|----|---|----|---|----|---|
| 1 | | | | | | | | | | | | | |
| 2 | | 6 | | 5 | | 4 | | 3 | | 2 | | 1 | |
| 3 | | | | | | | | | | | | | |
| 4 | | 7 | | 8 | | 9 | | 10 | | 11 | | 12 | |
| 5 | | | | | | | | | | | | | |
| 6 | | 18 | | 17 | | 16 | | 15 | | 14 | | 13 | |
| 7 | | | | | | | | | | | | | |
| 8 | | 19 | | 20 | | 21 | | 22 | | 23 | | 24 | |
| 9 | | | | | | | | | | | | | |
| 10 | | 30 | | 29 | | 28 | | 27 | | 26 | | 25 | |
| 11 | | | | | | | | | | | | | |
| 12 | | 31 | | 32 | | 33 | | 34 | | 35 | | 36 | |
| 13 | | | | | | | | | | | | | |

A. Description of original monument and accessories and/or subsequent restoration:

K-10: 1)POST SET BY J. WAMPLER, DEP. SURVEYOR IN FEB. 1826;
"SET QR P FW" BO 21" N89E 41 LKS (27.06')
WO 16" S34E 24 LKS (15.84')
GLO NOTES SHOW DISTANCE NORTH & SOUTH OF 40 CH.(2640.00')
CONTINUED ON BACK

B. Description of corner evidence found and/or method applied in restoring or reestablishing corner:

K-10: SEARCHED AT APPARENT LOCATION OF CORNER AND FOUND R.R. SPIKE IN CENTERLINE OF DEXTER TRAIL AS PER MY SURVEY RECORDED IN LIBER 7, PAGE 717. CORNER FALLS ON FENCE TO WEST. NO OCCUPATION EXISTS EAST OF THIS CORNER. EXCAVATED 2 FT. X 2 FT. AREA AROUND R.R. SPIKE THRU THREE LAYERS OF BIT. TO TOTAL DEPTH OF 10". EXCAVATED THRU 36" OF SAND FILL TO ORIGINAL CLAY SOIL AND HIT LARGE STONE AT DEPTH OF 42".
CONTINUED ON BACK

C. Description of monument for corner and accessories established to perpetuate locating the position of the corner:

K-10: SET 3/4" X 24" STANDARD REMON. BAR AND 2" ALUMINUM PA#345 CAP STAMPED #30090 OVER LARGE STONE AT LOCATION OF R.R. SPIKE AS SET BY SURVEYOR BOSS IN 1972. WITNESSED BY:

- FD. N&T #17640, W/S UTILITY POLE, N 30 E, 98.66'
- FD. N&T #17640, N/S 28" WALNUT, WEST, 25.15'
- FD. N&T #17640, W/S 18" ELM, S 30 E, 63.48'
- FD. N&T #17640, W/S WOOD POST, N 20 E, 96.78'
- SET N&T #30090, E/S 12" WALNUT, S 20 W, 80.16'
- SET N&T #30090, E/S 10" WALNUT, S 20 W, 101.57'



Signed by David R. Lohr
Surveyor's Michigan License No. 30090

Date 9-24-98

P.A. 345 INGHAM COUNTY
PEER APPROVED 9/22/98 M

DEC 17 1998

Liber 9 Page 373

SECTION

K-10: INGHAM TOWNSHIP, PART A CONTINUED:

- 2) CORNER REFERENCED IN COUNTY SURVEYORS RECORDS, BOOK 4, PG. 132, OLD VOL. 1, PAGE 135, BY A. JACKSON, CO. SURVEYOR, DATED NOV. 23, 1838. NO MENTION OF MONUMENT. WITNESSED BY: SAME AS ITEM #1.
SURVEY SHOWS DISTANCE NORTH OF 158 RODS, 10 LKS (2613.60')
SURVEY SHOWS DISTANCE EAST OF 158 RODS, 8 LKS (2612.28')
- 3) CORNER REFERENCED IN COUNTY SURVEYORS RECORDS, FOLDER. 1, PAGE 60, BY A. JACKSON, CO. SURVEYOR, DATED NOV. 23, 1838. NO MENTION OF MONUMENT. WITNESSED BY: SAME AS ITEM #1.
SURVEY SHOWS DISTANCE EAST OF 39.58 CH. (2612.28')
SURVEY SHOWS DISTANCE NORTH OF 39.60 CH., (2613.60')
- 4) CORNER REFERENCED IN COUNTY SURVEYORS RECORDS, FOLDER. 1, PAGE 61, BY A. JACKSON, CO. SURVEYOR, DATED NOV. 27, 1838. NO MENTION OF MONUMENT. WITNESSED BY: SAME AS ITEM #1
SURVEY SHOWS DISTANCE WEST TO 1/8 COR. OF 20.00 CH. (1320.00')
SURVEY SHOWS DISTANCE NORTH OF 39.60 CH., (2613.60')
- 5) CORNER NOT REFERENCED ON INGHAM COUNTY ROAD COMMISSION MAP DATED JANUARY 1969.
- 6) CORNER REFERENCED IN SURVEY BY OSCAR BOSS, P.S. #13574, DATED 8/17/72 AND RECORDED IN LIBER 1, PAGE 557. "SET R. R. SPIKE:"
WITNESSED BY: N 40E -98.72' SPIKE W. SIDE UTILITY POLE
SOUTH - 24.83' - SPIKE N. SIDE 14" TREE (???)
S 30 W. - 63.59' - SPIKE E. SIDE 8" TREE
SURVEY SHOWS DISTANCE WEST TO J-10 OF 2646.38'
- 7) LCRC BY OSCAR BOSS, PS #13574, DATED 8-23-72, RECORDED IN LIBER 2, PAGE 61 SHOWS SAME DATA AS ITEM # 6.
- 8) LCRC BY GEORGE M. YOUNG, PS #17640, DATED 6-24-85, RECORDED IN LIBER 6, PAGE 298. STATES: "FOUND OLD ANCHOR POST AT NORTH, SOUTH AND EAST FENCE INTERSECTIONS, SET 1/2" IRON AND CAP IN CENTER OF ANCHOR POST"
WITNESSED BY: NAIL & TAG, SOUTH SIDE 12" OAK, SW, 23.20'
NAIL & TAG, WEST SIDE 12" OAK, SOUTH, 9.75'
NAIL & TAG, WEST SIDE 6" POPLAR, SE, 19.85'
NAIL & TAG, WEST SIDE 10" OAK, NE, 13.70'
THIS LCRC IS APPARENTLY MIS-LABLED AS K-10 FALLS IN ROADWAY AND NOT AT AN ANCHOR POST LOCATION.

CONTINUED ON PAGE #3:



K-10 INGHAM TOWNSHIP PART A CONTINUED PAGE 3

9) CORNER REFERENCED IN SURVEY BY MAURICE H. MAHIEU, P.S. #28414, DATED 8/24/89 AND RECORDED IN LIBER 5, PAGE 1223. NO MENTION OF MONUMENT. WITNESSED BY: N&T #17640, W. FACE UTILITY POLE, N30E, 98.66' N&T #17640, N. FACE 28" WALNUT, WEST 25.15' N&T #17640, W. FACE 18" ELM, S30E, 63.48' N&T #17640, W. FACE WOOD POST, N20E, 96.78' SURVEY SHOWS DISTANCE WEST TO J-10 OF 2646.11'

10) CORNER REFERENCED IN UNRECORDED SURVEY, JOB #8128, BY AUSTIN C. WILLIAMS, P.S. #21275, DATED OCTOBER 1989. NO MENTION OF MONUMENT. WITNESSED BY: NAIL & TAG, 12" ELM S/S, N75E, 34.32' NAIL & TAG, 14" ELM N/S, N88-30E, 35.63' NAIL & TAG, 16" BEECH E/S, SOUTH 15.59'

11) CORNER REFERENCED IN SURVEY BY MAURICE H. MAHIEU, P.S. #28414, DATED 7/08/92 AND RECORDED IN LIBER 6, PAGE 1033. "FOUND R.R. SPIKE"; WITNESSED BY: N&T #17640, W. SIDE UTILITY POLE, N 30 E, 98.66' N&T #17640, N. SIDE 28" WALNUT, WEST, 25.15' N&T #17640, W. SIDE 18" ELM, S 30 E, 63.48' N&T #17640, W. SIDE WOOD POST, N 20 E, 96.78' SURVEY SHOWS DISTANCE NORTH TO K-9 OF 2652.05' SURVEY SHOWS DISTANCE WEST TO J-10 OF 2646.26'

12) CORNER REFERENCED IN SURVEY BY MAURICE H. MAHIEU, P.S. #28414, DATED 4/27/93 AND RECORDED IN LIBER 6, PAGE 1245. "FOUND R.R. SPIKE"; WITNESSED BY N&T #17640, W. SIDE UTILITY POLE, N 30 E, 98.66' N&T #17640, N. SIDE 28" WALNUT, WEST, 25.15' N&T #17640, W. SIDE 18" ELM, S 30 E, 63.48' N&T #17640, W. SIDE WOOD POST, N 20 E, 96.78' SURVEY SHOWS DISTANCE WEST TO J-10 OF 2646.26'

13) CORNER REFERENCED IN SERIES OF SURVEYS BY DAVID R. LOHR, P.S. #30090, DATED 5/07/93, RECORDED LIBER 7, PAGE 214, 5/21/93, RECORDED LIBER 7, PAGE 215, 10/25/93, RECORDED LIBER 7, PAGE 230, 4/24/95, RECORDED LIBER 7, PAGE 717, AND "FOUND R.R. SPIKE"; SAME WITNESSES AS ITEM #12. THESE SURVEYS ARE RESURVEYS OF VARIOUS PARCELS CREATED BY SURVEYOR WILLIAMS VIA HIS UNRECORDED SURVEY OF OCTOBER 1989 (ITEM #10). THESE SURVEYS WERE PERFORMED TO CORRECT GROSS ERRORS IN THE LOCATION OF PROPERTY CORNERS AS SET BY SURVEYOR WILLIAMS. SURVEYS SHOW DISTANCE WEST TO J-10 OF 2646.66' SURVEYS SHOW DISTANCE SOUTH TO K-11 OF 2639.79'

14) CORNER REFERENCED IN TRAVERSE FIELD NOTES BY SURVEYOR RON HELSEL, DATED 10/25/94. THIS TRAVERSE WAS PERFORMED TO DETERMINE THE LOCATION OF L-10. NO REFERENCE TO CORNER MONUMENT, NO WITNESSES GIVEN. TRAVERSE NOTES SHOW DISTANCE TO L-10 OF 2626.03FT.

15) NO OTHER REFERENCES FOUND

SURVEY & REMONUMENTATION
DEC 17 1998
SECTION

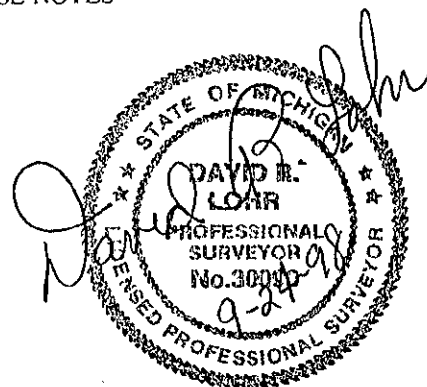

K-10: INGHAM TOWNSHIP, PART B CONTINUED

COULD NOT BUDGE STONE. RAILROAD SPIKE LOCATION FALLS OVER TOP OF STONE. ACCEPTED LOCATION OF SPIKE AS FAITHFUL PERPETUATION OF CORNER AND SET 3/4" X 24" STANDARD REMON. BAR AND 2" ALUMINUM PA #345 CAP STAMPED #30090 IN MONUMENT BOX LOCATION OF R.R. SPIKE AS SET BY SURVEYOR BOSS IN 1972.