

DEC 14 1993

COMMISSION LAND CORNER RECORDATION CERTIFICATE
Filing Requirement of Act 74, Mich. P.A. 1970

LIBER 8 CALL 36

FILED

For corners in

| | | |
|------------------------------------|-------------------------|-----------------|
| <u>INGHAM</u> (County) | Located In: | Corner Code: // |
| 1. Public Land Survey | T <u>3N</u> R <u>1E</u> | <u>I-9</u> |
| | T _____ R _____ | _____ |
| | T _____ R _____ | _____ |
| | T _____ R _____ | _____ |
| 2. Property Controlling in Section | S _____ T _____ R _____ | _____ |
| | S _____ T _____ R _____ | _____ |
| 3. Miscellaneous Property in Sec. | S _____ T _____ R _____ | _____ |
| | S _____ T _____ R _____ | _____ |

Nov 24 9 02 AM '93

REGISTER OF DEEDS
Russell J. ...
INGHAM COUNTY, MICH.

Register of Deeds Stamp & File Number

4. Lot No. _____, Recorded Plat _____
5. Private Claims _____

WHEATFIELD

| A | B | C | D | E | F | G | H | I | J | K | L | M |
|----|----|----|----|----|----|----|---|---|---|---|---|---|
| 2 | 6 | 5 | 4 | 3 | 2 | 1 | | | | | | |
| 3 | | | | | | | | | | | | |
| 4 | 7 | 8 | 9 | 10 | 11 | 12 | | | | | | |
| 5 | | | | | | | | | | | | |
| 6 | 18 | 17 | 16 | 15 | 14 | 13 | | | | | | |
| 7 | | | | | | | | | | | | |
| 8 | 19 | 20 | 21 | 22 | 23 | 24 | | | | | | |
| 9 | | | | | | | | | | | | |
| 10 | 30 | 29 | 28 | 27 | 26 | 25 | | | | | | |
| 11 | | | | | | | | | | | | |
| 12 | 31 | 32 | 33 | 34 | 35 | 36 | | | | | | |
| 13 | | | | | | | | | | | | |

I, MAURICE H. MAHIEU, in a field survey on SEPTEMBER 20, 19 93, do hereby certify that under requirements of P.A. 74, Michigan P.A. of 1970, the corner points mentioned in lines 1 and 2 above were in conformance with regulations and rules therelore as required in the current manual of survey instructions of the United States Department of the Interior, Bureau of Land Management or by a decree of a Court of Law and/or that the corner points mentioned in lines 3, 4 and 5 above were in conformance with the rules of the Michigan Board of Land Surveyors or by a Decree of a Court of Law; established, re-established, monumented, re-monumented, recovered, found as expressed below:

NOTE: Not more than 4 corners, all in the same town and range, may be recorded on this certificate.

A. Description of original monument and accessories and/or subsequent restoration:

- ORIGINAL CORNER WAS SET IN 1826 BY JOSEPH WAMPLER AS A POST WITNESSED BY:
BEECH 24" S 89° W 36'
DO. 6" N 55° E 24'
- CORNER WAS USED BY JOHN MCCREARY IN 1899 ON A SURVEY IN VOLUME 3, PAGE 415. CORNER WAS NOTED AS A POST, WITNESSED BY: SUGAR 4 S 50° W 87
BITTERNUT 3 N 10 1/4° E 45

(CONTINUED ON BACK)

B. Description of corner evidence found and/or method applied in restoring or reestablishing corner:

FOUND THE STEEL DOME 2 FOOT SOUTH OF CENTERLINE OF FROST ROAD, GRAVEL SURFACE. WITNESSES OF A-4 WAS FOUND. EXCAVATION OF STEEL DOME FOUND IT TO BE THE END OF AN AXLE SHAFT AS CALLED FOR IN A-3. FENCE TO NORTH. LEFT SHAFT IN POSITION AND ACCEPTED AS CORNER.

C. Description of monument for corner and accessories established to perpetuate locating the position of the corner:

FOUND 10" STEEL DOME/AXLE SHAFT, WITNESSED BY:
SET NAIL AND TAG #28414 EAST SIDE 32" MAPLE N 14° W 51.70 FEET
SET NAIL AND TAG #28414 EAST SIDE 32" MAPLE N 37° W 55.18 FEET
SET NAIL AND TAG #28414 NORTHWEST SIDE 28" MAPLE S 44° W 54.67 FEET
SET NAIL AND TAG #28414 NORTHWEST SIDE 38" MAPLE S 32° W 41.98 FEET
CENTERLINE OF CONCRETE GATE POST N 10° E 30.3 FEET

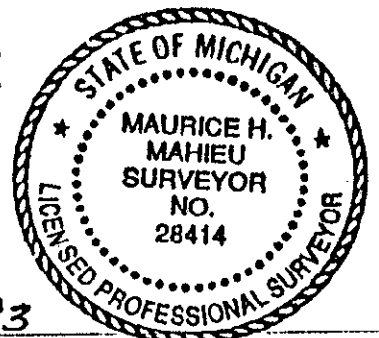

Signed by Maurice H. Mahieu Date 11-22-93

Surveyor's Michigan License No. 28414
2558

3. CORNER WAS NOTED ON INGHAM COUNTY ROAD COMMISSION CORNER SHEET DATED JANUARY 1969. THE MONUMENTATION WAS AXLE SHAFT WITNESSED BY:
 - 21" ELM NNE 30.9 FEET
 - GATE POST NNE 30.3 FEET
 - 14" MAPLE NW 55.3 FEET
 - 15" MAPLE WSW 42.9 FEET
 - 6" BEECH SW 54.9 FEET

4. AN ACT 132 SURVEY WAS RECORDED IN LIBER 1, PAGE 1192 BY RONNIE LESTER (P.S. #18998) JUNE 12, 1973
CALLS FOR CORNER AS STEEL DOME WITH HOLES WITNESSED BY:
 - NAIL AND TAG IN EAST SIDE 30" MAPLE NNW 51.99 FEET
 - NAIL AND TAG IN EAST SIDE 24" MAPLE NW 56.08 FEET
 - NAIL AND TAG IN NW SIDE 30" MAPLE SW 42.21 FEET

5. A LCRC IN LIBER 3, PAGE 69 DATED APRIL 74 BY RONNIE LESTER CALLS FOR MONUMENTATION AND WITNESSES TO BE SAME AS A-4.

6. INGHAM COUNTY REMONUMENTATION PROGRAM OF 1978 CALLS FOR 10" STEEL DOME WITH HOLE IN CENTER AS A TRAVERSE POINT WITH SAME WITNESSES AS A-4.