

DEC 16 1996

COMMISSION

LAND CORNER RECORDATION CERTIFICATE  
Filing Requirement of Act 74, Mich. P.A. 1970

Liber 9 Page 22

For corners in

Ingham  
(County)  
Albion Township

Located In:

Corner Code #

- |                                      |   |           |   |           |            |
|--------------------------------------|---|-----------|---|-----------|------------|
| 1. Public Land Survey                | T | <u>3N</u> | R | <u>1W</u> | <u>K-2</u> |
|                                      | T | ---       | R | ---       | ---        |
|                                      | T | ---       | R | ---       | ---        |
|                                      | T | ---       | R | ---       | ---        |
| 2. Property Controlling in Section   | S | ---       | T | ---       | ---        |
|                                      | S | ---       | T | ---       | ---        |
| 3. Miscellaneous Property in Section | S | ---       | T | ---       | ---        |
|                                      | S | ---       | T | ---       | ---        |

FILED

960038961  
10/09/1996 15:10:03  
REGISTER OF DEEDS  
Paula Johnson  
INGHAM COUNTY, MI

Register of Deeds Stamp & File Number

4. Lot No. \_\_\_\_\_, Recorded Plat \_\_\_\_\_
5. Private Claims \_\_\_\_\_

A	B	C	D	E	F	G	H	I	J	K
2	6	5	4	3	2					
3										
4	7	8	9	10	11					
5										
6	18	17	16	15	14	1				
7										
8	19	20	21	22	23	2				
9										
10	30	29	28	27	26	2				
11										
12	31	32	33	34	35	3				
13										

I, David R. Lohr, in a field survey on September 9, 1996, do hereby certify that under requirements of P.A. 74, Michigan P.A. of 1970, the corner points mentioned in lines 1 and 2 above were in conformance with regulations and rules therefore as required in the current manual of survey instructions of the United States Department of the Interior, Bureau of Land Management or by a decree of a Court of Law and/or that the corner points mentioned in lines 3, 4 and 5 above were in conformance with the rules of the Michigan Board of Professional Surveyors or by a Decree of a Court of Law; established, re-established, monumented, re-monumented, recovered, found as expressed below:

NOTE: Not more than 4 corners, all in the same town and range, may be recorded on this certificate.

A. Description of original monument and accessories and/or subsequent restoration:

- K-2 1. POST SET BY JOS. WAMPLER, DEP. SURVEYOR, IN DECEMBER 1826, WITNESSED BY:  
IRONWOOD 8" S 54 W 4 LINKS ( 2.64' )  
SUGAR 6" S 47 E 30 LINKS ( 19.80' )
2. T.J. BROWN, COUNTY SURVEYOR IN AN 1848 SURVEY RECORDED IN BOOK 4, PAGE 229. MAKES NO REFERENCE TO MONUMENT OR WITNESSES. SHOWS DISTANCE EAST TO L-2 OF 40.16 CHAINS (2650.56' )  
CONTINUED ON BACK

B. Description of corner evidence found and/or method applied in restoring or reestablishing corner:

- K-2: SEARCHED AT APPARENT LOCATION OF CORNER AND FOUND 1" PIPE AS PER ITEM #5. FOUND WITNESS TREES OF ITEM #4 TO NORTHWEST AND SOUTHEAST. ACCEPTED PIPE AS CORNER BASED ON TESTIMONY OF ITEMS #4 & #5. LEFT PIPE IN POSITION AND UPDATED WITNESSES. SET CAP #30090 INSIDE PIPE.

C. Description of monument for corner and accessories established to perpetuate locating the position of the corner:

- K-2: 1" PIPE WITH CAP #30090 ON FENCELINE TO SOUTH. WITNESSED BY:

- |   |        |
|---|--------|
| FD. N&T #25832, SE/S 18" CATALPA, AZ. 211 DEG., | 35.30' |
| FD. N&T #28414, N/S 24" CATALPA, AZ. 137 DEG.,  | 32.60' |
| FD. N&T #28414, S/S 24" CATALPA, AZ. 311 DEG.,  | 47.25' |
| FD. N&T #28414, E/S FENCE POST, AZ. 181 DEG.,   | 38.20' |
| SET N&T #30090, NW/S P. POLE, AZ. 47 DEG.,      | 77.65' |



Signed by David R. Lohr

Date September 18, 1996

Surveyor's Michigan License No. 30090

K-2, ALAIEDON TOWNSHIP, PART A - CONTINUED

3. T.J. BROWN, COUNTY SURVEYOR IN A NOV. 1875 SURVEY RECORDED IN BOOK 2, PAGE 131. MAKES NO REFERENCE TO MONUMENT OR WITNESSES. SHOWS DISTANCE EAST TO L-2 OF 40.16 CHAINS (2650.56')
4. CORNER REFERENCED ON C.P.CO. CARD, "MSHD 33084-06, 1960, D.H.W." "EAST 1/4 POST, SEC. 2, 4' X 4' X 12' STONE ON END."  
 WITNESSED BY:
 

12" CATALAPA	N 49 W,	48.50'	(FOUND)
16" CATALAPA	N 41 E,	61.72'	(GONE)
17" CATALAPA	S 40 E,	33.07'	(FOUND)
P.P.	S 32 W,	41.00'	(GONE)
5. CORNER REFERENCED ON MDSH FORM 280 CARD DATED MARCH 1967, BY C.E. SMITH. "FOUND STONE; RAISED WITH 1" PIPE FOR WEST 1/4 COR. SEC. 1, T3N, R1W, ALAIEDON TWP., INGHAM CO." WITNESSED BY:
 

N 80 W,	30.00'	P. POLE
N 15 E,	61.67'	18" MAPLE
S 60 E,	33.25'	19" CATALAPA
S 40 W,	40.10'	T. POLE

 REAR OF CARD SHOWS DISTANCE EAST TO L-2 OF 2658.23'
6. INGHAM COUNTY ROAD COMM. GRID MAP DATED JAN. 1, 1969 SHOWS "1" PIPE, (MDSH 1967). SAME WITNESSES AS ABOVE ITEM #4.
7. RECORDED SURVEY BY RONNIE LESTER, PS #18998, DATED 7/18/73, RECORDED IN LIBER 1, PAGE 955, STATES: "WEST 1/4 CORNER, SECTION 1, T3N, R1W, FOUND 1"PIPE." WITNESSED BY:
 

NAIL & TAG ON	S/S 32" CATALAPA	NW	48.25'
NAIL & TAG ON	W/S 20" MAPLE	NNE	62.21'
MSHD WITNESS TAG	ON 24" CATALAPA	SSE	33.21'
8. LCRC BY RONNIE LESTER, PS #18998, DATED 10/04/73, RECORDED IN LIBER 2, PAGE 503, STATES THAT ON JULY 18, 1973, "FOUND 1" PIPE AS CALLED FOR ON MDSH RECORDS WITH THESE WITNESSES"
 

N 49 W,	48.50'	12" CATALAPA
N 41 E,	61.62'	16" MAPLE
S 40 E,	33.07'	17" CATALAPA
S 32 W,	41.00'	P. POLE

"WEST 1/4 CORNER, SECTION 1, T3N, R1W, FOUND 1"PIPE AS WITNESSED ABOVE AND REWITNESSED".

NAIL & TAG ON	S/S 32" CATALAPA	NW	48.25'
NAIL & TAG ON	W/S 20" MAPLE	NNE	62.51'
MSHD WITNESS TAG	ON 24" CATALAPA	SSE	33.21'

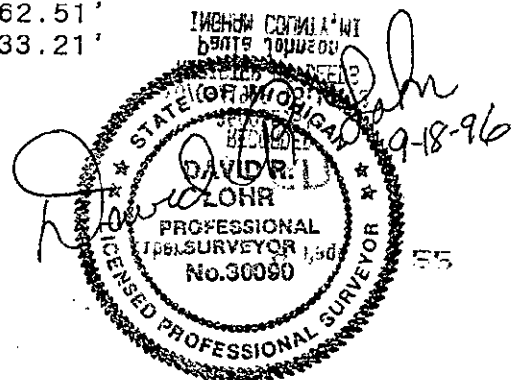

**SURVEY &  
REMONUMENTATION**

DEC 16 1996

**COMMISSION**

K-2, ALAIEDON TOWNSHIP, PART A - CONTINUED

9. CORNER REFERENCED IN MONUMENTED CORNER REPORT, C.E.T.A. REMON. PROGRAM OF 1978, DATED 9-14-78, BY LARRY BRYAN, CREW CHIEF. REPORT STATES: "FD. K-1" PIPE SET TO FD. STONE BY C.E. SMITH.  
REMAINING WITNESSES WERE: 32" CATALAPA NW 48.25'  
24" CATALAPA SSE 33.21'  
SET 2 MORE GOOD WITNESSES AS WRITTEN BELOW"

"FINAL WITNESSES, FD 1" PIPE C/L BUTTON ROAD, ALL N/TAG SET ARE RLS #18998," WITNESSED BY:

FD. N/FLAGING S/S 32" CATALAPA	N45W	48.25'
SET N/TAG S/S 24" CATALAPA	S40E	32.99'
SET N/TAG S/S 12" CATALAPA	N60E	71.92'
SET N/TAG NE/S 6" CATALAPA	S70W	35.32'

10. RECORDED SURVEY BY LARRY BRYAN, LLS #25832, DATED 6/14/88, RECORDED IN LIBER 6, PAGE 176, REFERS TO CORNER AS "EAST 1/4 CORNER SECTION 2, T3N, R1W, FOUND 3/4" PIPE ON EXTENSION CENTERLINE OF BUTTON RD. EAST AND CENTERLINE OF EVERY ROAD. LIBER 2, PAGE 503.

FOUND NAIL/TAG NORTHEAST SIDE 36" CATALAPA	S 45 E	33.27'
FOUND NAIL/TAG #18998 NORTHWEST SIDE 20" CATALAPA	S 30 W	35.28'
FOUND NAIL/TAG NORTHEAST SIDE 30" CATALAPA	N 45 W	48.35'

SURVEY SHOWS A DISTANCE SOUTH TO K-3 OF 2641.35'

11. UNRECORDED SURVEY #89-B-24067, BY LARRY BRYAN, LLS #25832, DATED 3/29/89, REFERS TO CORNER AS "WEST 1/4 CORNER, SECTION 1, T3N, R1W, LIBER 2, PAGE 503. FOUND 3/4" BAR ON CENTERLINE BUTTON AND EVERY RDS.  
WITNESSED BY:

FOUND NAIL/TAG NORTHEAST SIDE 36" CATALAPA	S 45 E	33.27'
FOUND NAIL/TAG #18998 NORTHWEST SIDE 20" CATALAPA	S 30 W	35.28'
FOUND NAIL/TAG NORTHEAST SIDE 30" CATALAPA	N 45 W	48.35'

SURVEY SHOWS A DISTANCE NORTH TO K-1 OF 2414.89'  
SURVEY SHOWS A DISTANCE EAST TO L-2 OF 2658.59'

12. SURVEY #5237, BY DAVID R. LOHR, PS #30090, DATED 11/12/90, RECORDED IN LIBER 6, PAGE 645-653, STATES: "WEST 1/4 CORNER", L2, PG. 503 FD. 3/4" IRON, BUTTON & EVERY RD." WITNESSED BY:

FD. N&T 36" CATALPA,	S 45 E,	33.27'
FD. N&T 20" CATALPA,	S 30 E,	35.28'
FD. N&T 30" CATALPA,	N 45 W,	48.35'

SURVEY SHOWS DISTANCE NORTH TO K-1 OF 2414.88'  
SURVEY SHOWS DISTANCE EAST TO L-2 OF 2658.77'

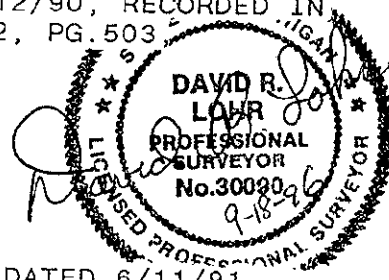

13. REVISED SURVEY #5237-R, BY DAVID R. LOHR, PS #30090, DATED 6/11/91, RECORDED IN LIBER 6, PAGE 725, STATES: "WEST 1/4 CORNER, SEC. 1, T3N, R1W." NO MENTION OF MONUMENT OR WITNESSES.  
SURVEY SHOWS DISTANCE EAST TO L-2 OF 2658.77'

14. UNRECORDED SURVEY #7488, BY DAVID R. LOHR, PS #30090, DATED 11/05/92, STATES: "WEST 1/4 CORNER, SEC. 1, T3N, R1W." SAME WITNESSES AND DATA AS IN ITEM #11 ABOVE.

15. RECORDED SURVEY, BY MAURICE MAHIEU, PS #28414, DATED 10/09/95, RECORDED IN LIBER 7, PAGE 691, STATES: "WEST 1/4 CORNER, SECTION 1, T3N, R1W, ALAIEDON TWP." "FOUND 1" PIPE AS RECORDED IN LIBER 2, LCRC, PAGE 503, INGHAM COUNTY RECORDS."  
SURVEY SHOWS A DISTANCE SOUTH TO K-3 OF 2641.30'