

FILED

NOV 15 1994

LAND CORNER RECORDATION CERTIFICATE
Filing Requirement of Act 74, Mich. P.A. 1970

JUL 16 8 18 AM '94

REGISTER OF DEEDS
INGHAM COUNTY, MICH.

COMMISSION

corners in

INGHAM (County)

LEDON TOWNSHIP
Public Land Survey

Located In:

Corner Code K-11

T 3N R 1W

K-11

T _____ R _____

T _____ R _____

T _____ R _____

Property Controlling

S _____ T _____ R _____

In Section

S _____ T _____ R _____

Miscellaneous

S _____ T _____ R _____

Property in Sec.

S _____ T _____ R _____

Register of Deeds Stamp & File Number

Lot No. _____ Recorded Plat _____
Private Claims _____

	A	B	C	D	E	F	G	H	I	J	K	L	M
2	6	5	4	3	2	1							
3													
4	7	8	9	10	11	12							
5													
6	18	17	16	15	14	13							
7													
8	19	20	21	22	23	24							
9													
10	30	29	28	27	26	25							
11													
12	31	32	33	34	35	36							
13													

DAVID R. LOHR, in a field survey on MAY 2, 1994, hereby certify that under requirements of P.A. 74, Michigan P.A. of 1970, the corner points mentioned in lines 1 and 2 above were in conformance with regulations and rules therefore as required in the present manual of survey instructions of the United States Department of the Interior, Bureau of Land Management or by a decree of a Court of Law and/or that the corner points mentioned in lines 3, 4 and 5 above were in conformance with the rules of the Michigan Board of Land Surveyors or by a Decree of a Court of Law; established, re-established, monumented, re-monumented, recovered, found as pressed below:

NOTE: Not more than 4 corners, all in the same town and range, may be recorded on this certificate.

Description of original monument and accessories and/or subsequent restoration:

K-11 1. POST SET BY MUSGROVE EVANS IN DECEMBER 1826, WITNESSED BY:
BEECH 16" SOUTH 60 DEGREES EAST 30 LINKS (23.76')
HICKORY 6" NORTH 57 DEGREES WEST 11 LINKS (7.26')

2. A. JACKSON, COUNTY SURVEYOR IN AN 1854 SURVEY RECORDED IN VOLUME 4, PAGE 370. MAKES NO REFERENCE TO MONUMENT.
WITNESSED BY: W. OAK 36" S 17 DEG. E 28 LINKS (18.48')
SUGAR MAPLE 10" N 10 DEG. E 10 LINKS (6.60')

CONTINUED ON BACK

B. Description of corner evidence found and/or method applied in restoring or reestablishing corner:

K-11: VISITED CORNER LOCATION AND FOUND R.R SPIKE IN MON. BOX AS PER LCRC OF LA, PG.188. CORNER LOCATED IN CENTERLINE OF HARPER AND EVERY ROADS. EXCAVATED INTERIOR OF MON BOX TO DEPTH OF 36". FOUND LARGE STONE AT BOTTOM OF HOLE, ACCEPTED R.R. SPIKE AS CORNER. SET STANDARD 3/4" x 24" REMON. BAR /PA 345 CAP, #30090 IN EXISTING MON BOX.

C. Description of monument for corner and accessories established to perpetuate locating the position of the corner:

K-11: 3/4" x 24" STANDARD REMON. BAR /PA 345 CAP, #30090, IN MON BOX.

WITNESSED BY:
FD. N&T #17640 IN S/S POLE AZ. 65 DEG. 62.00'
FD. N&T #18994 IN N/S 16" BASSWOOD AZ. 251 DEG. 84.65'
SET N&T #30090 IN N/S P. POLE AZ. 285 DEG. 220.30'
SET N&T #30090 IN E/S P. POLE AZ. 352 DEG. 186.63'
BEARING AND DISTANCE TO K-10 AZ. 00-04-37 DEG. 2663.04'
BEARING AND DISTANCE TO J-11 AZ. 270-16-42 DEG. 2620.80'

Signed by David R. Lohr

Date JUNE 28, 1994

Surveyor's Michigan License No. 30090

P.A. 345 INGHAM COUNTY
FORM APPROVED BY MICHIGAN STATE BOARD OF LAND SURVEYORS, INC.
REVISOR: MARY ANN
DATE: 4/8/94

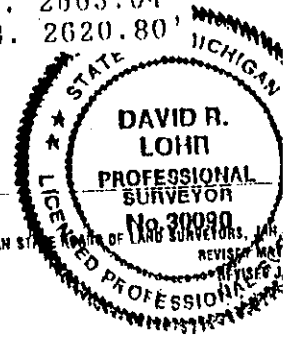

Page 2

K-11 CONTINUED

3. A.P. DRAKE, COUNTY SURVEYOR, IN AN 1880 SURVEY RECORDED IN VOLUME 2, PAGE 135. STATES "POST" WITNESSED BY:
 NE CORNER OF HOUSE N 35 1/2 DEG. W 238 LINKS (157.08')
 BALMFILED 10" S 59 1/2 DEG. ET 93 LINKS (61.38')
4. NO OTHER REFERENCES FOUND IN COUNTY SURVEYORS RECORDS
5. L.C.R.C. BY GEORGE YOUNG, DATED 4/26/78, LIBER 4, PAGE 188. STATES: "FOUND R-ROAD SPIKE AT INTERSECTION OF ROADS; LOCATION IN CLOSE ACCORD WITH ORIGINAL DISTANCES TO ADJACENT CORNERS." WITNESSED BY:
 NAIL AND CAP IN 24" MAPLE NORTH 20 DEG. EAST 115.21'
 NAIL AND CAP IN POWER POLE NORTH 50 DEG. EAST 61.88'
 NAIL AND CAP IN POWER POLE NORTH 10 DEG. WEST 186.00'
6. RECORDED SURVEY BY RONNIE LESTER, PS #18998, DATED 2/80, LIBER 3 PAGE 1196. NO MENTION OF MONUMENT WITNESSED BY: WITNESSED AS ABOVE #5.
7. RECORDED SURVEY BY GEORGE YOUNG, PS #17640, DATED 3/14/80, LIBER 3 PAGE 1244. STATES "FD. RAILROAD SPIKE" WITNESSED AS ABOVE #5.
8. RECORDED SURVEY BY A. WILLIAMS, PS #21275, DATED 9/84, LIBER 4 PAGE 930. NO MENTION OF MONUMENT. WITNESSED AS ABOVE #5.
9. RECORDED SURVEY BY GEORGE YOUNG, PS #17640, DATED 4/26/85, LIBER 4 PAGE 1045. STATES "FD. R.R SPIKE IN INTERSECTION." WITNESSED AS ABOVE #5.
10. RECORDED SURVEY BY GEORGE YOUNG, DATED, 1/15/86, LIBER 4 PAGE 1183. STATES "FD. R.R SPIKE IN INTERSECTION." WITNESSED AS ABOVE #5.
11. UNRECORDED SURVEY BY RON HELSEL, PS #18994, DATED 12/13/93 SURVEY NUMBER 93-5479-A. STATES: "FD. RAILROAD SPIKE IN MON BOX IN CENTERLINE OF EVERY AND HARPER ROADS." WITNESSED BY:
 FD. N&T #17640 S/SIDE P. POLE NORTH 60 DEG. EAST 61.98'
 SET N&T EAST SIDE A. POST SOUTH 45 DEG. WEST 44.80'
 SET N&T NORTH SIDE 18" ELM SOUTH 60 DEG. WEST 84.70'
 SET N&T WEST SIDE 16" ELM NORTH 20 DEG. EAST 88.37'