

1901 & 1955

COMMISSION

LAND CORNER RECORDATION CERTIFICATE  
Filing Requirement of Act 74, Mich. P.A. 1970

Liber 9 Page 144

For corners in  
INGHAM  
(County)

Located In:

Corner Code #

MERIDIAN TWP.

- 1. Public Land Survey T 4N R 1W
- T \_\_\_\_\_ R \_\_\_\_\_
- T \_\_\_\_\_ R \_\_\_\_\_
- T \_\_\_\_\_ R \_\_\_\_\_
- 2. Property Controlling S \_\_\_\_\_ T \_\_\_\_\_ R \_\_\_\_\_
- in Section S \_\_\_\_\_ T \_\_\_\_\_ R \_\_\_\_\_
- 3. Miscellaneous S \_\_\_\_\_ T \_\_\_\_\_ R \_\_\_\_\_
- Property in Section S \_\_\_\_\_ T \_\_\_\_\_ R \_\_\_\_\_

L-11

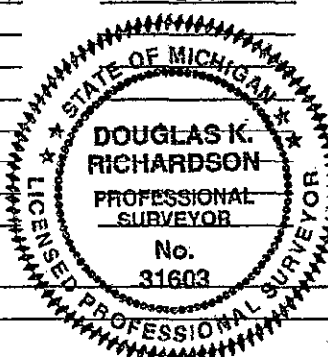

FILED

960046332  
12/04/1996 14:59:54  
REGISTER OF DEEDS  
Paula Johnson  
INGHAM COUNTY, MI

Register of Deeds Stamp & File Number

- 4. Lot No. \_\_\_\_\_, Recorded Plat \_\_\_\_\_
- 5. Private Claims \_\_\_\_\_

A	B	C	D	E	F	G	H	I	J	K
2	6	5	4	3	2					
3										
4	7	6	5	4	3	2				
5										
6	18	17	16	15	14					
7										
8	19	20	21	22	23					
9										
10	30	29	28	27	26					
11										
12	31	32	33	34	35					
13										

DOUGLAS K. RICHARDSON, in a field survey on SEPTEMBER 18th, 19 96, do hereby certify that under requirements of P.A. 74, Michigan P.A. of 1970, the corner points mentioned in lines 1 and 2 above were in conformance with regulations and rules therefore as required in the current manual of survey instructions of the United States Department of the Interior, Bureau of Land Management or by a decree of a Court of Law and/or that the corner points mentioned in lines 3, 4 and 5 above were in conformance with the rules of the Michigan Board of Professional Surveyors or by a Decree of a Court of Law; established, re-established, monumented, re-monumented, recovered, found as expressed below:

NOTE: Not more than 4 corners, all in the same town and range, may be recorded on this certificate.

A. Description of original monument and accessories and/or subsequent restoration:

- 1. 1827, JANUARY 25 - G.L.O. NOTES OF MUSGROVE EVANS, U. S. DEPUTY SURVEYOR (MERIDIAN TWP. BOOK, P. 26)  
MONUMENT: Set 1/4 Section Post  
WITNESSED BY: Beech 8 in. S26°W 18 Links (11.88 feet)  
Beech 9 in. N46°E 22 Links (14.52 feet)

Note: G.L.O. Plat Map prepared by the Ingham County Survey And Remonumentation Project in 1978 (a.k.a. CETA) from the original field notes shows a tie between L-11 and K-11 of 2649.24 feet and between L-11 and M-11 of 2649.24 feet.

(Part "A" continued on back)

B. Description of corner evidence found and/or method applied in restoring or reestablishing corner:

Found the 4" concrete monument with 1/2" bar on the West side of an anchor post at the intersection of North, South, and East fence lines in accord with the location described in Items 3, 7, 8, and 12 of Part "A". Monument stands 0.8' out of the ground with concrete poured around it. In the concrete is written "RLS #30090". I would surmise that Surveyor Lohr replaced the 3/4" pipe with a concrete monument after recording the plat of "Chimney Oaks"; thus, the 3/4" pipe was still in place when Surveyor Bryan visited this location during survey in 1988 (Item 8), but it would not have been there at the time of Surveyor Sheilenbarger's survey in 1992 (Item 10). The witnesses given from Item 3 to the end of the report generally match. I was able to locate the three most often noted. The large twin Maple 6 feet to the South was dead and decaying with no sign of nail & tag. Measured N00°04'22"E, 2639.77 feet to L-10; N89°05'05"E, 2654.18 feet to M-11; and S89°12'55"W, 2605.27 feet to K-11. Accepted the concrete monument as the perpetuated corner at L-11, Meridian Township, T4N, R1W. Left in place and set a yellow plastic Remonumentation Cap labeled "P.A. 345 31603" on the existing monument.

C. Description of monument for corner and accessories established to perpetuate locating the position of the corner:

- L-11, MERIDIAN TOWNSHIP, T4N,R1W:  
MONUMENT: Found 4" concrete monument with 1/2" bar as set in the plat of "Chimney Oaks" - Set a yellow plastic Remonumentation Cap labeled "P.A. 345 31603" on the monument.
- WITNESSED BY:
  - A Found nail & "25832" tag in West Side of 18" Maple.....North 38.83'
  - Set nail & yellow "DKR PS 31603" tag in SE side of 18" Elm.....N12°E 40.18'
  - Set nail & yellow "DKR PS 31603" tag in West side of 22" Maple.....South 24.49'
  - C Set nail & yellow "DKR PS 31603" tag in SE side of 18" Maple.....S40°W 30.55'
  - Set nail & yellow "DKR PS 31603" tag in North side of 8" Maple.....S80°W 20.73'

Signed by [Signature] Date NOV. 13, 1996

Surveyor's Michigan License No. 31603 FORM APPROVED BY MICHIGAN STATE BOARD OF PROFESSIONAL SURVEYORS, JAN. 28, 19

(Meridian L-11, Part "A" continued)

2. 1827, JAN. & FEB. - G.L.O. MAP BY MUSGROVE EVANS, U. S. DEPUTY SURVEYOR (VOLUME 1 OF CHAD MAPS, PAGE 71)  
MONUMENT AND WITNESSES: None given. Drawing shows a tie of 40.14 chains (2649.24 feet) between L-11 and M-11.
3. 1879, JUNE 5 & 6 - COUNTY SURVEYOR NOTES OF A. P. DRAKE (VOL. 3, P. 150 & BOOK 2, P. 171)  
MONUMENT AND WITNESSES: Same as Item 1 above.
4. 1967, APRIL - M.S.H.D. FORM 280 CARD BY PHIL WETOSKEY, PARTY CHIEF  
MONUMENT: 3/4" pipe in fence corner.  
WITNESSED BY:
 

<b>A</b>	12" Maple.....	Due North	38.74'
	7" Maple.....	S80°E	9.90'
<b>B</b>	26" Maple.....	S30°E	6.10'

Back of card shows a tie of 2605.10 feet between L-11 and K-11.
5. 1969, JANUARY 1 - INGHAM COUNTY ROAD COMMISSION GRID MAP, SHEET 10  
MONUMENT AND WITNESSES: Same as Item 3 above.
6. 1984, DECEMBER 3 - SURVEY #84-B-4712 BY LARRY A. BRYAN, PS #25832 (PRIVATE RECORDS)  
MONUMENT: Found 3/4" pipe on East side corner post, fence lines North & South & East.  
WITNESSED BY:
 

<b>B</b>	Found nail & washer West side 30" Maple.....	S05°E	6.07'
<b>A</b>	Found nail & washer West side 18" Hickory.....	North	38.72'
<b>C</b>	Set nail & tag North side 14" Oak.....	S35°W	30.65'
7. 1987, OCTOBER 6 - SURVEY #873-M BY DOUGLAS K. RICHARDSON, PS #31603 (LIBER 5 OF SURVEYS, PAGES 329-331)  
MONUMENT AND WITNESSES: L-11 noted as "(MDOT-L11)" with no other witnesses or monument mentioned.
8. 1988, DECEMBER 2 - P.A. 288 SUBDIVISION "CHIMNEY OAKS" BY DAVID R. LOHR, PS #30090 (LIBER 44 OF PLATS, PAGES 1-4)  
MONUMENT: Set as per plat legend; also noted as "L. 3, Pg 506"\*  
WITNESSED BY: Noted as "L. 3, Pg 506"\* with no other witnesses mentioned.  
Drawing shows ties of N00°04'22"E, 2639.53 between L-11 and L-10; and S89°04'29"W, 2654.61 feet between M-11 and L-11. (Bearing basis: "West line of the recorded plat of Grand Estates" shown as the line between M-9 and M-11 bearing South) (\*Note by MS: the LCRC recorded in L. 3; Pg 506 is mislabeled as "L-11, Center of Section 36" and the index shows it at L-11; however, it is actually corner L-12.)
9. 1988, DECEMBER 6 - SURVEY #88-B-22783 BY LARRY A. BRYAN, PS #25832 (LIBER 5 OF SURVEYS, PAGES 561 & 562)  
MONUMENT: Found 3/4" pipe at fence intersection on West side of anchor post, fence lines North, South & East.  
WITNESSED BY:
 

<b>B</b>	Found nail & tag West side 24" Twin Maple.....	S05°E	6.05'
<b>C</b>	Found nail & tag North side 18" Maple.....	S45°W	30.60'
<b>A</b>	Found nail & tag West side 20" Maple.....	North	36.80'

Drawing shows a tie of S00°23'35"W, 2634.59 feet between L-11 and L-12. (Bearing basis: "South line of Section 36, which is recorded to bear East in Liber 4 of Surveys, Page 344" - L. 4, P. 344 does not show L-11.) Survey dated November 30, 1988.
10. 1989, JANUARY 23 - P. A. 74 LCRC BY LARRY A. BRYAN, PS #25832 (LIBER 7 OF CORNERS, PAGE 56)  
MONUMENT AND WITNESSES: Same as Item 9 above. Certificate states "Original monument and accessories obliterated".
11. 1992, AUGUST 4 - SURVEY #92-275 BY KEYNO J. SHELLNBARGER, PS #30101 (LIBER 6 OF SURVEYS, PAGE 1007)  
MONUMENT: Found 3/4" pipe.  
WITNESSED BY: Same as Item 9 above; also "Witnesses substantially as recorded in L. 7 of corners, P. 56."  
Drawing shows a tie of S00°23'35"W, 2634.59 feet between L-11 and L-12. (Bearing basis: "North-South 1/4 line of Section 36" ... "as recorded in L. 5 of Surveys, Page 561" - Item 9 above.)
12. 1993, JANUARY 28 - SURVEY #875 BY MARVIN F. FOUTY, PS #19898 (LIBER 6 OF SURVEYS, PAGES 1090-1093\*)  
MONUMENT AND WITNESSES: Noted as "Found Mon.", with no other witnesses or monument mentioned.  
Drawing shows a tie of N00°04'55"W, 2634.00 feet between L-12 and L-11. (Bearing basis: "East line of Section 36 which is recorded to bear N00°01'56"W in the recorded condominium of Baan.Gan.Aka.") (\*Note by MS: survey revisions with no change to section corners have been recorded in L. 6, P. 1278 & L. 7, P. 575.)
13. 1993, SEPTEMBER 15 - SURVEY #924 BY MARVIN F. FOUTY, PS #19898 (PRIVATE RECORDS)  
MONUMENT AND WITNESSES: Same as Item 12 above.  
Drawing shows a tie of S00°25'01"E, 2634.00 feet between L-11 and L-12. (Bearing basis: none given.)
14. 1994, MAY 17 - SURVEY #8448 BY DAVID R. LOHR, PS #30090 (LIBER 7 OF SURVEYS, PAGES 220 & 221)  
MONUMENT: Found 4" monument at intersection of fence lines North, South & East.  
WITNESSED BY:
 

<b>B</b>	Found nail/tag West side 30" Maple.....	S10°E	6.07'
<b>A</b>	Found nail/tag West side 18" Hickory.....	North	38.72'
<b>C</b>	Found nail/tag North side 14" Oak.....	S35°W	30.65'

NOTE: **A** Indicates matching witnesses

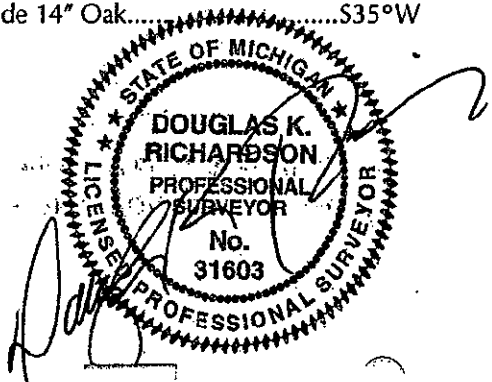

(END OF REPORT)