

DEC 16 1996

COMMISSION

LAND CORNER RECORDATION CERTIFICATE  
Filing Requirement of Act 74, Mich. P.A. 1970

Liber

9 Page

151

For corners in  
INGHAM  
(County)  
MERIDIAN TWP.

Located In:

Corner Code #

- 1. Public Land Survey T 4N R 1W M-9  
T \_\_\_\_\_ R \_\_\_\_\_  
T \_\_\_\_\_ R \_\_\_\_\_ \* REF. ONLY -  
T \_\_\_\_\_ R \_\_\_\_\_ HOUSE AT
- 2. Property Controlling S \_\_\_\_\_ T \_\_\_\_\_ R \_\_\_\_\_  
in Section S \_\_\_\_\_ T \_\_\_\_\_ R \_\_\_\_\_
- 3. Miscellaneous S \_\_\_\_\_ T \_\_\_\_\_ R \_\_\_\_\_  
Property in Section S \_\_\_\_\_ T \_\_\_\_\_ R \_\_\_\_\_
- 4. Lot No. \_\_\_\_\_, Recorded Plat \_\_\_\_\_
- 5. Private Claims \_\_\_\_\_

FILED

960046335  
12/04/1996 14:59:59  
REGISTER OF DEEDS  
Paula Johnson  
INGHAM COUNTY, MI

Register of Deeds Stamp & File Number

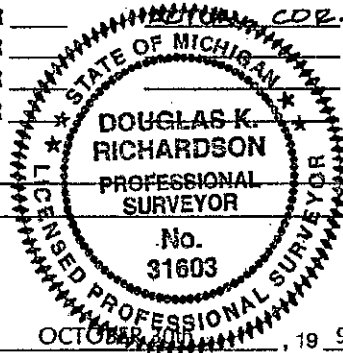

I, DOUGLAS K. RICHARDSON, in a field survey on OCTOBER 20, 19 96

do hereby certify that under requirements of P.A. 74, Michigan P.A. of 1970, the corner points mentioned in lines 1 and 2 above were in conformance with regulations and rules therefore as required in the current manual of survey instructions of the United States Department of the Interior, Bureau of Land Management or by a decree of a Court of Law and/or that the corner points mentioned in lines 3, 4 and 5 above were in conformance with the rules of the Michigan Board of Professional Surveyors or by a Decree of a Court of Law; established, re-established, monumented, re-monumented, recovered, found as expressed below:

NOTE: Not more than 4 corners, all in the same town and range, may be recorded on this certificate.

A. Description of original monument and accessories and/or subsequent restoration:

- 1. 1824, FEBRUARY 18 - G.L.O. NOTES OF JOSEPH WAMPLER, U. S. DEPUTY SURVEYOR (MERIDIAN TWP. BOOK, P. 8)

MONUMENT: Set post cor of Sections 24 & 25  
WITNESSED BY: W. Ash 8 in..... N31°W 68 links (44.88')  
W. Ash 14 in..... S38-1/2°W 170 links (112.20')

Note: G.L.O. Plat Map prepared by the Ingham County Survey And Remonumentation Project in 1978 (a.k.a. CETA) from the original field notes shows ties of 2640.66 feet between M-9 and L-9; 2640.00 feet between M-9 and M-8; and 2640.00 feet between M-9 and M-10.

(Part "A" continued on back)

B. Description of corner evidence found and/or method applied in restoring or reestablishing corner:

Found 1/2" x 18" bar, 3' East of the driveway to house at 4363 Wilfors Drive and 31.5' North from the centerline of Congdon Drive. Witnesses found agree with those listed in Bryan's LCRC (Item 7, of Part "A"). History of this corner in the public record is not very substantial. Surveyor Hendryx may have found the corner when platting "Red Cedar Manor" in 1955 (Item 3, of Part "A") but that is uncertain since he did not show any measurements to it. In the late 1960's the highway department apparently located a monument at M-9 and shows ties North and South to the adjacent township corners as noted in Item 4 of Part "A". Sometime after the map for Highway M-43 was drawn a house was built in the location of the original monument, and Surveyor Bryan 'discovered' this in his 1987 Survey (Item 6, of Part "A"). He re-established the corner to conform to Wampler's Survey of the East Line of Meridian Township and set a reference iron as noted in his LCRC (see Bryan's traverse notes in Item 6). A comparison of his measurements to those of the highway

(Part "B" continued on back)

C. Description of monument for corner and accessories established to perpetuate locating the position of the corner:

M-9, MERIDIAN TOWNSHIP, T4N,R1W:

MONUMENT: Found 1/2" x 18" bar, 3' East of the driveway to house at 4363 Wilfors Drive and 31.5' North from  
(REF. ONLY) the centerline of Congdon Drive. Replaced it with a 3/4" bar and yellow plastic Remonumentation Cap labeled "P.A. 345 31603"

WITNESSED BY: **A** Found concrete monument..... S76°E 49.02'  
**B** Found concrete monument..... N76°W 81.28'  
**C** Southwest corner of garage at 4363 Wilfors Drive..... N25°W 33.21'  
**D** Southeast corner of porch at 4363 Wilfors Drive..... N30°E 27.60'

Signed by

Date

NOV. 19, 1996

Surveyor's Michigan License No. 31603

FORM APPROVED BY MICHIGAN STATE BOARD OF PROFESSIONAL SURVEYORS, JAN. 28, 1971

P.A. 345 INGHAM COUNTY

REVISED MAY 14, 1975

PEER APPROVED 11/14/96

P.A. 345 INGHAM COUNTY

REVISED JAN., 1983

(Meridian M-9, Part "A" continued)

- 2. 1827, JAN. & FEB. - G.L.O. MAP OF BY MUSGROVE EVANS, U. S. DEPUTY SURVEYOR (VOLUME 1 OF CHAD MAPS, PAGE 71) MONUMENT AND WITNESSES: None given. Drawing shows a tie of 80.03 chains (5281.98') between M-9 and K-9.
- 3. 1955, OCTOBER 29 - P.A. 288 SUB. "RED CEDAR MANOR" BY LAVERNE J. HENDRYX, PS #3276 (LIBER 19 OF PLATS, PAGE 18) MONUMENT AND WITNESSES: None given. Drawing depicts M-9 as being East of Lot 4 and North of Congdon Drive, Red Cedar Manor Subdivision; however, plat is not tied to M-9.
- 4. 1969, MARCH 31 - M.D.O.T. MAP OF HIGHWAY M-43 (PROJECT 33-37, INGHAM COUNTY, SHEET 112) MONUMENT AND WITNESSES: None given. Drawing shows ties of 1232.88 feet between M-9, Meridian Township, T4N,R1W and C-9, Williamstown Township, T4N, R1E; and 1369.62 feet between M-9 and C-10.
- 5. 1985, NOVEMBER 19 - SURVEY #753-M BY FRED N. WHITE, PS #12034 (LIBER 4 OF SURVEYS, PAGES 1155-1156) MONUMENT AND WITNESSES: None given.

- 6. 1987, JULY 17 - SURVEY #87-B-16852 BY LARRY A. BRYAN, PS #25832 (PRIVATE RECORDS) MONUMENT (ref.): True location of corner falls within house #4363 Wilfors Drive. A reference corner was set on the East line of Section 24, at a distance of 58.30 feet S00°38'33"W of the actual corner, and on the South line of Lot 42, Red Cedar Manor No. 1. (MS note: Red Cedar Manor No. 1 doesn't show M-9).

WITNESSED BY:

A	Concrete monument.....	S76°32'13"E 49.02'
B	Concrete monument.....	N76°32'13W 81.30'
C	Southwest corner garage house #4363 Wilfors Drive.....	N25°W 33.24'
D	Southeast corner porch house #4363 Wilfors Drive.....	N30°E 27.60'

Drawing shows a tie of S89°39'25"E, 2643.26 feet between L-9 and M-9. (Bearing basis: "Centerline of M-43...which is recorded to bear S76°27'00"E on sheet No. 111 of the Ingham County, right of way maps.")

Traverse notes show ties of 5274.82 feet between M-8 and M-10 with M-9 at the midway point; 5285.67 between M-9 and K-9; 1232.78 feet between M-9, and C-9, Williamstown Township, T4N, R1E; and 1369.01 feet between M-9 and C-10, Williamstown Township.

- 7. 1988, JANUARY 5 - P. A. 74 LCRC BY LARRY A. BRYAN, PS #25832 (L. 6 OF CORNERS, PAGE 353) MONUMENT AND WITNESSES: Same as Item 6 above. Certificate also states that the field survey was performed on July 17, 1987; that the original monument and accessories were obliterated; and that corner was reestablished midway and on line between East 1/4 corner of Section 25 and East 1/4 corner of Section 24, Meridian Twp., T4N,R1W.
- 8. 1988, MARCH 15 - P.A. 288 SUB. "BRACKEN WOODS" BY MAURICE H. MAHIEU, PS #28414 (LIBER 43 OF PLATS, PAGES 1-4) MONUMENT AND WITNESSES: M-9 noted as "( corner falls in house )" with "reference corner recorded in Liber 6, Page 363". No other witnesses or monument mentioned. M-9 is not a monumented plat corner. Drawing shows ties of N00°26'31"E, 58.33 feet between M-9 and reference corner; N00°26'31"E, 2637.41 between M-9 and M-8; and S89°51'22"E, 2643.26 feet between L-9 and M-9. (Bearing basis: "from the M.D.O.T. plans for Highway M-43" shown on drawing at N76°27'00"W)

(Meridian M-9, Part "B" continued)

department map and the original G.L.O. notes confirms that the house at 4363 Wilfors Drive, being on Lot 42 of "Red Cedar Manor No. 1," occupies the location of the original monument. The monument set by Wampler and as perpetuated has obviously been obliterated thus making excavation unnecessary. The plat of "Bracken Woods" has been developed using Bryan's location of M-9 thus perpetuating the section corner established in 1987. Accepted the 1/2" x 18" bar as the reference iron set by Surveyor Bryan along the East line of Section 25, Meridian Township, T4N,R1W at a point 58.30 feet South from the actual location of M-9. Replaced it with a 3/4" bar and yellow plastic Remonumentation Cap labeled "P.A. 345 31603."

NOTE: A Indicates matching witnesses

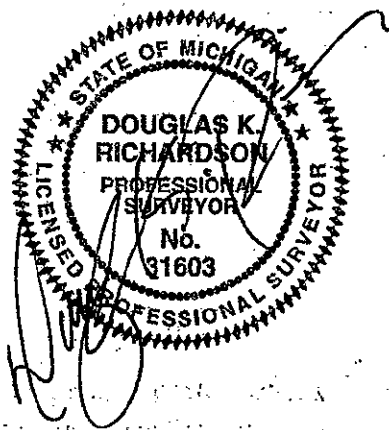

(END OF REPORT)

RECEIVED  
 1988  
 MARCH 15  
 1988