

DEC 1 6 1996

COMMISSION

LAND CORNER RECORDATION CERTIFICATE  
Filing Requirement of Act 74, Mich. P.A. 1970

Liber 9 Page 153

FILED

960046335  
12/04/1996 15:00:01  
REGISTER OF DEEDS  
Paula Johnson  
INGHAM COUNTY, MI

For corners in INGHAM Located In: \_\_\_\_\_ Corner Code # \_\_\_\_\_  
(County)  
MERIDIAN TWP.

- 1. Public Land Survey T 4N R 1W M-10
- T \_\_\_\_\_ R \_\_\_\_\_
- T \_\_\_\_\_ R \_\_\_\_\_
- T \_\_\_\_\_ R \_\_\_\_\_
- 2. Property Controlling S \_\_\_\_\_ T \_\_\_\_\_ R \_\_\_\_\_  
in Section S \_\_\_\_\_ T \_\_\_\_\_ R \_\_\_\_\_
- 3. Miscellaneous S \_\_\_\_\_ T \_\_\_\_\_ R \_\_\_\_\_  
Property in Section S \_\_\_\_\_ T \_\_\_\_\_ R \_\_\_\_\_

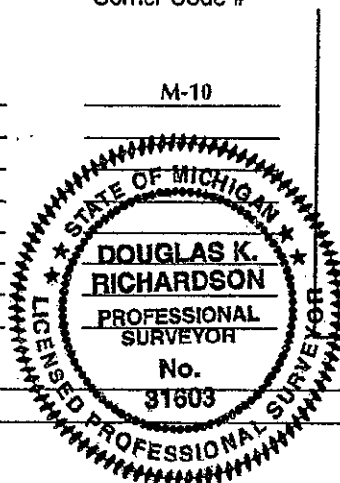

Register of Deeds Stamp & File Number

- 4. Lot No. \_\_\_\_\_, Recorded Plat \_\_\_\_\_
- 5. Private Claims \_\_\_\_\_

	A	B	C	D	E	F	G	H	J	K
2	6		5		4		3		2	
3										
4	7		8		9		10		11	
6										
6	18		17		16		15		14	
7										
8	19		20		21		22		23	
9										
10	30		29		28		27		26	
11										
12	31		32		33		34		35	
13										

DOUGLAS K. RICHARDSON, in a field survey on SEPTEMBER 18th, 19 96 do hereby certify that under requirements of P.A. 74, Michigan P.A. of 1970, the corner points mentioned in lines 1 and 2 above were in conformance with regulations and rules therefore as required in the current manual of survey instructions of the United States Department of the Interior, Bureau of Land Management or by a decree of a Court of Law and/or that the corner points mentioned in lines 3, 4 and 5 above were in conformance with the rules of the Michigan Board of Professional Surveyors or by a Decree of a Court of Law; established, re-established, monumented, re-monumented, recovered, found as expressed below:

NOTE: Not more than 4 corners, all in the same town and range, may be recorded on this certificate.

A. Description of original monument and accessories and/or subsequent restoration:

- 1. 1824, FEBRUARY 18 - G.L.O. NOTES OF JOSEPH WAMPLER, U. S. DEPUTY SURVEYOR (MERIDIAN TWP. BOOK, P. 8)  
MONUMENT: Set 1/4 section post.  
WITNESSED BY: Beech 3 in. N36°W 34 links (22.44 feet)  
Beech 4 in. S19-1/2°W 18 links (11.88 feet)

Note: G.L.O. Plat Map prepared by the Ingham County Survey and Remonumentation Project in 1978 (a.k.a. CETA) from the original field notes shows ties of 2640.00 feet between M-10 and M-9; and 2640.00 feet between M-10 and M-11.

(Part "A" continued on back)

B. Description of corner evidence found and/or method applied in restoring or reestablishing corner:

Found 4" concrete monument with 1/2" bar & yellow plastic cap (unreadable) in monument box, 0.2' below road surface, 4.7' West from the centerline of Meridian Road. Witnesses listed in Lohr's LCRC (Item 8 of Part "A") appear to match those in the CETA LCRC rough notes (Item 3 of Part "A") and as subsequently noted in Items 5 and 7 of Part "A". Witnesses found agree with those listed.

Measured S00°00'45"W, 2620.36 feet to M-11, and S89°30'11"W, 2651.16 feet to L-10, Meridian Township, T4N,R1W; also, measured both North and South to closing corners of Williamstown Township, T4N,R1E as noted below.

Accepted the monument with 1/2" bar & cap as that set following the 1980 CETA excavation and as perpetuated. Left in place and set a yellow plastic Remonumentation cap labeled "P.A. 345 31603" on the existing monument.

C. Description of monument for corner and accessories established to perpetuate locating the position of the corner: M-10, MERIDIAN TOWNSHIP, T4N,R1W:

- MONUMENT: Found 4" concrete monument with 1/2" bar & yellow plastic cap (unreadable) in monument box, 0.2' below road surface, 4.7' West from the centerline of Meridian Road. Set a yellow plastic Remonumentation cap labeled "P.A. 345 31603" on the existing monument.
- WITNESSED BY:
  - B** Found nail & "18998" tag in West side of 12" Poplar..... N35°E 63.75'
  - C** Found nail & "18998" tag in SW side of 8" Poplar..... S25°E 58.78'
  - Set nail & yellow "DKR PS 31603" tag in East side of 24" Oak..... S20°W 71.75'
  - D** Found nail & "25832" tag in North side of 55" Oak..... S45°W 24.16'
  - A** Set nail & yellow "DKR PS 31603" tag in NE side of 36" Oak..... West 45.74'
  - Found 3/4" pipe at C-10, Williamstown Twp, T4N,R1E..... North 1164.95'
  - Found 5/8" bar in mon. box at A-11, Williamstown Twp, T4N,R1E..... South 1437.40'

Signed by [Signature] Date NOV. 19, 1996  
Surveyor's Michigan License No. 31603

2. 1901, JULY 8 - COUNTY SURVEYOR NOTES OF E. A. CALKINS (CETA FILE FOR M-10, MERIDIAN TOWNSHIP)

MONUMENT: Stone, brick, iron, etc.  
WITNESSED BY: Birch 18 in. N50°W 52 links (34.32')

3. 1980, JUNE 24 - MONUMENTED CORNER REPORT & LCRC ROUGH NOTES (CETA FILE FOR M-10, MERIDIAN TWP.)

"Excavated a hole 10' x 10' to an average depth of 3.1' on the centerline of Meridian Road, +/- 1456' from A-11 Williamston. No evidence found. Excavated a hole 10' x ?' on the centerline of Meridian Road, 10' South of previous excavation. Found iron runner with broken tile 1.1' below road surface on fence line West & 4.1' West Of centerline of Meridian Road. Accepted iron runner for corner."

MONUMENT: Set 4" x 36" concrete monument with 1/2" x 38" rod & cap #18998 with concrete collar & cover in location of iron runner described above.

WITNESSED BY: A Nail & tag, #18998, North side 30" Oak..... West 45.89'  
B Nail & tag, #18998, Northwest side 6" Elm..... NE 63.59'  
C Nail & tag, #18998, West side 6" Poplar..... SSE 58.90'  
D Nail & tag, #18998, North side 40" Oak..... SE 24.31'

(Note by MS: this CETA corner never appears in the LCRC public records.)

4. 1980, JUNE 13 / AUGUST 10 / SEPTEMBER 22 - FIELD NOTES (CETA FILE FOR M-10, MERIDIAN TOWNSHIP)

MONUMENT: Found conc. mon  
WITNESSED BY: "Lester wit's"  
Notes show distance of 1437.48 feet between M-10 and A-11, Williamstown Township, T4N,R1E.

5. 1984, OCTOBER 29 - SURVEY #753-M BY FRED N. WHITE, PS #12034 (LIBER 4 OF SURVEYS, PAGES 1155-1156)

MONUMENT: Found 1/2" iron & cap  
WITNESSED BY: Iron and cap #25832..... West 33.0'  
D Nail & tag #18998, N. side 60" Oak..... S40°W 24.20'  
A Nail & tag #18998, N. side 48" Oak..... N85°W 45.95'  
B Nail & tag #18998, NW side 12" Elm..... N35°E 63.73'  
Centerline Meridian Road..... East 4.3'

Drawing shows a tie of N00°46'47"E, 1165.32 feet between M-10 and C-10, Williamstown Township, T4N,R1E. (Bearing basis: "MDOT Project 33-37, Control Section 33082, Sheet 112" centerline of M-43 shown at S68°37'00"E.)

6. 1984, DECEMBER 3 - SURVEY #84-B-4712 BY LARRY A. BRYAN, PS #25832 (PRIVATE RECORDS)

MONUMENT: Found 1/2" bar & cap #18998 in concrete 4' West centerline Meridian Road.  
WITNESSED BY: B Found nail & tag #18998 West side 12" Elm..... N30°E 63.70'  
D Found nail & tag #18998 North side 50" Oak..... S45°W 24.26'  
A Found nail & tag #18998 North side 40" Oak..... West 43.95'

Drawing depicts a 1/2" bar w/cap set on 33' right-of-way line West of M-10.

7. 1987, JANUARY 30 - SURVEY #873-M BY DOUGLAS K. RICHARDSON, PS #31603 (LIBER 5 OF SURVEYS, PAGES 329-331)

MONUMENT AND WITNESSES: Same as Item 5 above. Drawing shows a tie of S89°47'04"E, 2652.16 feet between L-10 and M-10. (Bearing basis: "Survey recorded in Liber 4 on Pages 1155 and 1156" - Item 5 above.)

8. 1987, JUNE 17 - SURVEY #2249 BY DAVID R. LOHR, PS #30090 (LIBER 5 OF SURVEYS, PAGE 229)

MONUMENT: Found 1/2" iron  
WITNESSED BY: B Nail & tag, 12" Elm..... N30°E 63.70'  
D Nail & tag, 50" Oak..... S45°W 24.26'  
A Nail & tag, 40" Oak..... West 43.95'

Drawing shows a tie of S00°05'21"E, 2620.42 feet between M-10 and M-11. (Bearing basis: none given.)

9. 1988, AUGUST 8 - P.A. 74 LCRC BY DAVID R. LOHR, PS #30090 (LIBER 6 OF CORNERS, PAGE 386)

MONUMENT: Found 1/2" bar with cap, 4' West of centerline Meridian Road  
WITNESSED BY: D Found nail and tag SE side 50" Oak..... S40°W 26.60 feet  
A Found nail and tag North side 30" Oak..... West 45.96 feet  
B Found nail and tag West side 12" Elm..... N30°E 63.70 feet  
C Found nail and tag West side 10" Poplar..... S25°E 58.90 feet

Certificate states "Original monument and accessories obliterated".

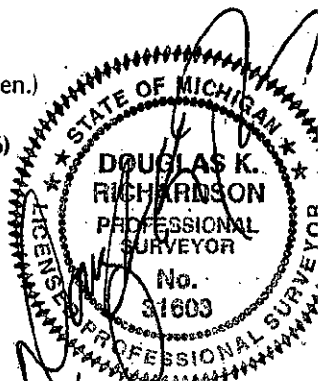

10. 1988, DECEMBER 2 - P.A. 288 SUB. "CHIMNEY OAKS" BY DAVID R. LOHR, PS #30090 (LIBER 44 OF PLATS, PAGES 1-4)

MONUMENT AND WITNESSES: Noted as "L. 6, Pg 386" with no other witnesses mentioned. Drawing shows ties of S00°00'00"W, 2620.42 between M-10 and M-11; and S00°00'00"W, 1437.33 between M-10 and A-11, Williamstown Township, T4N,R1E. (Bearing basis: "West line of the recorded plat of Grand Estates" being also the line between M-9 and M-11 shown as bearing South.)

11. 1989, MARCH 15 - SURVEY #653 BY MARVIN F. FOUTY, PS #19898 (PRIVATE RECORDS)

MONUMENT AND WITNESSES: None given. Drawing shows a tie of N87°41'02"W, 2651.00 between M-10 and L-10. (Bearing basis: "bearings hereon are rotated counterclockwise 2°05'00" from the recorded bearing of the centerline of M-43 on Sheet No. 111 of the MDOT Ingham County Right Of Way Maps." - shown at S74°22'00"E)

12. 1995 - P.A. 288 SUBDIVISION "CEDAR GLEN" BY LARRY A. BRYAN, PS #25832 (LIBER 50 OF PLATS, PAGES 8-11)

MONUMENT AND WITNESSES: Noted as "Liber 6, Page 386" with no other witnesses mentioned. Drawing shows ties of N89°29'11"E, 2651.01 between L-10 and M-10; and S00°00'00"W, 2620.44 between M-10 and M-11. (Bearing basis: "East line of Section 25 which is recorded to bear S00°00'00"W on the plat of Chimney Oaks" - Item 9 above.)

NOTES: A Indicates matching witnesses

(END OF REPORT)