

Nov 29 9 30 AM '94

REGISTER OF DEEDS
INGHAM COUNTY, MICH.

LAND CORNER RECORDATION CERTIFICATE
Filing Requirement of Act 74, Mich. P.A. 1970

SURVEY & REMONUMENTATION
For corners in Lansing Twp.
Ingham Co.
APR 10 1995
COMMISSION

Located In: _____ Corner Code: K-1

1. Public Land Survey T 4N R 2W _____
T _____ R _____
T _____ R _____
T _____ R _____

2. Property Controlling S _____ T _____ R _____
in Section S _____ T _____ R _____

3. Miscellaneous S _____ T _____ R _____
Property in Sec. S _____ T _____ R _____

4. Lot No. _____ Recorded Plat _____

5. Private Claims _____

Register of Deeds Stamp & File Number

	A	B	C	D	E	F	G	H	I	J	K	L	M
2	6	5	4	3	2	1							
3													
4	7	8	9	10	11	12							
5													
6	18	17	16	15	14	13							
7													
8	19	20	21	22	23	24							
9													
10	30	29	28	27	26	25							
11													
12	31	32	33	34	35	36							
13													

I, Larry A. Bryan, in a field survey on February 23, 19 94, do hereby certify that under requirements of P.A. 74, Michigan P.A. of 1970, the corner points mentioned in lines 1 and 2 above were in conformance with regulations and rules therefore as required in the current manual of survey instructions of the United States Department of the Interior, Bureau of Land Management or by a decree of a Court of Law and/or that the corner points mentioned in lines 3, 4 and 5 above were in conformance with the rules of the Michigan Board of Land Surveyors or by a Decree of a Court of Law; established, re-established, monumented, re-monumented, recovered, found as expressed below:

NOTE: Not more than 4 corners, all in the same town and range, may be recorded on this certificate.

A. Description of original monument and accessories and/or subsequent restoration:
K-1,

- On Monday Feb. 12th, 1827, Musgrove Evans, U.S. Deputy Surveyor, going North between Sections 1 & 2 "Int. North Boundary 18 lks. West of Post" Set a Post cor. to Secs. 1 & 2 fw a
B. Ash 5 in S.76W. 265 lks
S. Oak 6 " S.82E. 450 "

(Continued on Back)

B. Description of corner evidence found and/or method applied in restoring or reestablishing corner:

K-1, Investigation at this corner revealed a 1/2" bar in a concrete monument 11.95 feet West of 3/4" pinched pipe on extension of fence remains to the South. A nail and tag #16053 was found in the North side 6" Elm stump S70°W, 16.05' and in the West side of a 16" Elm stump N05°W, 27.72 as listed in item #6. Accepted 1/2" bar in concrete monument as the perpetuated location of K-1.

C. Description of monument for corner and accessories established to perpetuate locating the position of the corner:

- K-1, T4N-R2W
Found 1/2" bar in concrete monument as noted above.
Found 3/4" pinched pipe, Southwest corner Section 36, T5N, R2W, East 11.95'
Found nail & tag #16053 in North side 6" Elm stump, S70°W, 16.05'
Found nail & tag #16053 in West side 16" Elm stump, N05°W, 27.72'
Set nail & tag #25832 in West side 12" Box Elder, S30°E, 32.93'
Set nail & tag #25832 in North side 10" Poplar, S80°W, 45.33'
Set nail & tag #25832 in East side 8" Ash, N60°W, 66.61'

Signed by Larry A. Bryan
Surveyor's Michigan License No. 25832

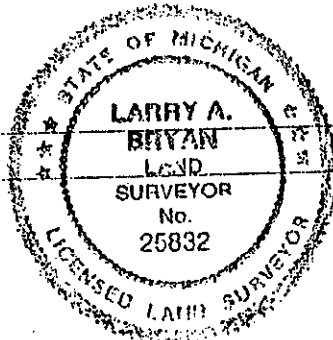

Date 11-23-94

FORM APPROVED BY MICHIGAN STATE BOARD OF LAND SURVEYORS, JAN. 28, 197
REVISED MAY 14, 197
REVISED JAN., 198

P.A. 345 INGHAM COUNTY
PEER APPROVED 5/11/94 du

PART "A" CONTINUED

2. On Sept. 7, 1847, A. Jackson, County Surveyor, recorded corner with no monument noted witnessed by:

Tam 16 N59-1/2E 22.53

no other Tree

(Vol.2 P.17 of County Surveyor Records)

3. On Nov. 19th, 1874, T.J. Brown, County Surveyor, recorded corner as a "Post" and noted that the bearing trees were gone, no witnesses given.

(Vol.3 P.91 of County Surveyor Records)

4. Corner referred to in a resurvey of Lansing Township by R.J. Robb County Surveyor, in August and September of 1909 (vol. 3, page 218 and 219 County Surveyor Records) and identified as a "cement post 3" square on top, 4" square on bottom and 2.5 feet long, by an hor post of fence going South, Delta (Dewitt) post 18 lks East, set half way from adj. corners and on true line".

5. Marvin F. Fouty, P.S. #18989, recorded corner on 02/27/75 in Liber 2 of Surveys, Pages 308-309, as having found a 3/4" pipe witnessed by:

Survey tag and nail South side 6" tree West 36.90'

Survey tag and nail South side 6" tree East 24.39'

Survey tag and nail East side 8" tree South 32.98'

6. James E. Stephens, P.S. #16053, recorded corner on 11/15/77 in Liber 4 of Corners, Page 108, and on 06/30/87 in Liber 5 of Surveys, Pages 232-233, as not finding the original monument or accessories and therefore setting a "concrete monument and cap 11.88' West of iron pipe which identifies the SW corner of Section 36, T5N, R2W. Set said monument on a projection of a line between the North 1/4 corner of Section 1 and the Southwest corner of Section 36, T5N, R2W." The concrete monument and cap were witnessed by:

Survey tag #16053 set in the East side of an 8" Elm tree, N6°36'W, 27.70'

Survey tag #16053 set in the South side of an 8" Elm tree, S89°34'E, 36.15'

Survey tag #16053 set in the North side of an 8" Elm tree, N84°12'W, 25.05'

Iron stake S89°50'12"E, 11.88' - (from Liber 5 Pages 232-233 only)

7. James E. Stephens, P.S. #16053, recorded corner on 09/13/88 in Liber 6 of Corners, Page 391, as rod in concrete monument witnessed by tags nailed to:

West side of 14" Elm tree North 27.71 feet

North side of 6" Elm tree S85°W 16.07 feet

NE side of 14" Elm tree S45°W 39.39 feet

Iron pipe East 11.88 feet

8. Corner referred to in Recorded Subdivision Plats: The Crossings at Abbott Parkside, James E. Stephens P.S. #16053, January 18, 1991, Liber 46 of Plats, Page 24, 25 and 26; The Crossings at Abbott Parkside No.2, James E. Stephens P.S. #16053, March 12, 1993, Liber 48 of Plats, Page 3 and 4; The Crossings at Abbott Parkside No.3, James E. Stephens P.S. #16053, July 9, 1993, Liber 48 of Plats, Page 22 and 23.