

NOV 15 1994

COMMISSION

LAND CORNER RECORDATION CERTIFICATE

Filing Requirement of Act 74, Mich. P.A. 1970

MAY 10 8 51 AM '94

REGISTER OF DEEDS  
Pamela J. Johnson  
INGHAM COUNTY, MICH.

For corners in

Ingham

(County)

Located In:

Corner Code #

- 1. Public Land Survey      T 4N R 2W      K-2  
                                   T \_\_\_\_\_ R \_\_\_\_\_  
                                   T \_\_\_\_\_ R \_\_\_\_\_  
                                   T \_\_\_\_\_ R \_\_\_\_\_
- 2. Property Controlling    S \_\_\_\_\_ T \_\_\_\_\_ R \_\_\_\_\_  
    in Section               S \_\_\_\_\_ T \_\_\_\_\_ R \_\_\_\_\_
- 3. Miscellaneous            S \_\_\_\_\_ T \_\_\_\_\_ R \_\_\_\_\_  
    Property in Sec.         S \_\_\_\_\_ T \_\_\_\_\_ R \_\_\_\_\_

Register of Deeds Stamp & File Number

- 4. Lot No. \_\_\_\_\_, Recorded Plat \_\_\_\_\_
- 5. Private Claims \_\_\_\_\_

I, Larry A. Bryan, in a field survey on February 23, 19 94, do hereby certify that under requirements of P.A. 74, Michigan P.A. of 1970, the corner points mentioned in lines 1 and 2 above were in conformance with regulations and rules therefore as required in the current manual of survey instructions of the United States Department of the Interior, Bureau of Land Management or by a decree of a Court of Law and/or that the corner points mentioned in lines 3, 4 and 5 above were in conformance with the rules of the Michigan Board of Land Surveyors or by a Decree of a Court of Law; established, re-established, monumented, re-monumented, recovered, found as expressed below:

NOTE: Not more than 4 corners, all in the same town and range, may be recorded on this certificate.

A	B	C	D	E	F	G	H	I	J	K	L	M
2	6	5	4	3	2	1						
3												
4	7	8	9	10	11	12						
5												
6	16	17	16	15	14	13						
7												
8	19	20	21	22	23	24						
9												
10	30	29	28	27	26	25						
11												
12	31	32	33	34	35	36						
13												

A. Description of original monument and accessories and/or subsequent restoration:  
K-2,

- 1. On Monday Feb. 12th, 1827, Musgrove Evans, U.S. Deputy Surveyor,  
    Set 1/4 Post fw  
    Sug. 11 N.64-1/2E. 24  
    Sug. 15 N.57W. 30

(Continued on Back)

B. Description of corner evidence found and/or method applied in restoring or reestablishing corner:

K-2, Investigation at this corner revealed a 5/8" bar in a monument box 36.2' West of centerline of Coolidge Road. All of the witnesses listed in item #10 were found with the distances noted in part "C" below. No monumentation from Haver Acres Sub. No.1 was found due to construction. Accepted 5/8" bar in monument box as perpetuated location of K-2.

C. Description of monument for corner and accessories established to perpetuate locating the position of the corner:

- K-2, T4N-R2W  
    Found 5/8" bar in monument box as noted above.  
    Found nail & tag #16053 in West side of a power pole, N05°E, 96.16'.  
    Found nail & tag #16053 in West side of a 10" Cherry, East, 108.64'.  
    Found nail & tag #16053 in West side of a power pole, S05°E, 163.84'.  
    Found P.K. nail in 2' diameter concrete light pole base, S70°E, 96.37'.  
    Centerline of a fire hydrant, N20°E, 232.30'.  
    Centerline of the Northeast bolt in a 2' diameter concrete light pole base, S45°W, 39.80'.

Signed by Larry A. Bryan  
 Surveyor's Michigan License No. 25832

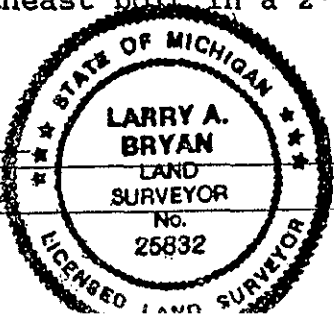

Date 4-15-94

## PART "A" CONTINUED

2. On Sept. 7, 1847, A. Jackson, County Surveyor, recorded corner with no monument noted witnessed by:  
 Tam 7 South 12.50 lks.  
 no other Tree (Vol.2 P.17 of County Surveyor Records)
3. On Nov. 19th, 1874, T.J. Brown, County Surveyor, recorded corner as a "Post" from which a Sugar 15 inches in diameter bears N.64-1/2E. 24 links distant. (Vol.3 P.91 of County Surveyor Records)
4. On Dec. 22nd, 1881, A.P. Drake, County Surveyor, recorded corner as a Black Walnut Stake with no bearing trees given. (Vol.3 P.185 of County Surveyor Records)
5. Corner referred to in a resurvey of Lansing Township by R.J. Robb County Surveyor in August and September, 1909 (vol. 3, page 218 and 219 County Surveyor Records) as a "cement post 3" square on top, 4" square on bottom and 2.5' long by two posts with one witness to a Ash N60°E 28'
6. Records of L.J. Hendryx, P.S. #3276, supplied by R. Helsel, P.S. #18994, record corner as a square concrete monument with no witnesses given and date unknown.
7. James E. Stephens, P.S. #16053, recorded corner on 11/29/73 in Liber 2 of Corners, Page 559, and on 10/28/80 in Liber 4 of Surveys, Page 149, and on 09/28/82 in Liber 4 of Surveys, Pages 578-584, as having found an old concrete monument in the intersection of a 3-way fence witnessed by:  
 Survey tag in the SW side of a 10" Hickory tree, N14°21'E 19.05 feet  
 Survey tag in the W. side of a 14" Wild Cherry tree, N85°11'E 8.54 feet  
 Survey tag in the N. side of a 24" Oak tree, S9°40'E 11.91 feet  
 The bearing of the Section line North of the corner is N0°37'20"W.
8. David L. Clifford, P.S. #25837, recorded corner on 04/06/82 in Liber 4 of Surveys, Page 524, calling only for L2, Pg.559.
9. Maurice H. Mahieu, P.S. #28414, recorded corner on 04/15/83 in Liber 4 of Surveys, Page 702, and on 07/07/83 in Liber 4 of Surveys, page 734, and on 11/19/84 in Liber 4 of Surveys, Page 946, with the same witnesses as listed in item #7.
10. James E. Stephens, P.S. #16053, recorded corner on 06/25/87 in Liber 6 of Corners, Page 337, and on 06/30/87 in Liber 5 of Surveys, Pages 232 - 233, and on 10/17/89 in Liber 5 of Surveys, Pages 1152-1159, stating the monument and its witnesses listed in item #7 were removed during road construction. A 5/8 inch iron rod in a monument box was found that was accepted as the re-established corner witnessed by: Nail and tag in the East side of a utility pole N5°E 96.33 feet, Nail and tag in the North side of a 10" Cherry tree East 108.70 feet, Chiseled "x" in top of concrete curb S45°E 12.52 feet, P.K. nail in concrete base of light pole S70°E 96.40 feet.
11. Douglas K. Richardson, P.S. #31603, recorded corner on 10/06/87 in Liber 5 of Surveys, Page 306, calling only for L2, Pg.559.
12. Maurice H. Mahieu, P.S. #28414, recorded corner on 10/27/87 in Liber 5 of Surveys, Pages 344-345, with the same witnesses as listed in item #10.
13. Corner referred to in Recorded Subdivision Plats: Haver Acres Sub. No.1, Laverne J. Handryx P.S. #3276, October 12, 1953, Liber 17 of Plats, Page 14; The Crossings at Abbott Parkside, James E. Stephens P.S. #16053, January 18, 1991, Liber 46 of Plats, Page 24, 25 and 26.